

# Appendix 5.1.1 - Proposed Settlement Lands

## ALGONQUIN LAND CLAIM DESCRIPTIVE PLAN

### PARCEL 57

Sheet 1 of 3

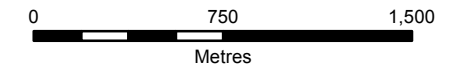

1:30,000

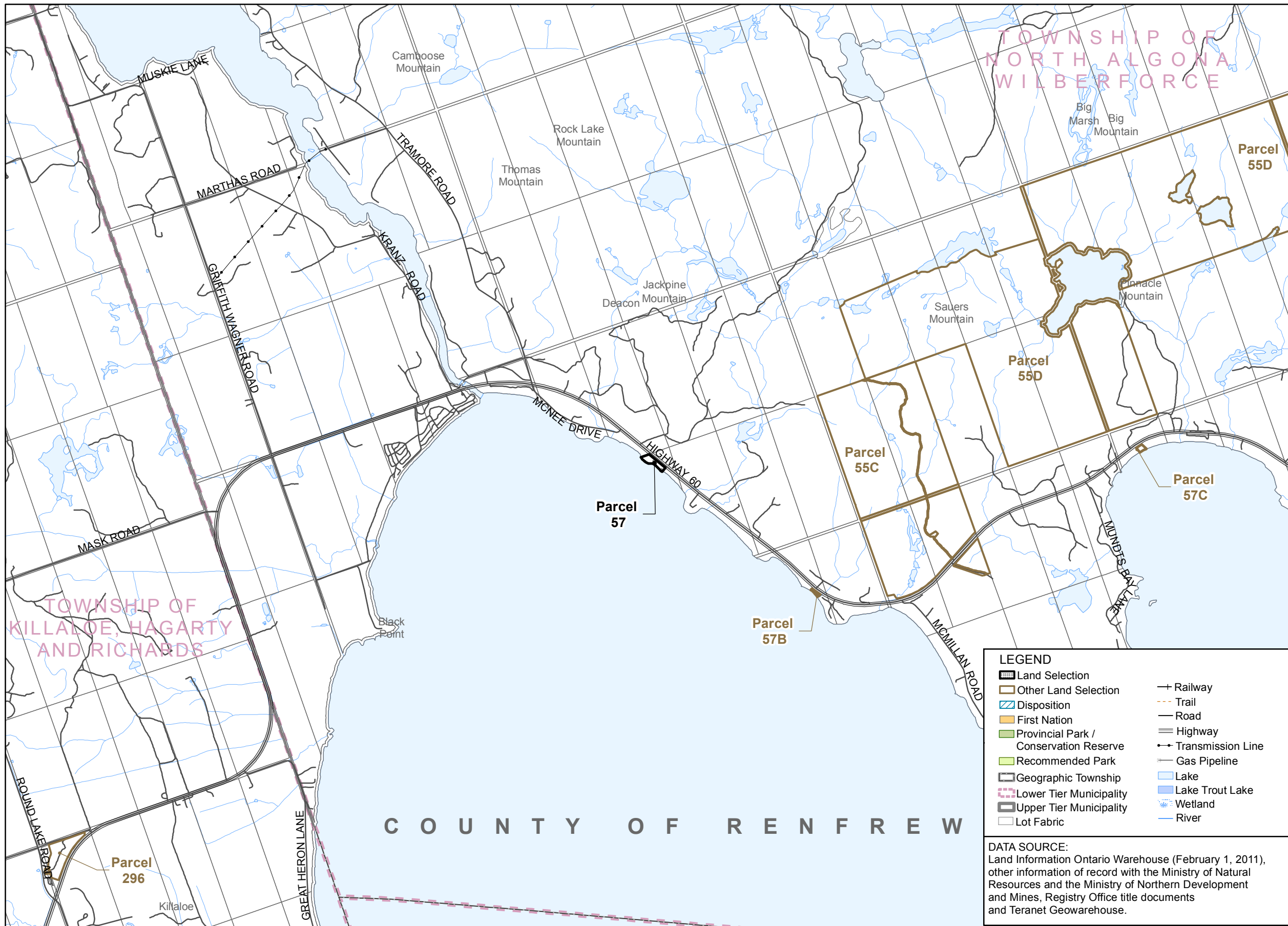

**LEGEND**

Land Selection	Railway
Other Land Selection	Trail
Disposition	Road
First Nation	Highway
Provincial Park / Conservation Reserve	Transmission Line
Recommended Park	Gas Pipeline
Geographic Township	Lake
Lower Tier Municipality	Lake Trout Lake
Upper Tier Municipality	Wetland
Lot Fabric	River

**DATA SOURCE:**  
Land Information Ontario Warehouse (February 1, 2011), other information of record with the Ministry of Natural Resources and the Ministry of Northern Development and Mines, Registry Office title documents and Teranet Geowarehouse.

1. **CAUTION: THIS IS NOT A PLAN OF SURVEY**
2. This Descriptive Plan is a graphic illustration of the Settlement Lands identified in the Settlement Agreement of the Algonquin Land Claim. This plan is intended to illustrate the complex inter-relationships between the Settlement Lands and other previous dispositions and alienations of public lands and is necessary to prevent duplicate or overlapping tenure commitments on the same lands.
3. This Descriptive Plan has been prepared from the best available information but without benefit of survey. The absolute and relative positional accuracy of the data shown hereon has not been verified. Discrepancies between different data sources are known to exist. Do not use this Plan as evidence of the location of legal boundaries, township lot fabric, features, or routes. Do not rely on this Plan to determine the extent of parcel areas, the existence of navigable bodies of water nor as a guide for navigation.
4. Any sale, lease or other disposition of lands illustrated hereon made pursuant to the Settlement Agreement of the Algonquin Land Claim is limited to the extent of the un-alienated rights held by the Ministry of Natural Resources and every grant shall be subject to the provisions of the statute of the Bed of Navigable Waters Act, R.S.O. 1990, Chapter B.4.
5. The boundary information must be read in conjunction with all Notes appearing in and on the Plan series and within the terms of the Settlement Agreement. Should the provisions contained on the Descriptive Plan be found to conflict with the terms contained within the Settlement Agreement the terms contained within the Settlement Agreement shall prevail. Nothing hereon contained, except the provision for the application of "The Bed of Navigable Waters Act" aforesaid, shall affect the interpretation which would, apart from this Descriptive Plan, be put upon the words of any letters patent hereafter issued under the Great Seal of the Province of Ontario, or of any lease or other conveyance, or of any contract heretofore or hereafter made under the direction of the Province of Ontario.
6. Survey Instructions from the Surveyor General of Ontario must be obtained prior to establishing any of the boundaries on the ground.

PRODUCED BY:  
The Office of the Surveyor General      September 7, 2013

# Appendix 5.1.1 - Proposed Settlement Lands

## ALGONQUIN LAND CLAIM DESCRIPTIVE PLAN PARCEL 57

Sheet 2 of 3

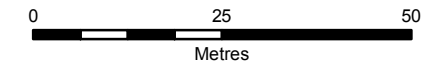

1:1,000

### LEGEND

	Land Selection		Railway
	Other Land Selection		Trail
	Disposition		Resource Road
	First Nation		Local / Private Road
	Crown Land		Municipal Road
	Acquired Crown Land		Highway
	Municipal Ownership		Transmission Line
	Private Ownership		Gas Pipeline
	Provincial Park / Conservation Reserve		Lake
	Recommended Park		Lake Trout Lake
	Mining Claim		Wetland
	Geographic Township		River
	Lot Fabric		Contour of Elevation
			Flooding Contour

### NOTES:

- CAUTION: THIS IS NOT A PLAN OF SURVEY**  
This map describes the intent of the parcel boundary. The information has been compiled from various sources and the accuracy is not guaranteed. The true location and area on the ground must be determined by survey. Do not rely on this map as a precise indicator of routes, locations of features, nor as a guide for navigation.
- Survey Instructions from the Surveyor General of Ontario must be obtained prior to establishing any of the boundaries on the ground.
- Projection: NAD83 (CSRS) UTM Zone 18
- EXT - Denotes Extended
- LIM - Denotes Limit
- LL - Denotes Lot Line
- LLUP - Denotes Limit of Land Use Permit
- LPO - Denotes Limit of Private Ownership
- LPOE - Denotes Limit of Private Ownership and Extended
- LW - Denotes Limit of Wetland
- NS - Denotes Not in Site
- RA - Denotes Road Allowance
- RWE - Denotes Regulated Water's Edge being the water's edge as affected by the operation of water level control structures, when operated, and otherwise at the water's edge as it occurs naturally.
- WE - Denotes Water's Edge

### DATA SOURCE:

Land Information Ontario Warehouse (February 1, 2011), other information of record with the Ministry of Natural Resources and the Ministry of Northern Development and Mines, Registry Office title documents and Teranet Geowarehouse.

### PRODUCED BY:

The Office of the Surveyor General

September 7, 2013

Ministry of  
Natural Resources



© Queen's Printer for Ontario, 2013

RC57\_OSG\_20130907.mxd

### NOTE:

- Regulated Water Level: The water level of Golden Lake is regulated. See Licence of Occupation No. 8282 for specifics.
- Datum: All elevations are referenced to Geodetic Survey of Canada.
- The water elevation of Golden Lake shown hereon is 169.0m (OBM).

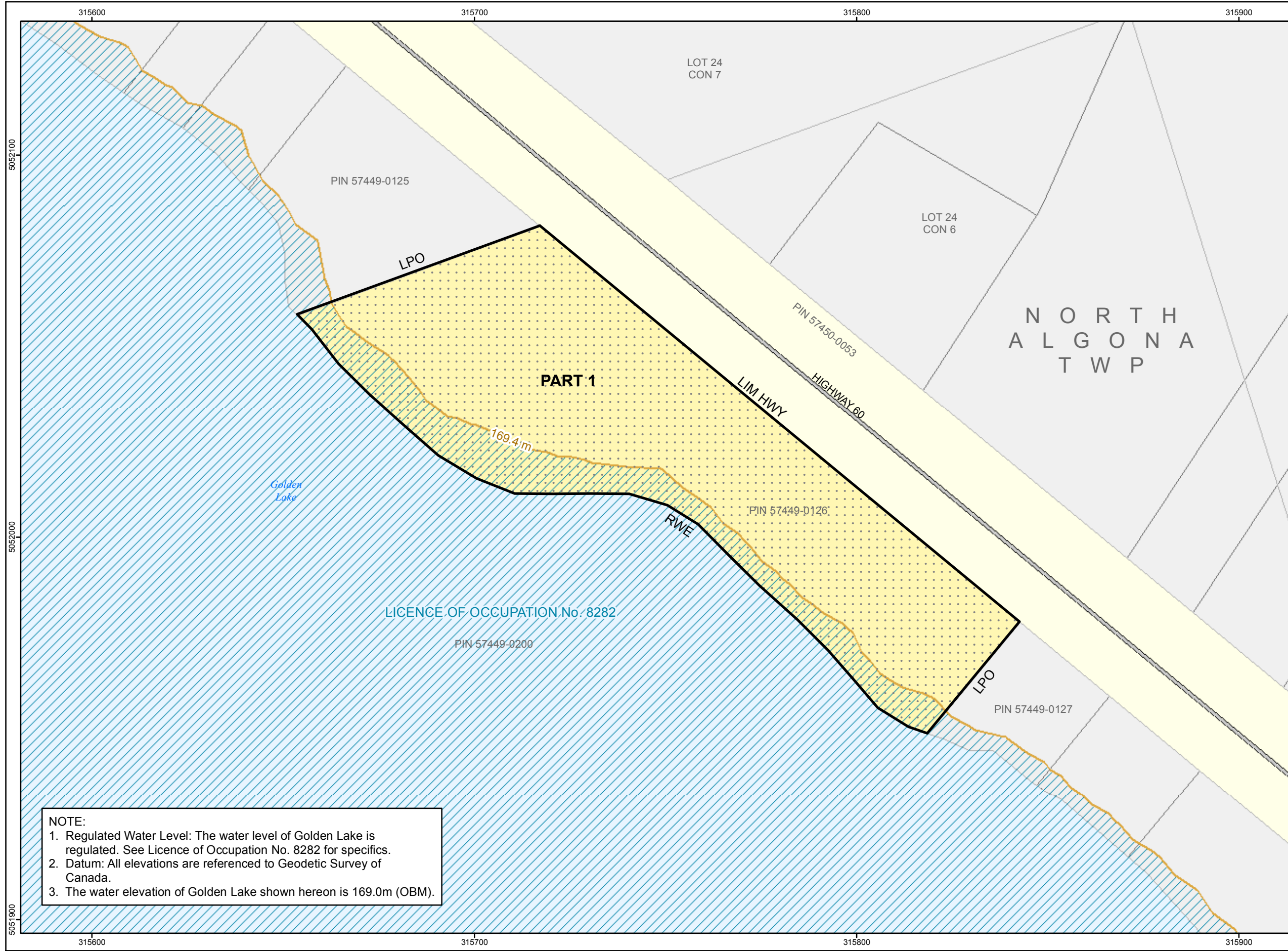

### Appendix 5.1.1 - Proposed Settlement Lands

PART SCHEDULE						
Part #	Description	Area (ha)	Area Included (ha)	Area Not Included (ha)	Action	Comments
PART 1	Acquired Crown Land (Ministry of Transportation)	0.8	0.8		Transfer subject to reservation of right to flood	License of Occupation for flooding
Total Area (ha)		0.8	0.8	0.0		
Total Area (ac)		2.0	2.0	0.0		

## ALGONQUIN LAND CLAIM DESCRIPTIVE PLAN

PARCEL 57

SHEET 3 of 3

NOTE: Total Area as shown is the sum of areas of all parts, including those < 0.1 ha.

PRODUCED BY:  
The Office of the Surveyor General      September 7, 2013

Ministry of  
Natural Resources

© Queen's Printer for Ontario, 2013

## Appendix 5.1.1 - Proposed Settlement Lands

### Stakeholder Activities in Parcel 57

Activity	Description	Status	Size of Area (ac)	Percent of Area Affected (%)
Bait Harvest Area	PE0502	Inactive	2.1	< 0.1
Bear Management Area	None			
Certificate of Approval	None			
Conservation Authority	None			
Extractable Aggregate	None			
Forest Management Unit	780 - Ottawa Valley Forest			
Land Use Permit	None			
Lease	None			
Licence of Occupation	Hydro-Electric Commission of the Town of Renfrew - LO #8282			
Mining Claim	None			
Mining Lease	None			
Research Plot	None			
Resident Trapper	None			
Seed Area	None			
Trail	None			
Trapline Area	None			
Wind Power Application	None			

The information included in this table is based on the best information as of August 1, 2013. Information may be subject to change.