

Appendix 5.1.1 - Proposed Settlement Lands

ALGONQUIN LAND CLAIM DESCRIPTIVE PLAN

PARCEL 55D

Sheet 1 of 6

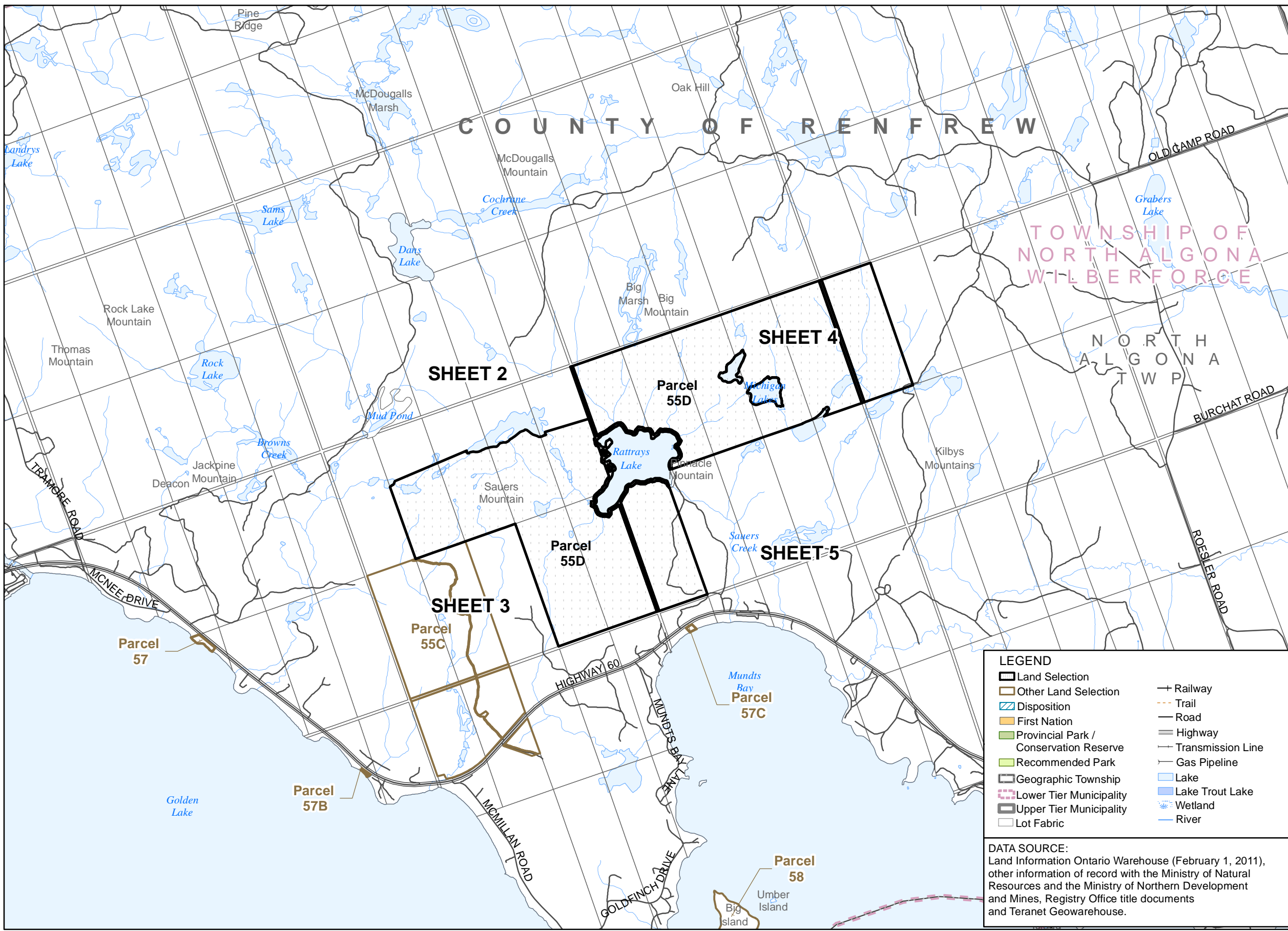
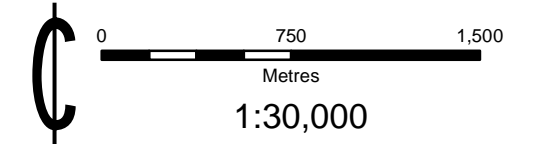

LEGEND	
	Land Selection
	Other Land Selection
	Disposition
	First Nation
	Provincial Park / Conservation Reserve
	Recommended Park
	Geographic Township
	Lower Tier Municipality
	Upper Tier Municipality
	Lot Fabric
	Railway
	Trail
	Road
	Highway
	Transmission Line
	Gas Pipeline
	Lake
	Lake Trout Lake
	Wetland
	River

DATA SOURCE:
Land Information Ontario Warehouse (February 1, 2011), other information of record with the Ministry of Natural Resources and the Ministry of Northern Development and Mines, Registry Office title documents and Teranet Geowarehouse.

- CAUTION: THIS IS NOT A PLAN OF SURVEY**
- This Descriptive Plan is a graphic illustration of the Settlement Lands identified in the Settlement Agreement of the Algonquin Land Claim. This plan is intended to illustrate the complex inter-relationships between the Settlement Lands and other previous dispositions and alienations of public lands and is necessary to prevent duplicate or overlapping tenure commitments on the same lands.
- This Descriptive Plan has been prepared from the best available information but without benefit of survey. The absolute and relative positional accuracy of the data shown hereon has not been verified. Discrepancies between different data sources are known to exist. Do not use this Plan as evidence of the location of legal boundaries, township lot fabric, features, or routes. Do not rely on this Plan to determine the extent of parcel areas, the existence of navigable bodies of water nor as a guide for navigation.
- Any sale, lease or other disposition of lands illustrated hereon made pursuant to the Settlement Agreement of the Algonquin Land Claim is limited to the extent of the un-alienated rights held by the Ministry of Natural Resources and every grant shall be subject to the provisions of the statute of the Bed of Navigable Waters Act, R.S.O. 1990, Chapter B.4.
- The boundary information must be read in conjunction with all Notes appearing in and on the Plan series and within the terms of the Settlement Agreement. Should the provisions contained on the Descriptive Plan be found to conflict with the terms contained within the Settlement Agreement the terms contained within the Settlement Agreement shall prevail. Nothing hereon contained, except the provision for the application of "The Bed of Navigable Waters Act" aforesaid, shall affect the interpretation which would, apart from this Descriptive Plan, be put upon the words of any letters patent hereafter issued under the Great Seal of the Province of Ontario, or of any lease or other conveyance, or of any contract heretofore or hereafter made under the direction of the Province of Ontario.
- Survey Instructions from the Surveyor General of Ontario must be obtained prior to establishing any of the boundaries on the ground.

PRODUCED BY:
The Office of the Surveyor General December 18, 2014

Appendix 5.1.1 - Proposed Settlement Lands

ALGONQUIN LAND CLAIM DESCRIPTIVE PLAN

PARCEL 55D

Sheet 2 of 6

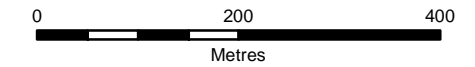

1:7,500

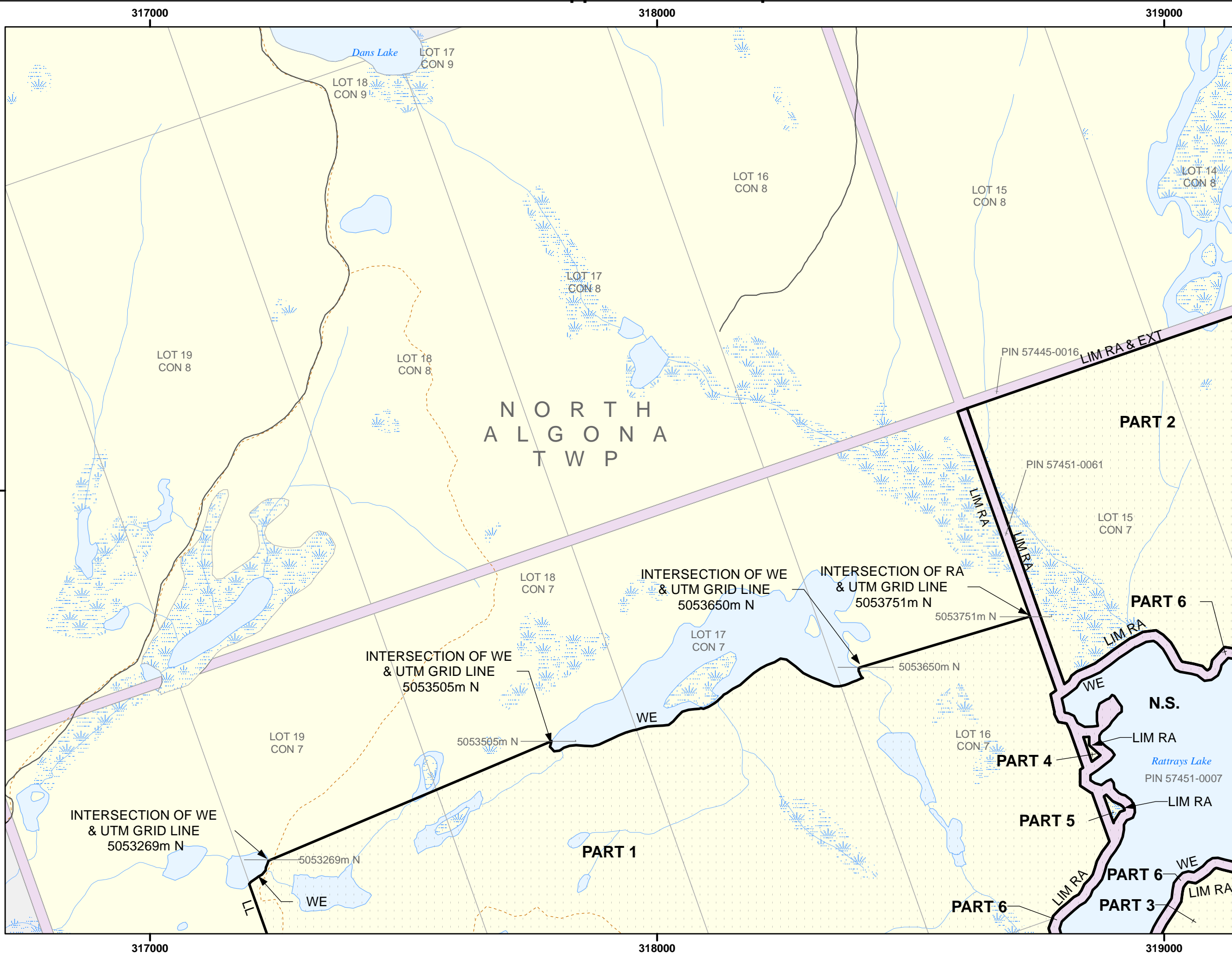

LEGEND

Land Selection	Railway
Other Land Selection	Trail
Disposition	Resource Road
First Nation	Local / Private Road
Crown Land	Municipal Road
Acquired Crown Land	Highway
Municipal Ownership	Transmission Line
Private Ownership	Gas Pipeline
Provincial Park / Conservation Reserve	Lake
Recommended Park	Lake Trout Lake
Mining Claim	Wetland
Geographic Township	River
Lot Fabric	Contour of Elevation
	Flooding Contour

- NOTES:**
- CAUTION: THIS IS NOT A PLAN OF SURVEY**
This map describes the intent of the parcel boundary. The information has been compiled from various sources and the accuracy is not guaranteed. The true location and area on the ground must be determined by survey. Do not rely on this map as a precise indicator of routes, locations of features, nor as a guide for navigation.
 - Survey Instructions from the Surveyor General of Ontario must be obtained prior to establishing any of the boundaries on the ground.
 - Projection: NAD83 (CSRS) UTM Zone 18
 - EXT - Denotes Extended
 - LIM - Denotes Limit
 - LL - Denotes Lot Line
 - LLUP - Denotes Limit of Land Use Permit
 - LPO - Denotes Limit of Private Ownership
 - LPOE - Denotes Limit of Private Ownership and Extended
 - LW - Denotes Limit of Wetland
 - NS - Denotes Not in Site
 - RA - Denotes Road Allowance
 - RWE - Denotes Regulated Water's Edge being the water's edge as affected by the operation of water level control structures, when operated, and otherwise at the water's edge as it occurs naturally.
 - WE - Denotes Water's Edge

DATA SOURCE:
Land Information Ontario Warehouse (February 1, 2011), other information of record with the Ministry of Natural Resources and the Ministry of Northern Development and Mines, Registry Office title documents and Teranet Geowarehouse.

PRODUCED BY:
The Office of the Surveyor General December 18, 2014

Ministry of
Natural Resources & Forestry
© Queen's Printer for Ontario, 2014

Appendix 5.1.1 - Proposed Settlement Lands

ALGONQUIN LAND CLAIM DESCRIPTIVE PLAN

PARCEL 55D

Sheet 3 of 6

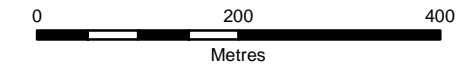

1:7,500

LEGEND	
Land Selection	Railway
Other Land Selection	Trail
Disposition	Resource Road
First Nation	Local / Private Road
Crown Land	Highway
Acquired Crown Land	Transmission Line
Municipal Ownership	Gas Pipeline
Private Ownership	Lake
Provincial Park / Conservation Reserve	Lake Trout Lake
Recommended Park	Wetland
Mining Claim	River
Geographic Township	Contour of Elevation
Lot Fabric	Flooding Contour

- NOTES:
- CAUTION: THIS IS NOT A PLAN OF SURVEY**
This map describes the intent of the parcel boundary. The information has been compiled from various sources and the accuracy is not guaranteed. The true location and area on the ground must be determined by survey. Do not rely on this map as a precise indicator of routes, locations of features, nor as a guide for navigation.
 - Survey Instructions from the Surveyor General of Ontario must be obtained prior to establishing any of the boundaries on the ground.
 - Projection: NAD83 (CSRS) UTM Zone 18
 - EXT - Denotes Extended
 - LIM - Denotes Limit
 - LL - Denotes Lot Line
 - LLUP - Denotes Limit of Land Use Permit
 - LPO - Denotes Limit of Private Ownership
 - LPOE - Denotes Limit of Private Ownership and Extended
 - LW - Denotes Limit of Wetland
 - NS - Denotes Not in Site
 - RA - Denotes Road Allowance
 - RWE - Denotes Regulated Water's Edge being the water's edge as affected by the operation of water level control structures, when operated, and otherwise at the water's edge as it occurs naturally.
 - WE - Denotes Water's Edge

DATA SOURCE:
Land Information Ontario Warehouse (February 1, 2011), other information of record with the Ministry of Natural Resources and the Ministry of Northern Development and Mines, Registry Office title documents and Teranet Geowarehouse.

PRODUCED BY:
The Office of the Surveyor General December 18, 2014

Ontario Ministry of Natural Resources & Forestry
© Queen's Printer for Ontario, 2014

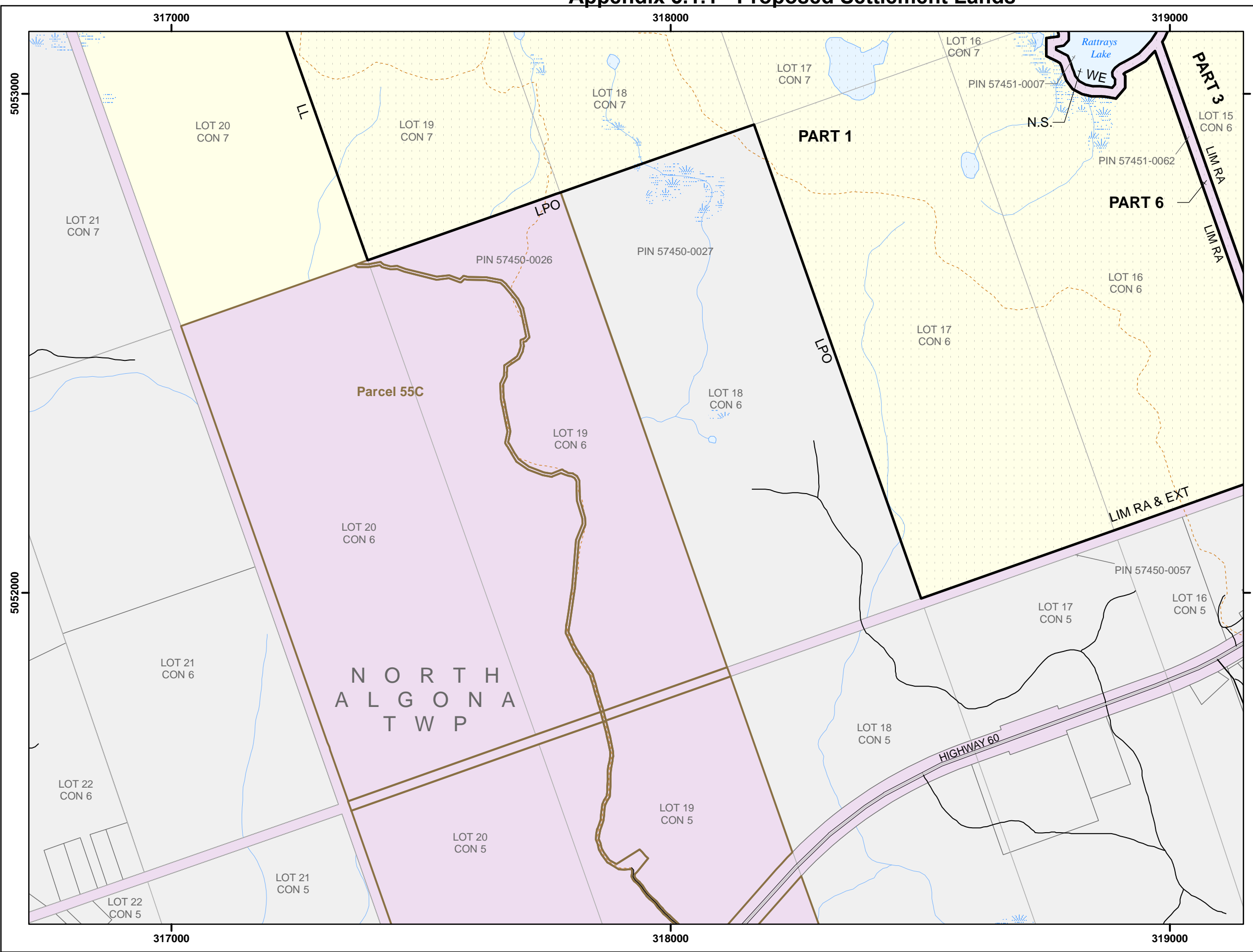

Appendix 5.1.1 - Proposed Settlement Lands

ALGONQUIN LAND CLAIM DESCRIPTIVE PLAN

PARCEL 55D

Sheet 4 of 6

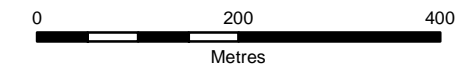

1:7,500

LEGEND	
Land Selection	Railway
Other Land Selection	Trail
Disposition	Resource Road
First Nation	Local / Private Road
Crown Land	Municipal Road
Acquired Crown Land	Highway
Municipal Ownership	Transmission Line
Private Ownership	Gas Pipeline
Provincial Park / Conservation Reserve	Lake
Recommended Park	Lake Trout Lake
Mining Claim	Wetland
Geographic Township	River
Lot Fabric	Contour of Elevation
	Flooding Contour

- NOTES:
- CAUTION: THIS IS NOT A PLAN OF SURVEY**
This map describes the intent of the parcel boundary. The information has been compiled from various sources and the accuracy is not guaranteed. The true location and area on the ground must be determined by survey. Do not rely on this map as a precise indicator of routes, locations of features, nor as a guide for navigation.
 - Survey Instructions from the Surveyor General of Ontario must be obtained prior to establishing any of the boundaries on the ground.
 - Projection: NAD83 (CSRS) UTM Zone 18
 - EXT - Denotes Extended
 - LIM - Denotes Limit
 - LL - Denotes Lot Line
 - LLUP - Denotes Limit of Land Use Permit
 - LPO - Denotes Limit of Private Ownership
 - LPOE - Denotes Limit of Private Ownership and Extended
 - LW - Denotes Limit of Wetland
 - NS - Denotes Not in Site
 - RA - Denotes Road Allowance
 - RWE - Denotes Regulated Water's Edge being the water's edge as affected by the operation of water level control structures, when operated, and otherwise at the water's edge as it occurs naturally.
 - WE - Denotes Water's Edge

DATA SOURCE:
Land Information Ontario Warehouse (February 1, 2011), other information of record with the Ministry of Natural Resources and the Ministry of Northern Development and Mines, Registry Office title documents and Teranet Geowarehouse.

PRODUCED BY:
The Office of the Surveyor General December 18, 2014

Ontario Ministry of Natural Resources & Forestry
© Queen's Printer for Ontario, 2014

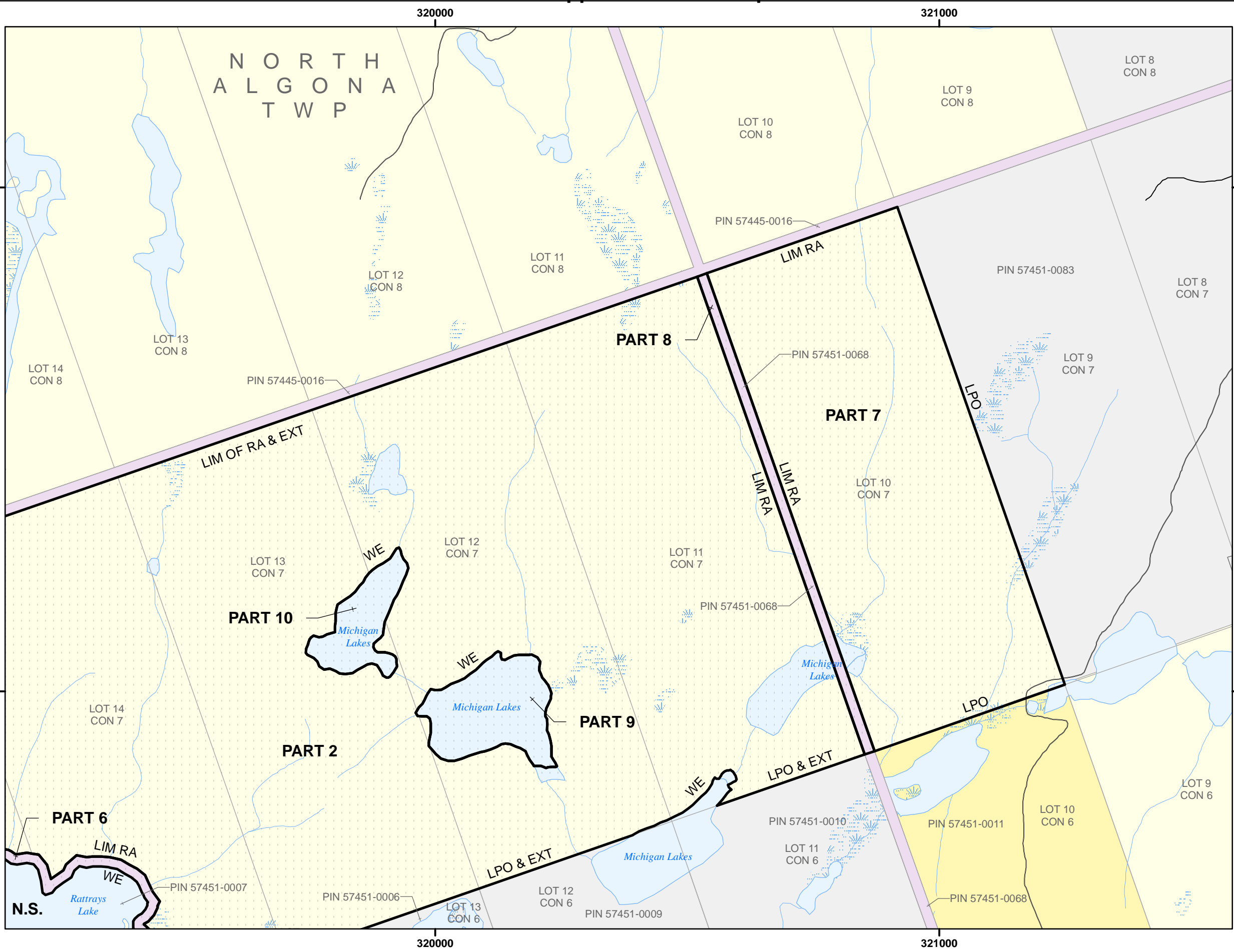

Appendix 5.1.1 - Proposed Settlement Lands

ALGONQUIN LAND CLAIM DESCRIPTIVE PLAN

PARCEL 55D

Sheet 5 of 6

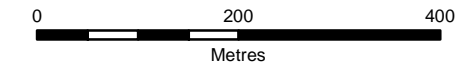

1:7,500

LEGEND	
	Land Selection
	Other Land Selection
	Disposition
	First Nation
	Crown Land
	Acquired Crown Land
	Municipal Ownership
	Private Ownership
	Provincial Park / Conservation Reserve
	Recommended Park
	Mining Claim
	Geographic Township
	Lot Fabric
	Railway
	Trail
	Resource Road
	Local / Private Road
	Municipal Road
	Highway
	Transmission Line
	Gas Pipeline
	Lake
	Lake Trout Lake
	Wetland
	River
	Contour of Elevation
	Flooding Contour

- NOTES:**
- CAUTION: THIS IS NOT A PLAN OF SURVEY**
This map describes the intent of the parcel boundary. The information has been compiled from various sources and the accuracy is not guaranteed. The true location and area on the ground must be determined by survey. Do not rely on this map as a precise indicator of routes, locations of features, nor as a guide for navigation.
 - Survey Instructions from the Surveyor General of Ontario must be obtained prior to establishing any of the boundaries on the ground.
 - Projection: NAD83 (CSRS) UTM Zone 18
 - EXT - Denotes Extended
 - LIM - Denotes Limit
 - LL - Denotes Lot Line
 - LLUP - Denotes Limit of Land Use Permit
 - LPO - Denotes Limit of Private Ownership
 - LPOE - Denotes Limit of Private Ownership and Extended
 - LW - Denotes Limit of Wetland
 - NS - Denotes Not in Site
 - RA - Denotes Road Allowance
 - RWE - Denotes Regulated Water's Edge being the water's edge as affected by the operation of water level control structures, when operated, and otherwise at the water's edge as it occurs naturally.
 - WE - Denotes Water's Edge

DATA SOURCE:
Land Information Ontario Warehouse (February 1, 2011), other information of record with the Ministry of Natural Resources and the Ministry of Northern Development and Mines, Registry Office title documents and Teranet Geowarehouse.

PRODUCED BY:
The Office of the Surveyor General December 18, 2014

Ontario Ministry of
Natural Resources & Forestry
© Queen's Printer for Ontario, 2014

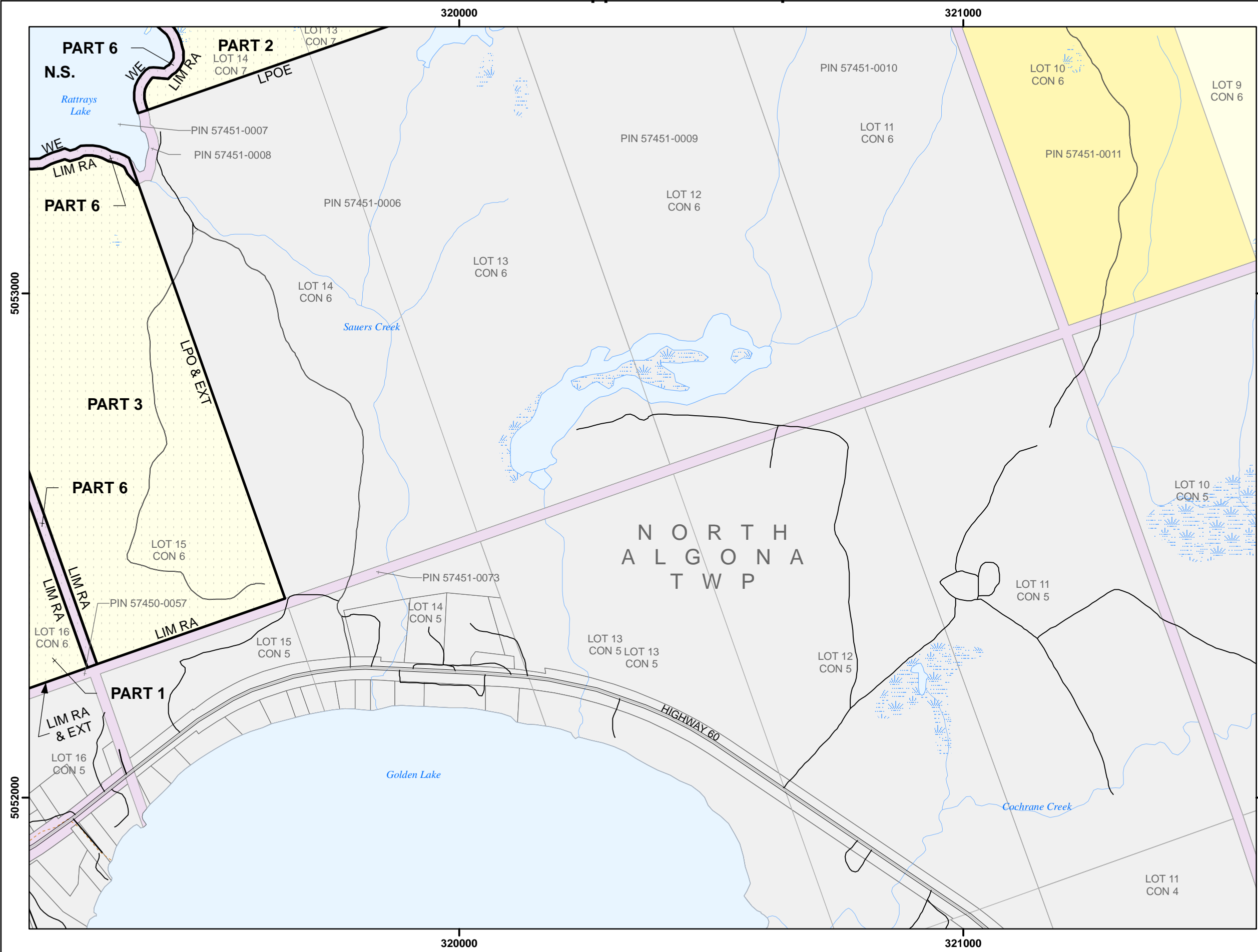

Appendix 5.1.1 - Proposed Settlement Lands

ALGONQUIN LAND CLAIM DESCRIPTIVE PLAN

PARCEL 55D

SHEET 6 of 6

PART SCHEDULE						
Part #	Description	Area (ha)	Area Included (ha)	Area Not Included (ha)	Action	Comments
PART 1	Unpatented Crown Land	178.4	178.4		Patent	
PART 2		174.3	174.3			
PART 3		37.8	37.8			
PART 4		0.1	0.1			
PART 5		0.1	0.1			
PART 6	Road Allowance	8.9		8.9	Excluded	
PART 7	Unpatented Crown Land	40.2	40.2		Patent	
PART 8	Road Allowance	2.0		2.0	Excluded	
PART 9	Lake	4.1	4.1		Patent	Patent where confirmed as non-navigable water body
PART 10		2.4	2.4			
Total Area (ha)		448.2	437.3	10.9		
Total Area (ac)		1107.5	1080.5	27.0		

NOTE: Total Area as shown is the sum of areas of all parts, including those < 0.1 ha.

PRODUCED BY:
The Office of the Surveyor General December 18, 2014



Ministry of
Natural Resources & Forestry
© Queen's Printer for Ontario, 2014

Appendix 5.1.1 - Proposed Settlement Lands

Stakeholder Activities in Parcel 55D

Activity	Description	Status	Size of Area (ac)	Percent of Area Affected (%)
Bait Harvest Area	PE0148	Inactive	1107.5	6.9
Bear Management Area	PE-55B-002	Inactive	956.3	3.4
Bear Management Area	PE-55B-003	Active	151.1	0.8
Certificate of Approval	None			
Conservation Authority Area	None			
Extractable Aggregate	None			
Forest Management Unit	780 - Ottawa Valley Forest			
Land Use Permit	None			
Lease	None			
Licence of Occupation	None			
Mining Claim	None			
Mining Lease	None			
Order-in-Council	None			
Research Plot	None			
Resident Trapper	None			
Seed Area	None			
Trail	Hiking Trail: Pakotina Trail			
Trail	OFSC Snowmobile Trails			
Trapline Area	PE019	Active	1107.2	5.8
Wind Power Application	None			

The information included in this table is based on the best information as of August 1, 2013. Information may be subject to change.