

Appendix 5.1.1 - Proposed Settlement Lands

ALGONQUIN  
LAND CLAIM  
DESCRIPTIVE PLAN  
PARCEL 343

Sheet 1 of 3

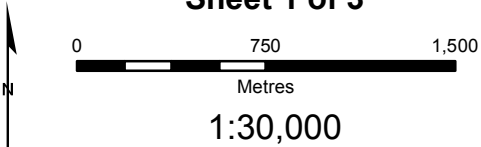

- CAUTION: THIS IS NOT A PLAN OF SURVEY**
- This Descriptive Plan is a graphic illustration of the Settlement Lands identified in the Settlement Agreement of the Algonquin Land Claim. This plan is intended to illustrate the complex inter-relationships between the Settlement Lands and other previous dispositions and alienations of public lands and is necessary to prevent duplicate or overlapping tenure commitments on the same lands.
- This Descriptive Plan has been prepared from the best available information but without benefit of survey. The absolute and relative positional accuracy of the data shown hereon has not been verified. Discrepancies between different data sources are known to exist. Do not use this Plan as evidence of the location of legal boundaries, township lot fabric, features, or routes. Do not rely on this Plan to determine the extent of parcel areas, the existence of navigable bodies of water nor as a guide for navigation.
- Any sale, lease or other disposition of lands illustrated hereon made pursuant to the Settlement Agreement of the Algonquin Land Claim is limited to the extent of the un-alienated rights held by the Ministry of Natural Resources and every grant shall be subject to the provisions of the statute of the Bed of Navigable Waters Act, R.S.O. 1990, Chapter B.4.
- The boundary information must be read in conjunction with all Notes appearing in and on the Plan series and within the terms of the Settlement Agreement. Should the provisions contained on the Descriptive Plan be found to conflict with the terms contained within the Settlement Agreement the terms contained within the Settlement Agreement shall prevail. Nothing hereon contained, except the provision for the application of "The Bed of Navigable Waters Act" aforesaid, shall affect the interpretation which would, apart from this Descriptive Plan, be put upon the words of any letters patent hereafter issued under the Great Seal of the Province of Ontario, or of any lease or other conveyance, or of any contract heretofore or hereafter made under the direction of the Province of Ontario.
- Survey Instructions from the Surveyor General of Ontario must be obtained prior to establishing any of the boundaries on the ground.

PRODUCED BY:  
The Office of the Surveyor General      August 20, 2013



Ministry of  
Natural Resources  
© Queen's Printer for Ontario, 2013  
Region3\_z18\_Key\_Maps.mxd

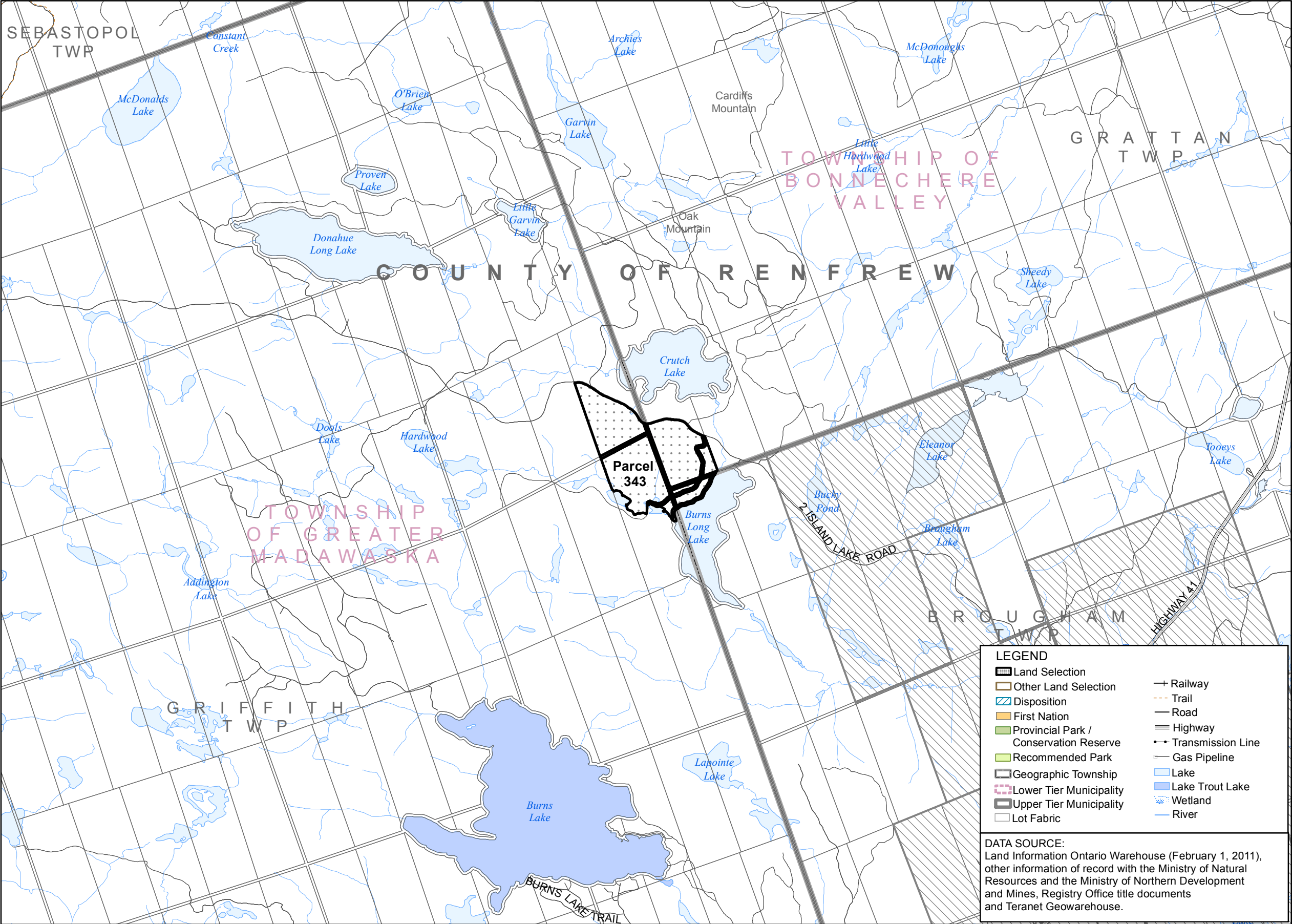

Appendix 5.1.1 - Proposed Settlement Lands

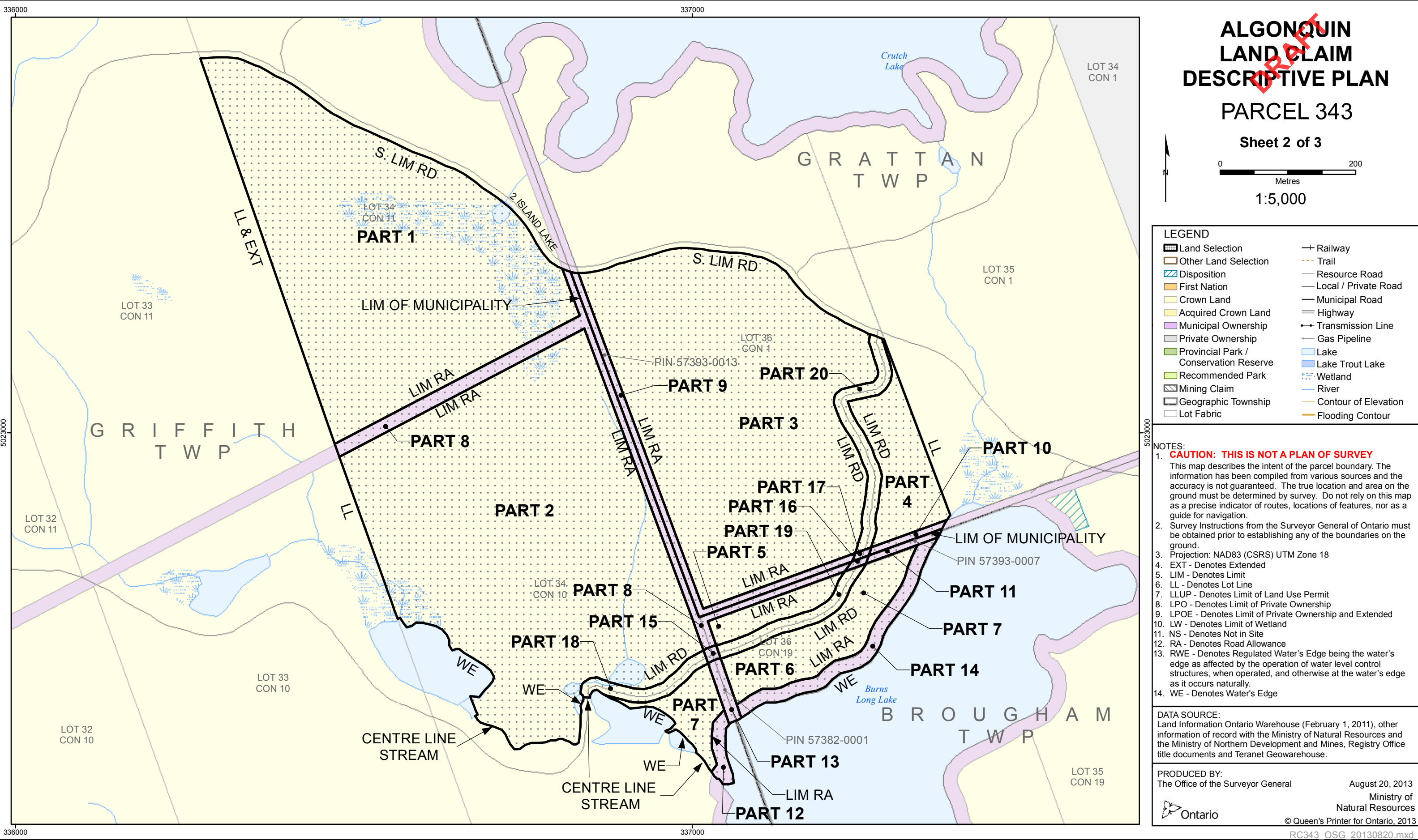

Appendix 5.1.1 - Proposed Settlement Lands

ALGONQUIN  
LAND CLAIM  
DESCRIPTIVE PLAN

PARCEL 343

SHEET 3 of 3

PART SCHEDULE						
Part #	Description	Area (ha)	Area Included (ha)	Area Not Included (ha)	Action	Comments
PART 1	Unpatented Crown Land	15.6	15.6		Patent	
PART 2		19.0	19.0			
PART 3		15.2	15.2			
PART 4		1.9	1.9			
PART 5		0.7	0.7			
PART 6		2.1	2.1			
PART 7		0.8	0.8			
PART 8	Road Allowance	1.7		1.7	Excluded	
PART 9		0.8		0.8		
PART 10		0.1		0.1		
PART 11		0.1		0.1		
PART 12	Road Allowance	0.2	0.2		AOO have requested the RA	Parties to discuss with the Municipality the possibility of transfer of the RA
PART 13	Road Allowance	0.2		0.2	Excluded	
PART 14	Road Allowance	0.8	0.8		AOO have requested the RA	Parties to discuss with the Municipality the possibility of transfer of the RA
PART 15	Road Allowance & Road	<0.1		<0.1	Excluded	This road provides access for authorized use of adjacent Crown Land
PART 16		<0.1		<0.1		
PART 17		<0.1		<0.1		
PART 18	Road	0.4		0.4	Excluded	This road provides access for authorized use of adjacent Crown Land
PART 19		0.5		0.5		
PART 20		0.8		0.8		
Total Area (ha)		60.9	56.3	4.7		
Total Area (ac)		150.5	139.0	11.5		

NOTE: Total Area as shown is the sum of areas of all parts, including those < 0.1 ha.

PRODUCED BY:  
The Office of the Surveyor General      August 20, 2013

 Ministry of  
Natural Resources  
© Queen's Printer for Ontario, 2013



Appendix 5.1.1 - Proposed Settlement Lands

Stakeholder Activities in Parcel 343

Activity	Description	Status	Size of Area (ac)	Percent of Area Affected (%)
Bait Harvest Area	PE0208	Active	150.6	0.4
Bear Management Area	PE-58-006	Inactive	150.6	0.1
Certificate of Approval	None known			
Conservation Authority	None			
Extractable Aggregate	None			
Forest Management Unit	780 - Ottawa Valley Forest			
Land Use Permit	None			
Lease	None			
Licence of Occupation	None			
Mining Claim	None			
Mining Lease	None			
Research Plot	Growth & Yield Trial Plot #CE7028			
Resident Trapper	Crown Land Trapping Authorization			
Seed Area	None			
Trail	None			
Trail	OFSC Snowmobile Trails			
Trapline Area	PE060	Active	53.0	0.4
Trapline Area	PE066	Active	11.5	0.1
Wind Power Application	None			

The information included in this table is based on the best information as of August 1, 2013. Information may be subject to change.