

Appendix 5.1.1 - Proposed Settlement Lands

ALGONQUIN LAND CLAIM DESCRIPTIVE PLAN

PARCEL 259D

Sheet 1 of 8

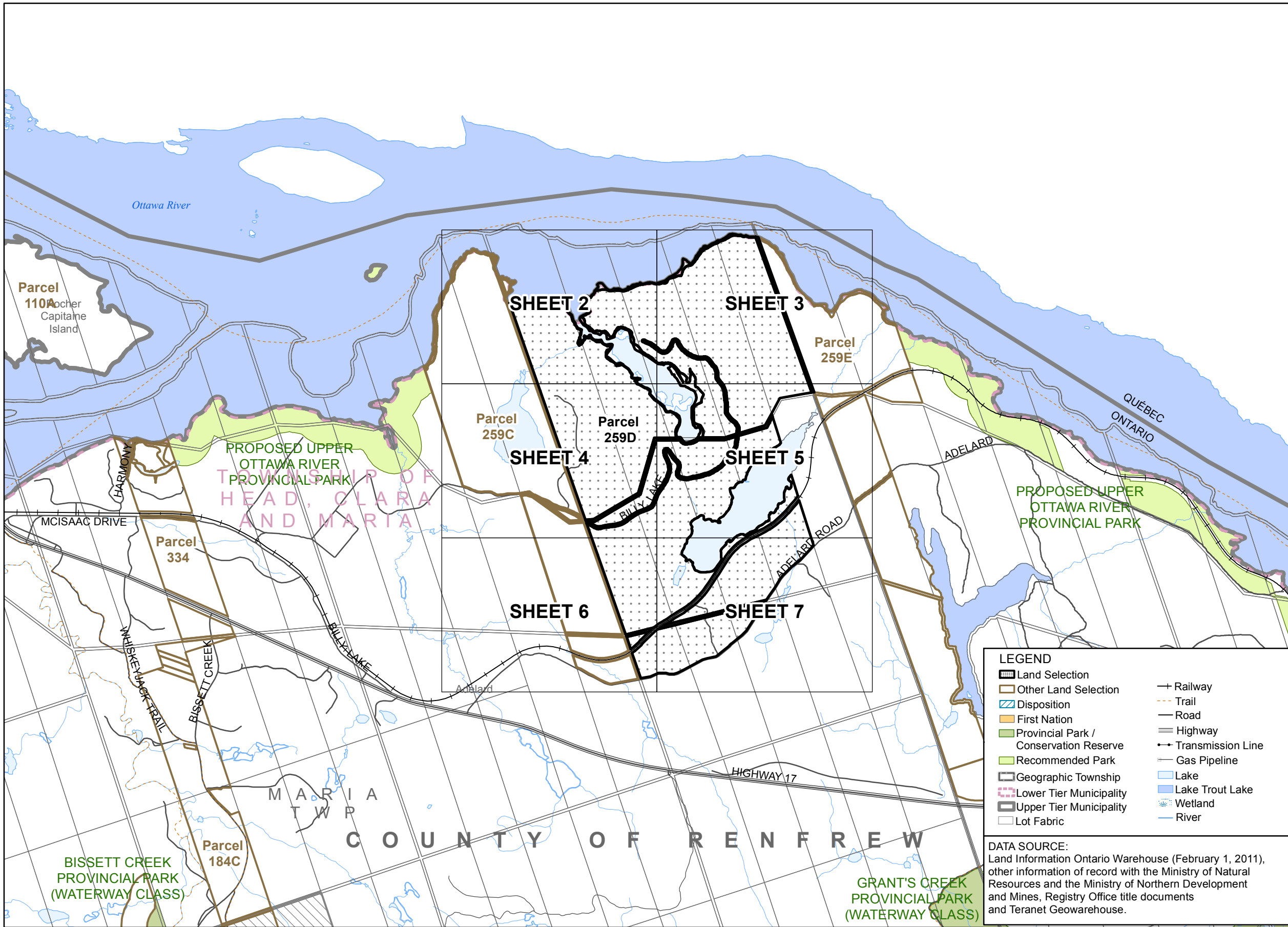
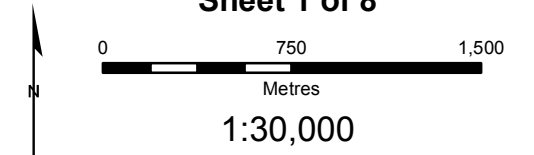

LEGEND

Land Selection	Railway
Other Land Selection	Trail
Disposition	Road
First Nation	Highway
Provincial Park / Conservation Reserve	Transmission Line
Recommended Park	Gas Pipeline
Geographic Township	Lake
Lower Tier Municipality	Lake Trout Lake
Upper Tier Municipality	Wetland
Lot Fabric	River

DATA SOURCE:
Land Information Ontario Warehouse (February 1, 2011), other information of record with the Ministry of Natural Resources and the Ministry of Northern Development and Mines, Registry Office title documents and Teranet Geowarehouse.

1. **CAUTION: THIS IS NOT A PLAN OF SURVEY**
2. This Descriptive Plan is a graphic illustration of the Settlement Lands identified in the Settlement Agreement of the Algonquin Land Claim. This plan is intended to illustrate the complex inter-relationships between the Settlement Lands and other previous dispositions and alienations of public lands and is necessary to prevent duplicate or overlapping tenure commitments on the same lands.
3. This Descriptive Plan has been prepared from the best available information but without benefit of survey. The absolute and relative positional accuracy of the data shown hereon has not been verified. Discrepancies between different data sources are known to exist. Do not use this Plan as evidence of the location of legal boundaries, township lot fabric, features, or routes. Do not rely on this Plan to determine the extent of parcel areas, the existence of navigable bodies of water nor as a guide for navigation.
4. Any sale, lease or other disposition of lands illustrated hereon made pursuant to the Settlement Agreement of the Algonquin Land Claim is limited to the extent of the un-alienated rights held by the Ministry of Natural Resources and every grant shall be subject to the provisions of the statute of the Bed of Navigable Waters Act, R.S.O. 1990, Chapter B.4.
5. The boundary information must be read in conjunction with all Notes appearing in and on the Plan series and within the terms of the Settlement Agreement. Should the provisions contained on the Descriptive Plan be found to conflict with the terms contained within the Settlement Agreement the terms contained within the Settlement Agreement shall prevail. Nothing hereon contained, except the provision for the application of "The Bed of Navigable Waters Act" aforesaid, shall affect the interpretation which would, apart from this Descriptive Plan, be put upon the words of any letters patent hereafter issued under the Great Seal of the Province of Ontario, or of any lease or other conveyance, or of any contract heretofore or hereafter made under the direction of the Province of Ontario.
6. Survey Instructions from the Surveyor General of Ontario must be obtained prior to establishing any of the boundaries on the ground.

PRODUCED BY:
The Office of the Surveyor General March 26, 2014

Ontario Ministry of Natural Resources

© Queen's Printer for Ontario, 2014
Region3_z18_Key_Maps.mxd

Appendix 5.1.1 - Proposed Settlement Lands

ALGONQUIN LAND CLAIM DESCRIPTIVE PLAN

PARCEL 259D

Sheet 2 of 8

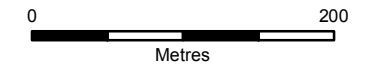

1:5,000

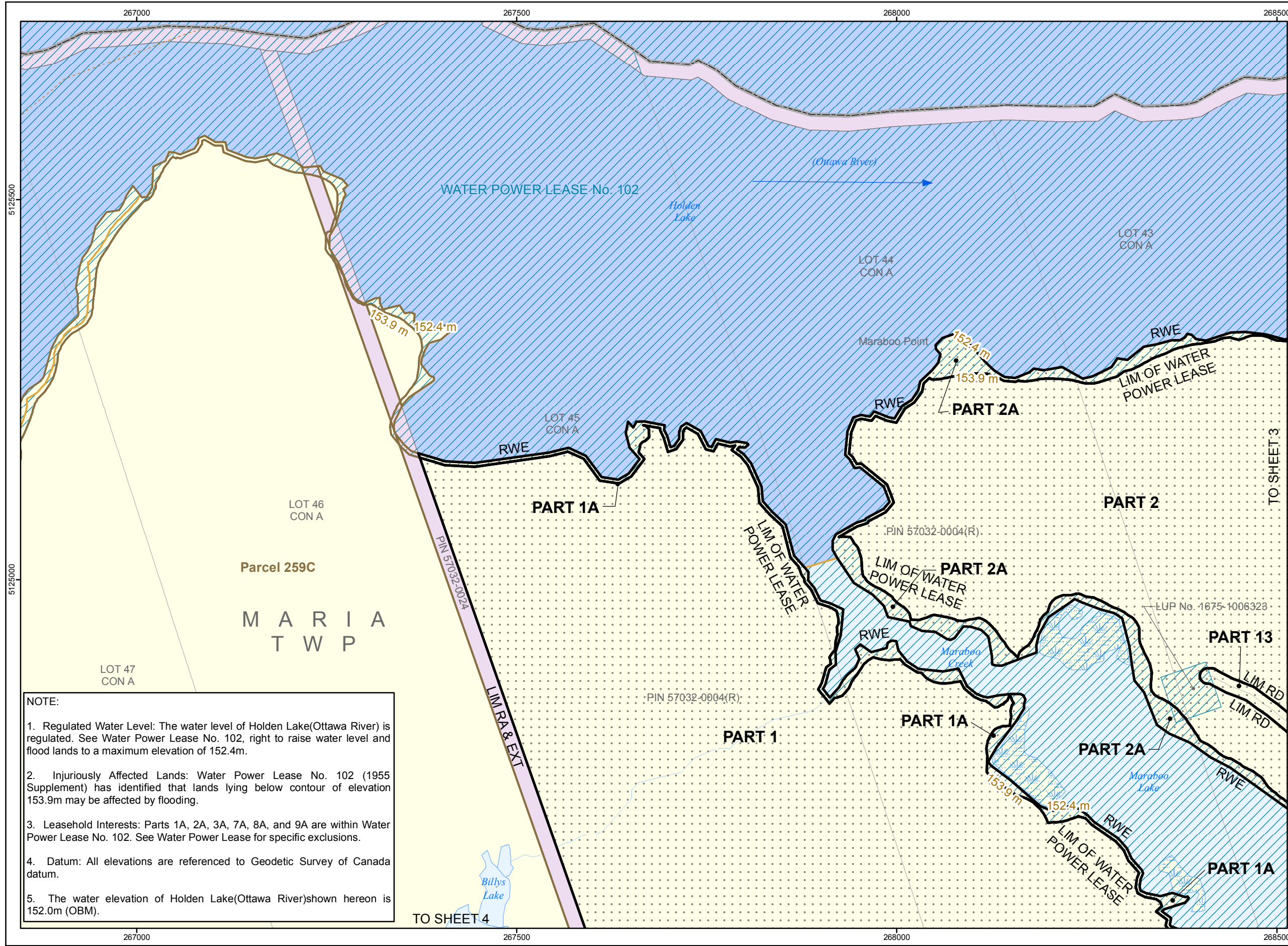

LEGEND

Land Selection	Railway
Other Land Selection	Trail
Disposition	Resource Road
First Nation	Local / Private Road
Crown Land	Municipal Road
Acquired Crown Land	Highway
Municipal Ownership	Transmission Line
Private Ownership	Gas Pipeline
Provincial Park / Conservation Reserve	Lake
Recommended Park	Lake Trout Lake
Mining Claim	Wetland
Geographic Township	River
Lot Fabric	Contour of Elevation
	Flooding Contour

- NOTES:**
- CAUTION: THIS IS NOT A PLAN OF SURVEY**
This map describes the intent of the parcel boundary. The information has been compiled from various sources and the accuracy is not guaranteed. The true location and area on the ground must be determined by survey. Do not rely on this map as a precise indicator of routes, locations of features, nor as a guide for navigation.
 - Survey Instructions from the Surveyor General of Ontario must be obtained prior to establishing any of the boundaries on the ground.
 - Projection: NAD83 (CSRS) UTM Zone 18
 - EXT - Denotes Extended
 - LIM - Denotes Limit
 - LL - Denotes Lot Line
 - LLUP - Denotes Limit of Land Use Permit
 - LPO - Denotes Limit of Private Ownership
 - LPOE - Denotes Limit of Private Ownership and Extended
 - LW - Denotes Limit of Wetland
 - NS - Denotes Not in Site
 - RA - Denotes Road Allowance
 - RWE - Denotes Regulated Water's Edge being the water's edge as affected by the operation of water level control structures, when operated, and otherwise at the water's edge as it occurs naturally.
 - WE - Denotes Water's Edge

DATA SOURCE:
Land Information Ontario Warehouse (February 1, 2011), other information of record with the Ministry of Natural Resources and the Ministry of Northern Development and Mines, Registry Office title documents and Teranet Geowarehouse.

PRODUCED BY:
The Office of the Surveyor General
March 26, 2014
Ministry of Natural Resources
Ontario
© Queen's Printer for Ontario, 2014
RC259D_OSG_20140326.mxd

- NOTE:**
- Regulated Water Level: The water level of Holden Lake(Ottawa River) is regulated. See Water Power Lease No. 102, right to raise water level and flood lands to a maximum elevation of 152.4m.
 - Injurious Affected Lands: Water Power Lease No. 102 (1955 Supplement) has identified that lands lying below contour of elevation 153.9m may be affected by flooding.
 - Leasehold Interests: Parts 1A, 2A, 3A, 7A, 8A, and 9A are within Water Power Lease No. 102. See Water Power Lease for specific exclusions.
 - Datum: All elevations are referenced to Geodetic Survey of Canada datum.
 - The water elevation of Holden Lake(Ottawa River) shown hereon is 152.0m (OBM).

Appendix 5.1.1 - Proposed Settlement Lands

ALGONQUIN LAND CLAIM DESCRIPTIVE PLAN PARCEL 259D

Sheet 3 of 8

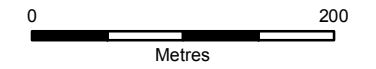

1:5,000

NOTE:

1. Regulated Water Level: The water level of Holden Lake(Ottawa River) is regulated. See Water Power Lease No. 102, right to raise water level and flood lands to a maximum elevation of 152.4m.
2. Injurious Affected Lands: Water Power Lease No. 102(1955 Supplement) has identified that lands lying below contour of elevation 153.9m may be affected by flooding.
3. Leasehold Interests: Parts 1A, 2A, 3A, 7A, 8A, and 9A are within Water Power Lease No. 102. See Water Power Lease for specific exclusions.
4. Datum: All elevations are referenced to Geodetic Survey of Canada datum.
5. The water elevation of Holden Lake(Ottawa River)shown hereon is 152.0m(OBM).

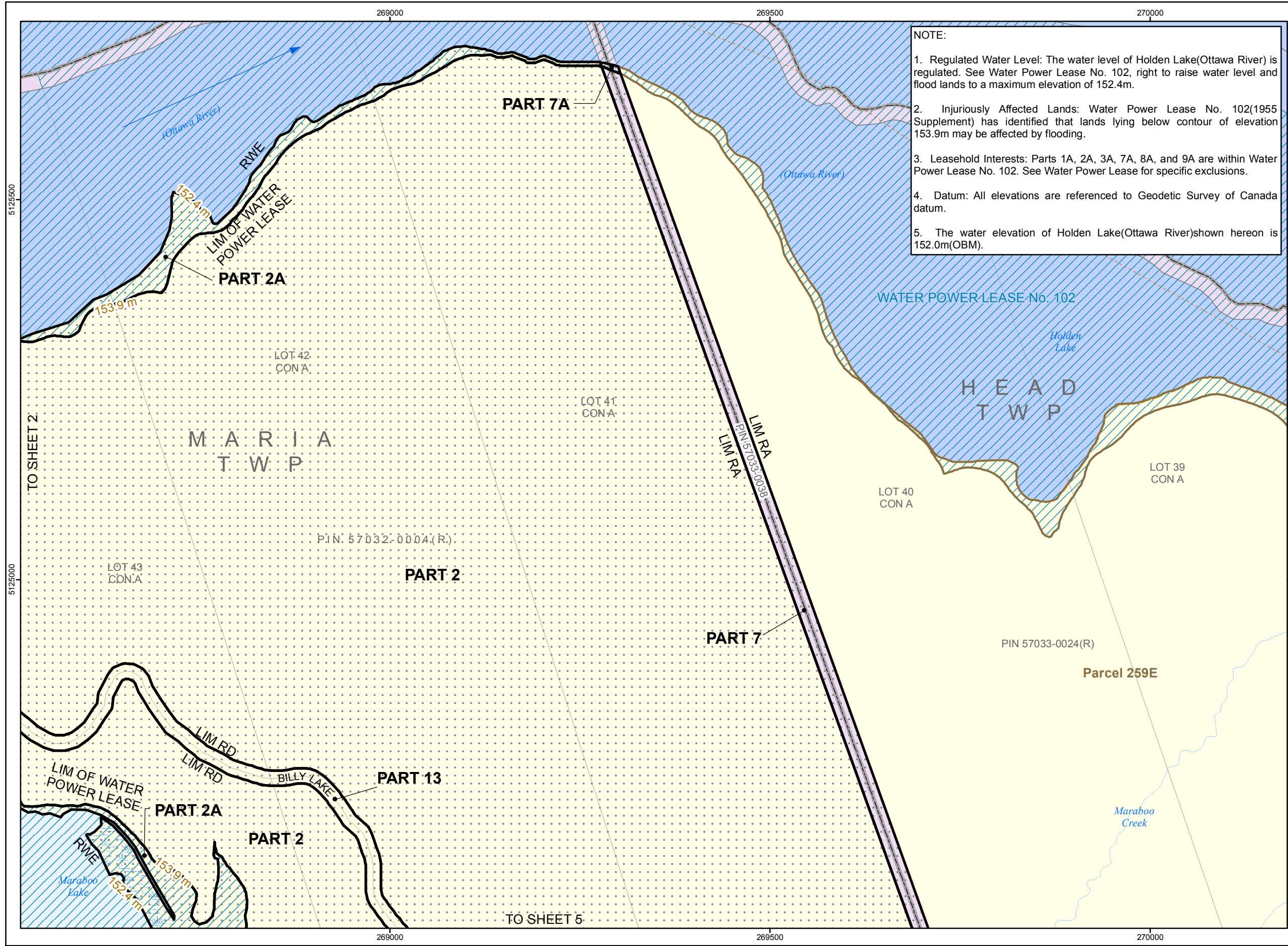

LEGEND

Land Selection	Railway
Other Land Selection	Trail
Disposition	Resource Road
First Nation	Local / Private Road
Crown Land	Municipal Road
Acquired Crown Land	Highway
Municipal Ownership	Transmission Line
Private Ownership	Gas Pipeline
Provincial Park / Conservation Reserve	Lake
Recommended Park	Lake Trout Lake
Mining Claim	Wetland
Geographic Township	River
Lot Fabric	Contour of Elevation
	Flooding Contour

- NOTES:**
1. **CAUTION: THIS IS NOT A PLAN OF SURVEY**
This map describes the intent of the parcel boundary. The information has been compiled from various sources and the accuracy is not guaranteed. The true location and area on the ground must be determined by survey. Do not rely on this map as a precise indicator of routes, locations of features, nor as a guide for navigation.
 2. Survey Instructions from the Surveyor General of Ontario must be obtained prior to establishing any of the boundaries on the ground.
 3. Projection: NAD83 (CSRS) UTM Zone 18
 4. EXT - Denotes Extended
 5. LIM - Denotes Limit
 6. LL - Denotes Lot Line
 7. LLUP - Denotes Limit of Land Use Permit
 8. LPO - Denotes Limit of Private Ownership
 9. LPOE - Denotes Limit of Private Ownership and Extended
 10. LW - Denotes Limit of Wetland
 11. NS - Denotes Not in Site
 12. RA - Denotes Road Allowance
 13. RWE - Denotes Regulated Water's Edge being the water's edge as affected by the operation of water level control structures, when operated, and otherwise at the water's edge as it occurs naturally.
 14. WE - Denotes Water's Edge

DATA SOURCE:
Land Information Ontario Warehouse (February 1, 2011), other information of record with the Ministry of Natural Resources and the Ministry of Northern Development and Mines, Registry Office title documents and Teranet Geowarehouse.

PRODUCED BY:
The Office of the Surveyor General
March 26, 2014
Ministry of Natural Resources
Ontario
© Queen's Printer for Ontario, 2014

Appendix 5.1.1 - Proposed Settlement Lands

ALGONQUIN LAND CLAIM DESCRIPTIVE PLAN

PARCEL 259D

Sheet 4 of 8

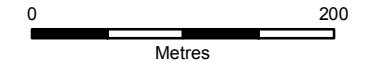

1:5,000

LEGEND

Land Selection	Railway
Other Land Selection	Trail
Disposition	Resource Road
First Nation	Local / Private Road
Crown Land	Municipal Road
Acquired Crown Land	Highway
Municipal Ownership	Transmission Line
Private Ownership	Gas Pipeline
Provincial Park / Conservation Reserve	Lake
Recommended Park	Lake Trout Lake
Mining Claim	Wetland
Geographic Township	River
Lot Fabric	Contour of Elevation
	Flooding Contour

NOTES:

- CAUTION: THIS IS NOT A PLAN OF SURVEY**
This map describes the intent of the parcel boundary. The information has been compiled from various sources and the accuracy is not guaranteed. The true location and area on the ground must be determined by survey. Do not rely on this map as a precise indicator of routes, locations of features, nor as a guide for navigation.
- Survey Instructions from the Surveyor General of Ontario must be obtained prior to establishing any of the boundaries on the ground.
- Projection: NAD83 (CSRS) UTM Zone 18
- EXT - Denotes Extended
- LIM - Denotes Limit
- LL - Denotes Lot Line
- LLUP - Denotes Limit of Land Use Permit
- LPO - Denotes Limit of Private Ownership
- LPOE - Denotes Limit of Private Ownership and Extended
- LW - Denotes Limit of Wetland
- NS - Denotes Not in Site
- RA - Denotes Road Allowance
- RWE - Denotes Regulated Water's Edge being the water's edge as affected by the operation of water level control structures, when operated, and otherwise at the water's edge as it occurs naturally.
- WE - Denotes Water's Edge

DATA SOURCE:
Land Information Ontario Warehouse (February 1, 2011), other information of record with the Ministry of Natural Resources and the Ministry of Northern Development and Mines, Registry Office title documents and Teranet Geowarehouse.

PRODUCED BY:
The Office of the Surveyor General
March 26, 2014
Ministry of Natural Resources



© Queen's Printer for Ontario, 2014

RC259D_OSG_20140326.mxd

NOTE:

- Regulated Water Level: The water level of Holden Lake(Ottawa River) is regulated. See Water Power Lease No. 102, right to raise water level and flood lands to a maximum elevation of 152.4m.
- Injurious Lands: Water Power Lease No. 102 (1955 Supplement) has identified that lands lying below contour of elevation 153.9m may be affected by flooding.
- Leasehold Interests: Parts 1A, 2A, 3A, 7A, 8A, and 9A are within Water Power Lease No. 102. See Water Power Lease for specific exclusions.
- Datum: All elevations are referenced to Geodetic Survey of Canada datum.
- The water elevation of Holden Lake(Ottawa River)shown hereon is 152.0m (OBM).

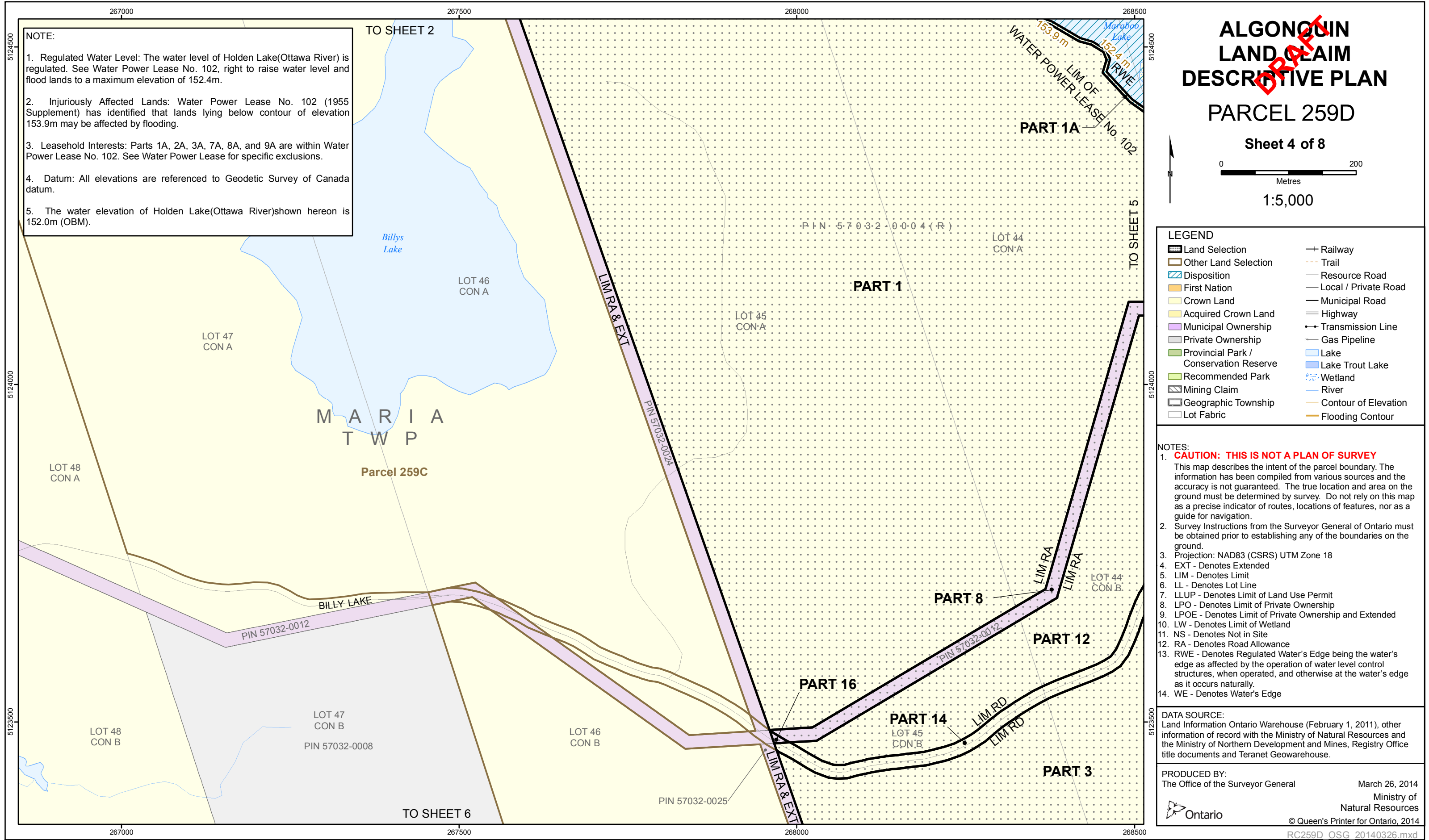

RC259D_OSG_20140326.mxd

Appendix 5.1.1 - Proposed Settlement Lands

ALGONQUIN LAND CLAIM DESCRIPTIVE PLAN

PARCEL 259D

Sheet 5 of 8

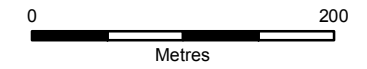

1:5,000

LEGEND

	Land Selection		Railway
	Other Land Selection		Trail
	Disposition		Resource Road
	First Nation		Local / Private Road
	Crown Land		Municipal Road
	Acquired Crown Land		Highway
	Municipal Ownership		Transmission Line
	Private Ownership		Gas Pipeline
	Provincial Park / Conservation Reserve		Lake
	Recommended Park		Lake Trout Lake
	Mining Claim		Wetland
	Geographic Township		River
	Lot Fabric		Contour of Elevation
			Flooding Contour

NOTE:

1. Regulated Water Level: The water level of Holden Lake(Ottawa River) is regulated. See Water Power Lease No. 102, right to raise water level and flood lands to a maximum elevation of 152.4m.
2. Injurious Affected Lands: Water Power Lease No. 102(1955 Supplement) has identified that lands lying below contour of elevation 153.9m may be affected by flooding.
3. Leasehold Interests: Parts 1A, 2A, 3A, 7A, 8A, and 9A are within Water Power Lease No. 102. See Water Power Lease for specific exclusions.
4. Datum: All elevations are referenced to Geodetic Survey of Canada datum.
5. The water elevation of Holden Lake(Ottawa River)shown hereon is 152.0m(OBM).

NOTES:

1. **CAUTION: THIS IS NOT A PLAN OF SURVEY**
This map describes the intent of the parcel boundary. The information has been compiled from various sources and the accuracy is not guaranteed. The true location and area on the ground must be determined by survey. Do not rely on this map as a precise indicator of routes, locations of features, nor as a guide for navigation.
2. Survey Instructions from the Surveyor General of Ontario must be obtained prior to establishing any of the boundaries on the ground.
3. Projection: NAD83 (CSRS) UTM Zone 18
4. EXT - Denotes Extended
5. LIM - Denotes Limit
6. LL - Denotes Lot Line
7. LLUP - Denotes Limit of Land Use Permit
8. LPO - Denotes Limit of Private Ownership
9. LPOE - Denotes Limit of Private Ownership and Extended
10. LW - Denotes Limit of Wetland
11. NS - Denotes Not in Site
12. RA - Denotes Road Allowance
13. RWE - Denotes Regulated Water's Edge being the water's edge as affected by the operation of water level control structures, when operated, and otherwise at the water's edge as it occurs naturally.
14. WE - Denotes Water's Edge

DATA SOURCE:
Land Information Ontario Warehouse (February 1, 2011), other information of record with the Ministry of Natural Resources and the Ministry of Northern Development and Mines, Registry Office title documents and Teranet Geowarehouse.

PRODUCED BY:
The Office of the Surveyor General
March 26, 2014
Ministry of Natural Resources
Ontario

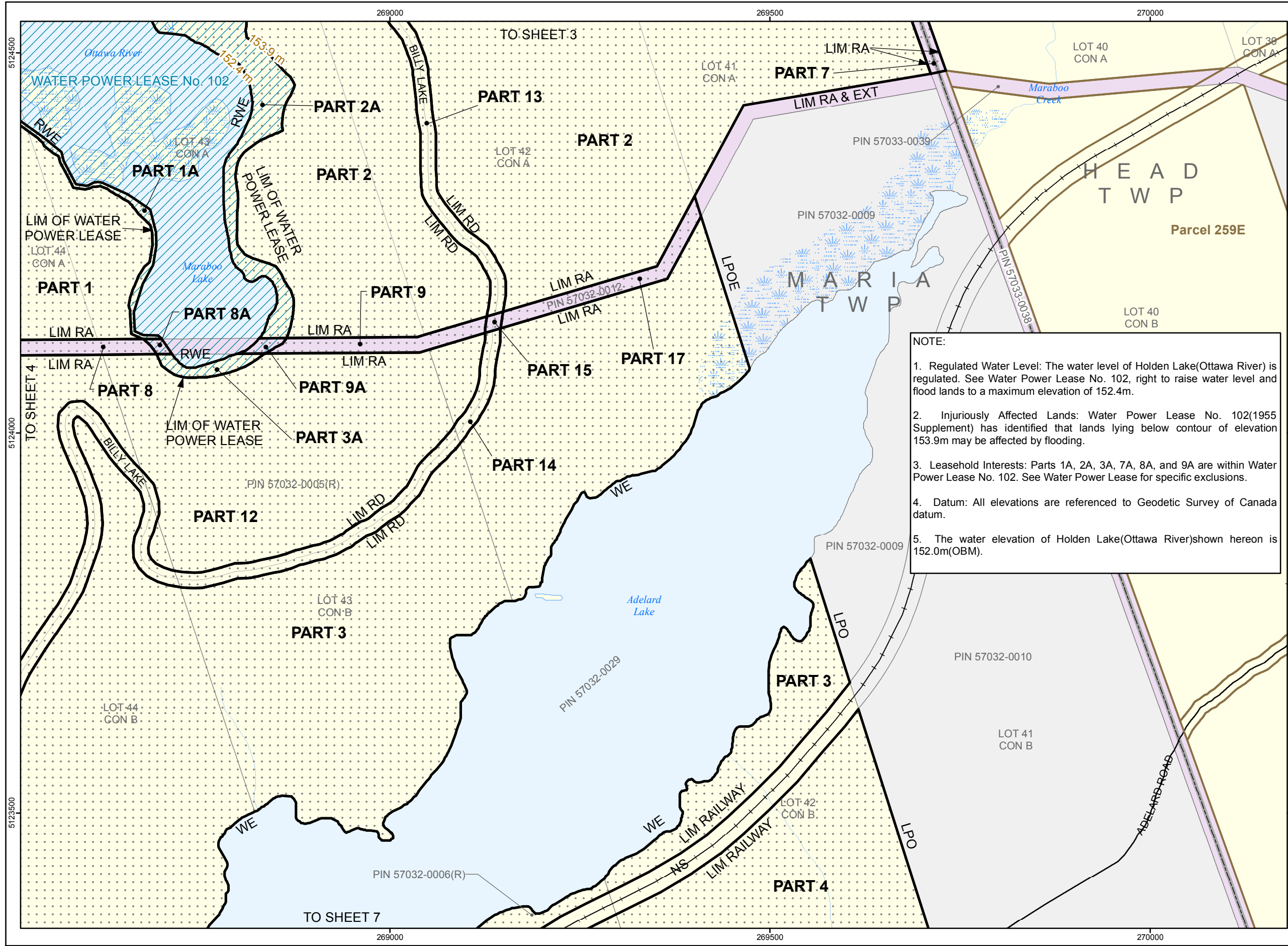

Appendix 5.1.1 - Proposed Settlement Lands

ALGONQUIN LAND CLAIM DESCRIPTIVE PLAN

PARCEL 259D

Sheet 6 of 8

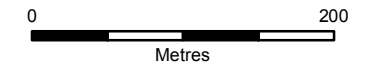

1:5,000

LEGEND	
	Land Selection
	Other Land Selection
	Disposition
	First Nation
	Crown Land
	Acquired Crown Land
	Municipal Ownership
	Private Ownership
	Provincial Park / Conservation Reserve
	Recommended Park
	Mining Claim
	Geographic Township
	Lot Fabric
	Railway
	Trail
	Resource Road
	Local / Private Road
	Municipal Road
	Highway
	Transmission Line
	Gas Pipeline
	Lake
	Lake Trout Lake
	Wetland
	River
	Contour of Elevation
	Flooding Contour

- NOTES:
- CAUTION: THIS IS NOT A PLAN OF SURVEY**
This map describes the intent of the parcel boundary. The information has been compiled from various sources and the accuracy is not guaranteed. The true location and area on the ground must be determined by survey. Do not rely on this map as a precise indicator of routes, locations of features, nor as a guide for navigation.
 - Survey Instructions from the Surveyor General of Ontario must be obtained prior to establishing any of the boundaries on the ground.
 - Projection: NAD83 (CSRS) UTM Zone 18
 - EXT - Denotes Extended
 - LIM - Denotes Limit
 - LL - Denotes Lot Line
 - LLUP - Denotes Limit of Land Use Permit
 - LPO - Denotes Limit of Private Ownership
 - LPOE - Denotes Limit of Private Ownership and Extended
 - LW - Denotes Limit of Wetland
 - NS - Denotes Not in Site
 - RA - Denotes Road Allowance
 - RWE - Denotes Regulated Water's Edge being the water's edge as affected by the operation of water level control structures, when operated, and otherwise at the water's edge as it occurs naturally.
 - WE - Denotes Water's Edge

DATA SOURCE:
Land Information Ontario Warehouse (February 1, 2011), other information of record with the Ministry of Natural Resources and the Ministry of Northern Development and Mines, Registry Office title documents and Teranet Geowarehouse.

PRODUCED BY:
The Office of the Surveyor General
March 26, 2014
Ministry of Natural Resources
Ontario

© Queen's Printer for Ontario, 2014

RC259D_OSG_20140326.mxd

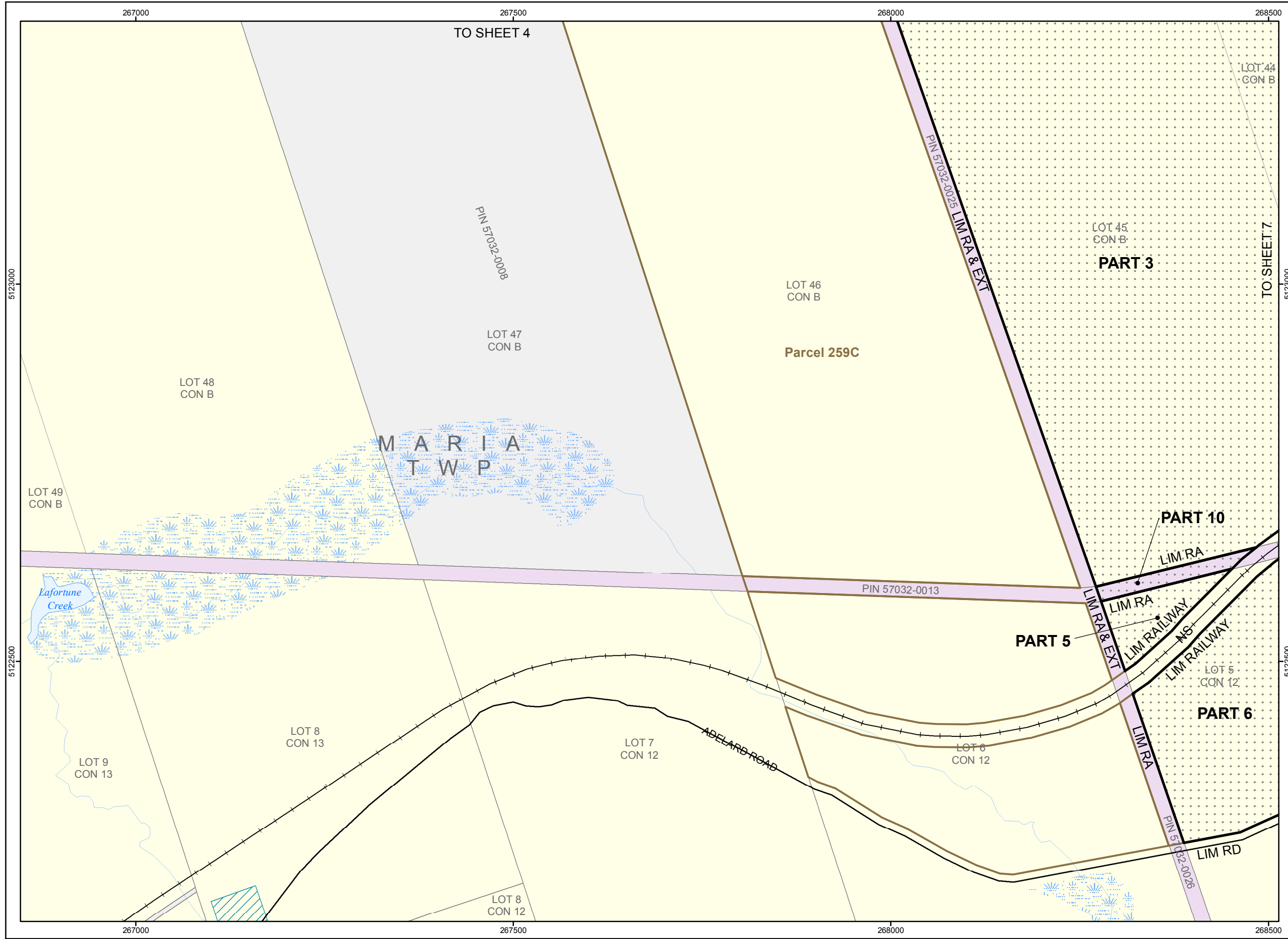

Appendix 5.1.1 - Proposed Settlement Lands

ALGONQUIN LAND CLAIM DESCRIPTIVE PLAN

PARCEL 259D

Sheet 7 of 8

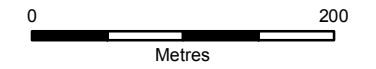

1:5,000

LEGEND

	Land Selection		Railway
	Other Land Selection		Trail
	Disposition		Resource Road
	First Nation		Local / Private Road
	Crown Land		Municipal Road
	Acquired Crown Land		Highway
	Municipal Ownership		Transmission Line
	Private Ownership		Gas Pipeline
	Provincial Park / Conservation Reserve		Lake
	Recommended Park		Lake Trout Lake
	Mining Claim		Wetland
	Geographic Township		River
	Lot Fabric		Contour of Elevation
			Flooding Contour

NOTES:

- CAUTION: THIS IS NOT A PLAN OF SURVEY**
This map describes the intent of the parcel boundary. The information has been compiled from various sources and the accuracy is not guaranteed. The true location and area on the ground must be determined by survey. Do not rely on this map as a precise indicator of routes, locations of features, nor as a guide for navigation.
- Survey Instructions from the Surveyor General of Ontario must be obtained prior to establishing any of the boundaries on the ground.
- Projection: NAD83 (CSRS) UTM Zone 18
- EXT - Denotes Extended
- LIM - Denotes Limit
- LL - Denotes Lot Line
- LLUP - Denotes Limit of Land Use Permit
- LPO - Denotes Limit of Private Ownership
- LPOE - Denotes Limit of Private Ownership and Extended
- LW - Denotes Limit of Wetland
- NS - Denotes Not in Site
- RA - Denotes Road Allowance
- RWE - Denotes Regulated Water's Edge being the water's edge as affected by the operation of water level control structures, when operated, and otherwise at the water's edge as it occurs naturally.
- WE - Denotes Water's Edge

DATA SOURCE:
Land Information Ontario Warehouse (February 1, 2011), other information of record with the Ministry of Natural Resources and the Ministry of Northern Development and Mines, Registry Office title documents and Teranet Geowarehouse.

PRODUCED BY:
The Office of the Surveyor General
March 26, 2014
Ministry of Natural Resources



© Queen's Printer for Ontario, 2014

RC259D_OSG_20140326.mxd

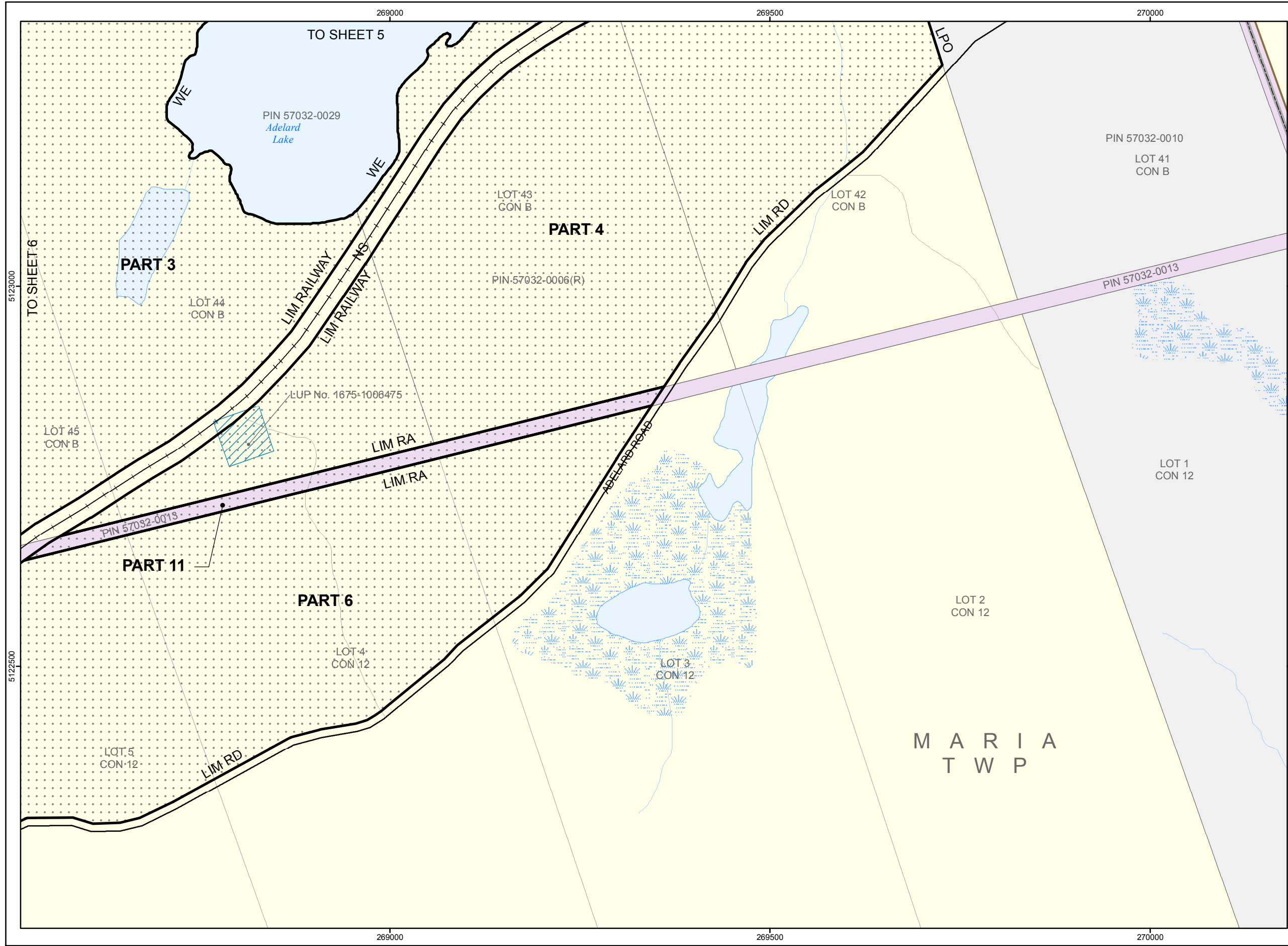

Appendix 5.1.1 - Proposed Settlement Lands

**ALGONQUIN
LAND CLAIM
DESCRIPTIVE PLAN**
PARCEL 259D

SHEET 8 of 8

PART SCHEDULE						
Part #	Description	Area (ha)	Area Included (ha)	Area Not Included (ha)	Action	Comments
PART 1	Unpatented Crown Land	105.4	105.4		Patent	
PART 1A	Unpatented Crown Land (Water Power Lease 102 and 1955 Supplement to Water Power Lease 102)	1.7		1.7	Excluded	Parties to discuss with public utility the possibility of transfer of lands affected by WPL
PART 2	Unpatented Crown Land	139.1	139.1		Patent	
PART 2A	Unpatented Crown Land (Water Power Lease 102 and 1955 Supplement to Water Power Lease 102)	6.4		6.4	Excluded	Parties to discuss with public utility the possibility of transfer of lands affected by WPL
PART 3	Unpatented Crown Land	89.3	89.3		Patent	
PART 3A	Unpatented Crown Land (Water Power Lease 102 and 1955 Supplement to Water Power Lease 102)	0.2		0.2	Excluded	Parties to discuss with public utility the possibility of transfer of lands affected by WPL
PART 4	Unpatented Crown Land	35.6	35.6		Patent	
PART 5		0.9	0.9			
PART 6		27.7	27.7			
PART 7	Road Allowance	2.6		2.6	Excluded	
PART 7A	Road Allowance (Water Power Lease 102 and 1955 Supplement to Water Power Lease 102)	<0.1		<0.1	Excluded	Parties to discuss with public utility the possibility of transfer of lands affected by WPL
PART 8	Road Allowance	2.2		2.2	Excluded	
PART 8A	Road Allowance (Water Power Lease 102 and 1955 Supplement to Water Power Lease 102)	< 0.1		< 0.1	Excluded	Parties to discuss with public utility the possibility of transfer of lands affected by WPL
PART 9	Road Allowance	0.6		0.6	Excluded	
PART 9A	Road Allowance (Water Power Lease 102 and 1955 Supplement to Water Power Lease 102)	0.1		0.1	Excluded	Parties to discuss with public utility the possibility of transfer of lands affected by WPL
PART 10	Road Allowance	0.4		0.4	Excluded	
PART 11		1.7		1.7		
PART 12	Unpatented Crown Land	20.4	20.4		Patent	
PART 13	Road	2.6	2.6		Patent	This road provides access to recreation camp authorized under Land Use Permit
PART 14		3.9	3.9			
PART 15	Road Allowance & Road	<0.1		<0.1	Excluded	
PART 16		<0.1		<0.1		
PART 17	Road Allowance	0.6		0.6	Excluded	
Total Area (ha)		441.4	424.9	16.5		
Total Area (ac)		1090.8	1049.9	40.9		

NOTE: Total Area as shown is the sum of areas of all parts, including those < 0.1 ha.

PRODUCED BY:
The Office of the Surveyor General March 26, 2014

 Ontario Ministry of
Natural Resources

Appendix 5.1.1 - Proposed Settlement Lands

Stakeholder Activities in Parcel 259D

Activity	Description	Status	Size of Area (ac)	Percent of Area Affected (%)
Bait Harvest Area	PE0107	Active	2.9	< 0.1
Bait Harvest Area	PE0108	Active	1088.0	2.7
Bear Management Area	PE-48-010	Active	1086.3	15.5
Certificate of Approval	None known			
Conservation Authority	None			
Extractable Aggregate	None			
Forest Management Unit	780 - Ottawa Valley Forest			
Land Use Permit	LUP #1675-1006323 - Rec Camp			
Land Use Permit	LUP #1675-1006475 - Rec Camp			
Lease	OPG Water Power Lease Agreement #102			
Licence of Occupation	None			
Mining Claim	None			
Mining Lease	None			
Research Plot	None			
Resident Trapper	None			
Seed Area	None			
Trail	None			
Trapline Area	PE003	Active	1077.1	3.0
Wind Power Application	None			

The information included in this table is based on the best information as of August 1, 2013. Information may be subject to change.