

APPENDIX 5.1.1 - Proposed Settlement Lands

ALGONQUIN  
LAND CLAIM  
DESCRIPTIVE PLAN  
PARCEL 192B

Sheet 1 of 8

0 500 1,000  
Metres

1:30,000

- CAUTION: THIS IS NOT A PLAN OF SURVEY**
- This Descriptive Plan is a graphic illustration of the Settlement Lands identified in the Settlement Agreement of the Algonquin Land Claim. This plan is intended to illustrate the complex inter-relationships between the Settlement Lands and other previous dispositions and alienations of public lands and is necessary to prevent duplicate or overlapping tenure commitments on the same lands.
- This Descriptive Plan has been prepared from the best available information but without benefit of survey. The absolute and relative positional accuracy of the data shown hereon has not been verified. Discrepancies between different data sources are known to exist. Do not use this Plan as evidence of the location of legal boundaries, township lot fabric, features, or routes. Do not rely on this Plan to determine the extent of parcel areas, the existence of navigable bodies of water nor as a guide for navigation.
- Any sale, lease or other disposition of lands illustrated hereon made pursuant to the Settlement Agreement of the Algonquin Land Claim is limited to the extent of the un-alienated rights held by the Ministry of Natural Resources and every grant shall be subject to the provisions of the statute of the Bed of Navigable Waters Act, R.S.O. 1990, Chapter B.4.
- The boundary information must be read in conjunction with all Notes appearing in and on the Plan series and within the terms of the Settlement Agreement. Should the provisions contained on the Descriptive Plan be found to conflict with the terms contained within the Settlement Agreement the terms contained within the Settlement Agreement shall prevail. Nothing hereon contained, except the provision for the application of "The Bed of Navigable Waters Act" aforesaid, shall affect the interpretation which would, apart from this Descriptive Plan, be put upon the words of any letters patent hereafter issued under the Great Seal of the Province of Ontario, or of any lease or other conveyance, or of any contract heretofore or hereafter made under the direction of the Province of Ontario.
- Survey Instructions from the Surveyor General of Ontario must be obtained prior to establishing any of the boundaries on the ground.

PRODUCED BY:  
The Office of the Surveyor General April 17, 2014



Ministry of  
Natural Resources

© Queen's Printer for Ontario, 2014

Region2\_z18\_Key\_Maps.mxd

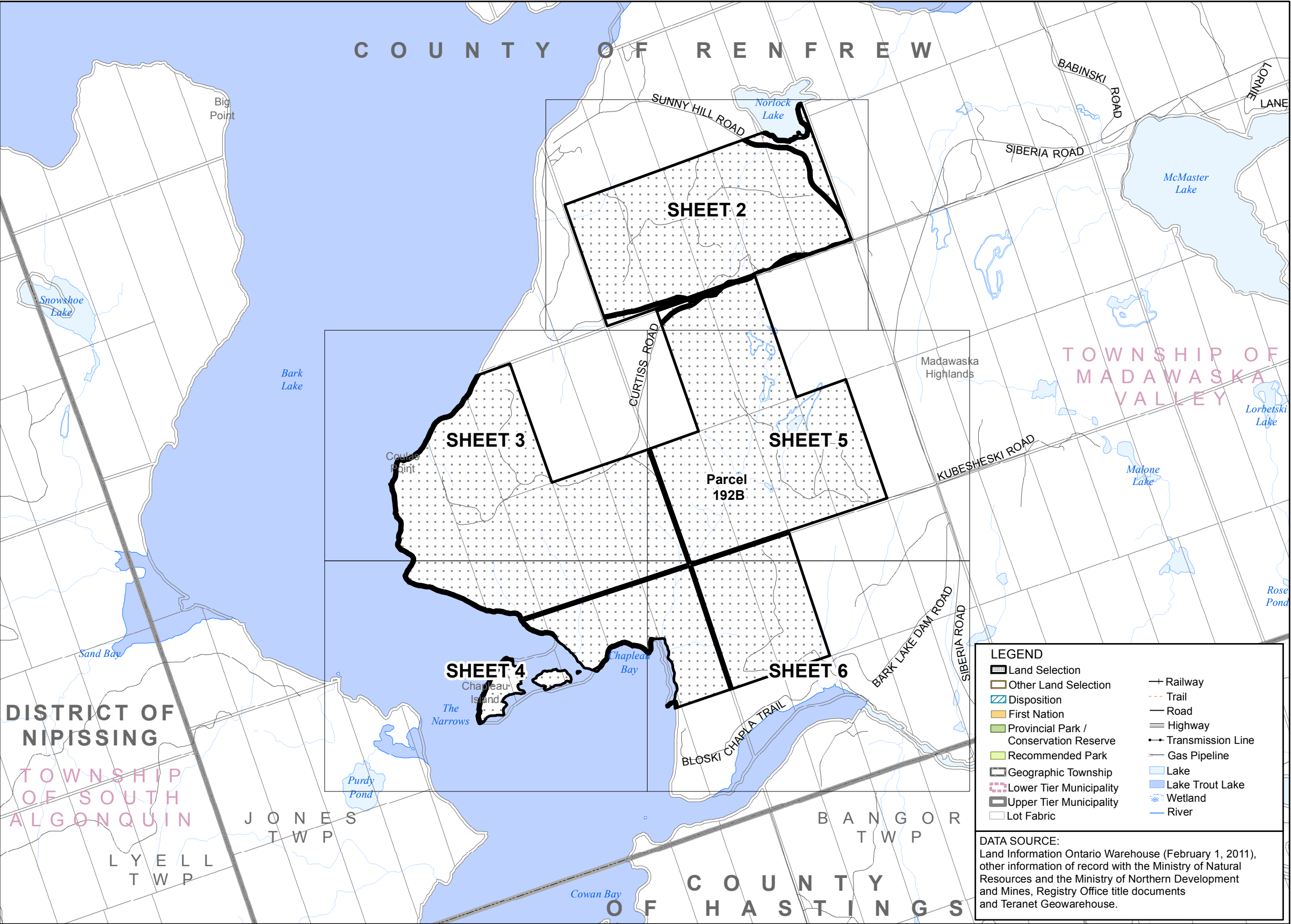

APPENDIX 5.1.1 - Proposed Settlement Lands

ALGONQUIN  
LAND CLAIM  
DESCRIPTIVE PLAN

PARCEL 192B

SHEET 2 of 8

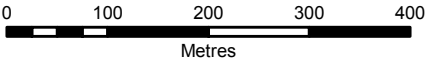

1:7,500

LEGEND

Land Selection	Railway
Other Land Selection	Trail
Disposition	Resource Road
First Nation	Local / Private Road
Crown Land	Municipal Road
Acquired Crown Land	Highway
Municipal Ownership	Transmission Line
Private Ownership	Gas Pipeline
Provincial Park / Conservation Reserve	Lake
Recommended Park	Lake Trout Lake
Mining Claim	Wetland
Geographic Township	River
Lot Fabric	Contour of Elevation
	Flooding Contour

NOTES:

- CAUTION: THIS IS NOT A PLAN OF SURVEY**  
This map describes the intent of the parcel boundary. The information has been compiled from various sources and the accuracy is not guaranteed. The true location and area on the ground must be determined by survey. Do not rely on this map as a precise indicator of routes, locations of features, nor as a guide for navigation.
- Survey Instructions from the Surveyor General of Ontario must be obtained prior to establishing any of the boundaries on the ground.
- Projection: NAD83 (CSRS) UTM Zone 18
- EXT - Denotes Extended
- LIM - Denotes Limit
- LL - Denotes Lot Line
- LLUP - Denotes Limit of Land Use Permit
- LPO - Denotes Limit of Private Ownership
- LPOE - Denotes Limit of Private Ownership and Extended
- LW - Denotes Limit of Wetland
- NS - Denotes Not in Site
- RA - Denotes Road Allowance
- RWE - Denotes Regulated Water's Edge being the water's edge as affected by the operation of water level control structures, when operated, and otherwise at the water's edge as it occurs naturally.
- WE - Denotes Water's Edge

DATA SOURCE:  
Land Information Ontario Warehouse (February 1, 2011), other information of record with the Ministry of Natural Resources and the Ministry of Northern Development and Mines, Registry Office title documents and Teranet Geowarehouse.

PRODUCED BY:  
The Office of the Surveyor General  
April 17, 2014  
Ministry of  
Natural Resources  
Ontario

© Queen's Printer for Ontario, 2014

RC192B\_OSG\_20140417.mxd

## APPENDIX 5.1.1 - Proposed Settlement Lands

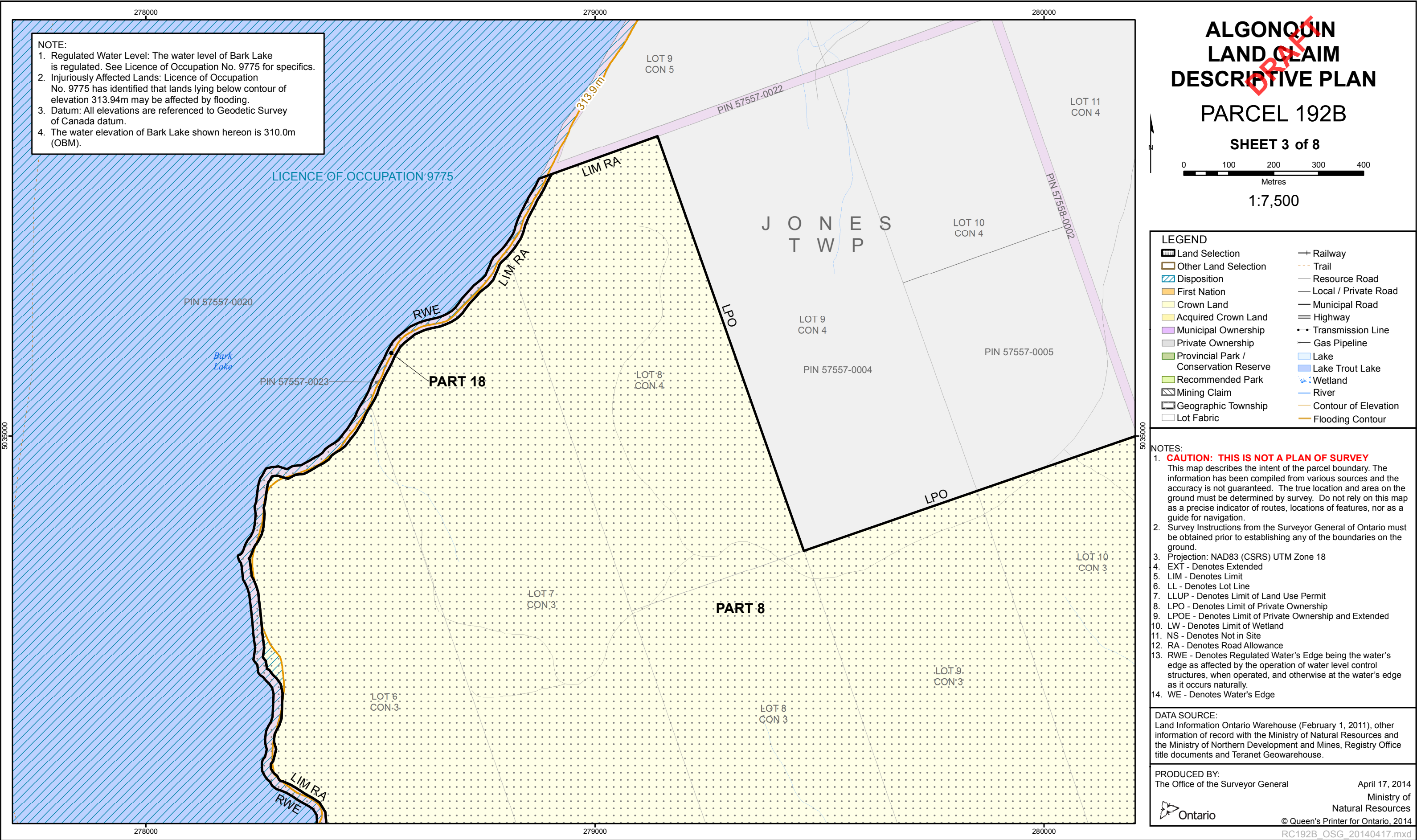

APPENDIX 5.1.1 - Proposed Settlement Lands

ALGONQUIN  
LAND CLAIM  
DESCRIPTIVE PLAN

PARCEL 192B

SHEET 4 of 8

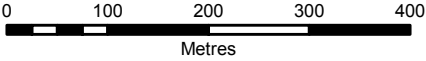

1:7,500

LEGEND

Land Selection	Railway
Other Land Selection	Trail
Disposition	Resource Road
First Nation	Local / Private Road
Crown Land	Municipal Road
Acquired Crown Land	Highway
Municipal Ownership	Transmission Line
Private Ownership	Gas Pipeline
Provincial Park / Conservation Reserve	Lake
Recommended Park	Lake Trout Lake
Mining Claim	Wetland
Geographic Township	River
Lot Fabric	Contour of Elevation
	Flooding Contour

NOTES:

- CAUTION: THIS IS NOT A PLAN OF SURVEY**  
This map describes the intent of the parcel boundary. The information has been compiled from various sources and the accuracy is not guaranteed. The true location and area on the ground must be determined by survey. Do not rely on this map as a precise indicator of routes, locations of features, nor as a guide for navigation.
- Survey Instructions from the Surveyor General of Ontario must be obtained prior to establishing any of the boundaries on the ground.
- Projection: NAD83 (CSRS) UTM Zone 18
- EXT - Denotes Extended
- LIM - Denotes Limit
- LL - Denotes Lot Line
- LLUP - Denotes Limit of Land Use Permit
- LPO - Denotes Limit of Private Ownership
- LPOE - Denotes Limit of Private Ownership and Extended
- LW - Denotes Limit of Wetland
- NS - Denotes Not in Site
- RA - Denotes Road Allowance
- RWE - Denotes Regulated Water's Edge being the water's edge as affected by the operation of water level control structures, when operated, and otherwise at the water's edge as it occurs naturally.
- WE - Denotes Water's Edge

DATA SOURCE:

Land Information Ontario Warehouse (February 1, 2011), other information of record with the Ministry of Natural Resources and the Ministry of Northern Development and Mines, Registry Office title documents and Teranet Geowarehouse.

PRODUCED BY:

The Office of the Surveyor General

April 17, 2014

Ministry of  
Natural Resources



© Queen's Printer for Ontario, 2014

RC192B\_OSG\_20140417.mxd

NOTE:

- Regulated Water Level: The water level of Bark Lake is regulated. See Licence of Occupation No. 9775 for specifics.
- Injurious Affected Lands: Licence of Occupation No. 9775 has identified that lands lying below contour of elevation 313.94m may be affected by flooding.
- Datum: All elevations are referenced to Geodetic Survey of Canada datum.
- The water elevation of Bark Lake shown hereon is 310.0m (OBM).

APPENDIX 5.1.1 - Proposed Settlement Lands

ALGONQUIN  
LAND CLAIM  
DESCRIPTIVE PLAN

PARCEL 192B

SHEET 5 of 8

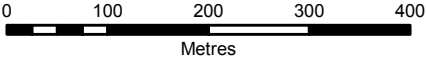

1:7,500

LEGEND

Land Selection	Railway
Other Land Selection	Trail
Disposition	Resource Road
First Nation	Local / Private Road
Crown Land	Municipal Road
Acquired Crown Land	Highway
Municipal Ownership	Transmission Line
Private Ownership	Gas Pipeline
Provincial Park / Conservation Reserve	Lake
Recommended Park	Lake Trout Lake
Mining Claim	Wetland
Geographic Township	River
Lot Fabric	Contour of Elevation
	Flooding Contour

NOTES:

- CAUTION: THIS IS NOT A PLAN OF SURVEY**  
This map describes the intent of the parcel boundary. The information has been compiled from various sources and the accuracy is not guaranteed. The true location and area on the ground must be determined by survey. Do not rely on this map as a precise indicator of routes, locations of features, nor as a guide for navigation.
- Survey Instructions from the Surveyor General of Ontario must be obtained prior to establishing any of the boundaries on the ground.
- Projection: NAD83 (CSRS) UTM Zone 18
- EXT - Denotes Extended
- LIM - Denotes Limit
- LL - Denotes Lot Line
- LLUP - Denotes Limit of Land Use Permit
- LPO - Denotes Limit of Private Ownership
- LPOE - Denotes Limit of Private Ownership and Extended
- LW - Denotes Limit of Wetland
- NS - Denotes Not in Site
- RA - Denotes Road Allowance
- RWE - Denotes Regulated Water's Edge being the water's edge as affected by the operation of water level control structures, when operated, and otherwise at the water's edge as it occurs naturally.
- WE - Denotes Water's Edge

DATA SOURCE:  
Land Information Ontario Warehouse (February 1, 2011), other information of record with the Ministry of Natural Resources and the Ministry of Northern Development and Mines, Registry Office title documents and Teranet Geowarehouse.

PRODUCED BY:  
The Office of the Surveyor General  
April 17, 2014  
Ministry of  
Natural Resources



© Queen's Printer for Ontario, 2014

RC192B\_OSG\_20140417.mxd

APPENDIX 5.1.1 - Proposed Settlement Lands

ALGONQUIN  
LAND CLAIM  
DESCRIPTIVE PLAN

PARCEL 192B

SHEET 6 of 8

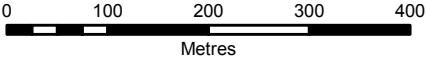

1:7,500

LEGEND

Land Selection	Railway
Other Land Selection	Trail
Disposition	Resource Road
First Nation	Local / Private Road
Crown Land	Municipal Road
Acquired Crown Land	Highway
Municipal Ownership	Transmission Line
Private Ownership	Gas Pipeline
Provincial Park / Conservation Reserve	Lake
Recommended Park	Lake Trout Lake
Mining Claim	Wetland
Geographic Township	River
Lot Fabric	Contour of Elevation
	Flooding Contour

NOTES:

- CAUTION: THIS IS NOT A PLAN OF SURVEY**  
This map describes the intent of the parcel boundary. The information has been compiled from various sources and the accuracy is not guaranteed. The true location and area on the ground must be determined by survey. Do not rely on this map as a precise indicator of routes, locations of features, nor as a guide for navigation.
- Survey Instructions from the Surveyor General of Ontario must be obtained prior to establishing any of the boundaries on the ground.
- Projection: NAD83 (CSRS) UTM Zone 18
- EXT - Denotes Extended
- LIM - Denotes Limit
- LL - Denotes Lot Line
- LLUP - Denotes Limit of Land Use Permit
- LPO - Denotes Limit of Private Ownership
- LPOE - Denotes Limit of Private Ownership and Extended
- LW - Denotes Limit of Wetland
- NS - Denotes Not in Site
- RA - Denotes Road Allowance
- RWE - Denotes Regulated Water's Edge being the water's edge as affected by the operation of water level control structures, when operated, and otherwise at the water's edge as it occurs naturally.
- WE - Denotes Water's Edge

DATA SOURCE:  
Land Information Ontario Warehouse (February 1, 2011), other information of record with the Ministry of Natural Resources and the Ministry of Northern Development and Mines, Registry Office title documents and Teranet Geowarehouse.

PRODUCED BY:  
The Office of the Surveyor General  
April 17, 2014  
Ministry of  
Natural Resources  
© Queen's Printer for Ontario, 2014



RC192B\_OSG\_20140417.mxd

NOTE:

- Regulated Water Level: The water level of Bark Lake is regulated. See Licence of Occupation No. 9775 for specifics.
- Injurious Affected Lands: Licence of Occupation No. 9775 has identified that lands lying below contour of elevation 313.94m may be affected by flooding.
- Datum: All elevations are referenced to Geodetic Survey of Canada datum.
- The water elevation of Bark Lake shown hereon is 310.0m (OBM).

APPENDIX 5.1.1 - Proposed Settlement Lands

ALGONQUIN  
LAND CLAIM  
DESCRIPTIVE PLAN

PARCEL 192B

SHEET 7 of 8

PART SCHEDULE						
Part #	Description	Area (ha)	Area Included (ha)	Area Not Included (ha)	Action	Comments
PART 1	Unpatented Crown Land	182.3	182.3		Patent	
PART 2		1.9	1.9			
PART 3		0.2	0.2			
PART 4		8.8	8.8			
PART 5		0.3	0.3			
PART 6		1.2	1.2			
PART 7		231.0	231.0			
PART 8		258.9	258.9			
PART 9	Unpatented Crown Land	8.6	8.6		Patent subject to reservation of right to flood	Licence of Occupation for flooding
PART 10		2.9	2.9			
PART 11		<0.1	<0.1			
PART 12		74.4	74.4			
PART 13	Unpatented Crown Land	79.9	79.9		Patent	
PART 14	Road Allowance	1.4	1.4		AOO have requested the RA	Parties to discuss with the Municipality the possibility of transfer of the RA. If Municipality agrees, patent subject to right to flood consistent with LO for flooding
PART 15	Road Allowance	0.5		0.5	Excluded	
PART 16		0.1		0.1		
PART 17		0.1		0.1		
PART 18	Road Allowance	6.0	6.0		AOO have requested the RA	Parties to discuss with the Municipality the possibility of transfer of the RA. If Municipality agrees, patent subject to right to flood consistent with LO for flooding
PART 19	Road Allowance	1.3		1.3	Excluded	
PART 20	Road Allowance	1.4	1.4		AOO have requested the RA	Parties to discuss with the Municipality the possibility of transfer of the RA. If Municipality agrees, patent subject to right to flood consistent with LO for flooding
PART 21		0.2	0.2			
PART 22	Road & Road Allowance	0.4		0.4	Excluded	This road provides access to adjacent private land
PART 23	Road	1.3		1.3	Excluded	This road provides access to adjacent private land
PART 24		0.1		0.1		

NOTE: Total Area as shown is the sum of areas of all parts, including those < 0.1 ha.

PRODUCED BY:  
The Office of the Surveyor General      April 17, 2014

 Ministry of  
Natural Resources  
© Queen's Printer for Ontario, 2014

APPENDIX 5.1.1 - Proposed Settlement Lands

PART SCHEDULE						
Part #	Description	Area (ha)	Area Included (ha)	Area Not Included (ha)	Action	Comments
PART 25	Road	0.1		0.1	Excluded	This road provides access to adjacent private land
PART 26		0.9		0.1		
PART 27	Road	1.2		1.2	Excluded	This road provides access to adjacent private land
PART 28		0.1		0.1		
PART 29	Road (Municipal)	2.1		2.1	Excluded	This public road provides access to adjacent private lands
PART 30	Road Allowance	0.5		0.5	Excluded	
PART 31	Road & Road Allowance	0.1		0.1	Excluded	This road provides access to adjacent private land
PART 32	Road Allowance	8.3		8.3	Excluded	
PART 33	Road Allowance	0.6	0.6		Patent subject to reservation of right to flood	Licence of Occupation for flooding
Total Area (ha)		877.0	859.9	16.3		
Total Area (ac)		2167.2	2125.0	40.2		

ALGONQUIN  
LAND CLAIM  
DESCRIPTIVE PLAN

PARCEL 192B

SHEET 8 of 8

NOTE: Total Area as shown is the sum of areas of all parts, including those < 0.1 ha.

PRODUCED BY:  
The Office of the Surveyor General      April 17, 2014

 Ontario      Ministry of  
Natural Resources  
© Queen's Printer for Ontario, 2014

APPENDIX 5.1.1 - Proposed Settlement Lands

Stakeholder Activities in Parcel 192B

Activity	Description	Status	Size of Area (ac)	Percent of Area Affected (%)
Bait Harvest Area	PE0179	Active	2167.0	8.1
Bear Management Area	PE-55A-012	Active	2135.5	5.0
Certificate of Approval	None known			
Conservation Authority	None			
Extractable Aggregate	None			
Forest Management Unit	780 - Ottawa Valley Forest			
Land Use Permit	LUP #1675-1006267 - Rec Camp			
Lease	None			
Licence of Occupation	OPG - LO #9775 on Bark Lake			
Mining Claim	None			
Mining Lease	None			
Research Plot	Biomass Study Permanent Sample Plot #A-100			
Resident Trapper	None			
Seed Area	None			
Trail	None			
Trapline Area	PE009	Active	2134.1	29.4
Wind Power Application	None			

The information included in this table is based on the best information as of August 1, 2013. Information may be subject to change.