

Appendix 5.3.3 - Area of Algonquin Interest

ALGONQUIN LAND CLAIM DESCRIPTIVE PLAN

PARCEL 184C

Sheet 1 of 9

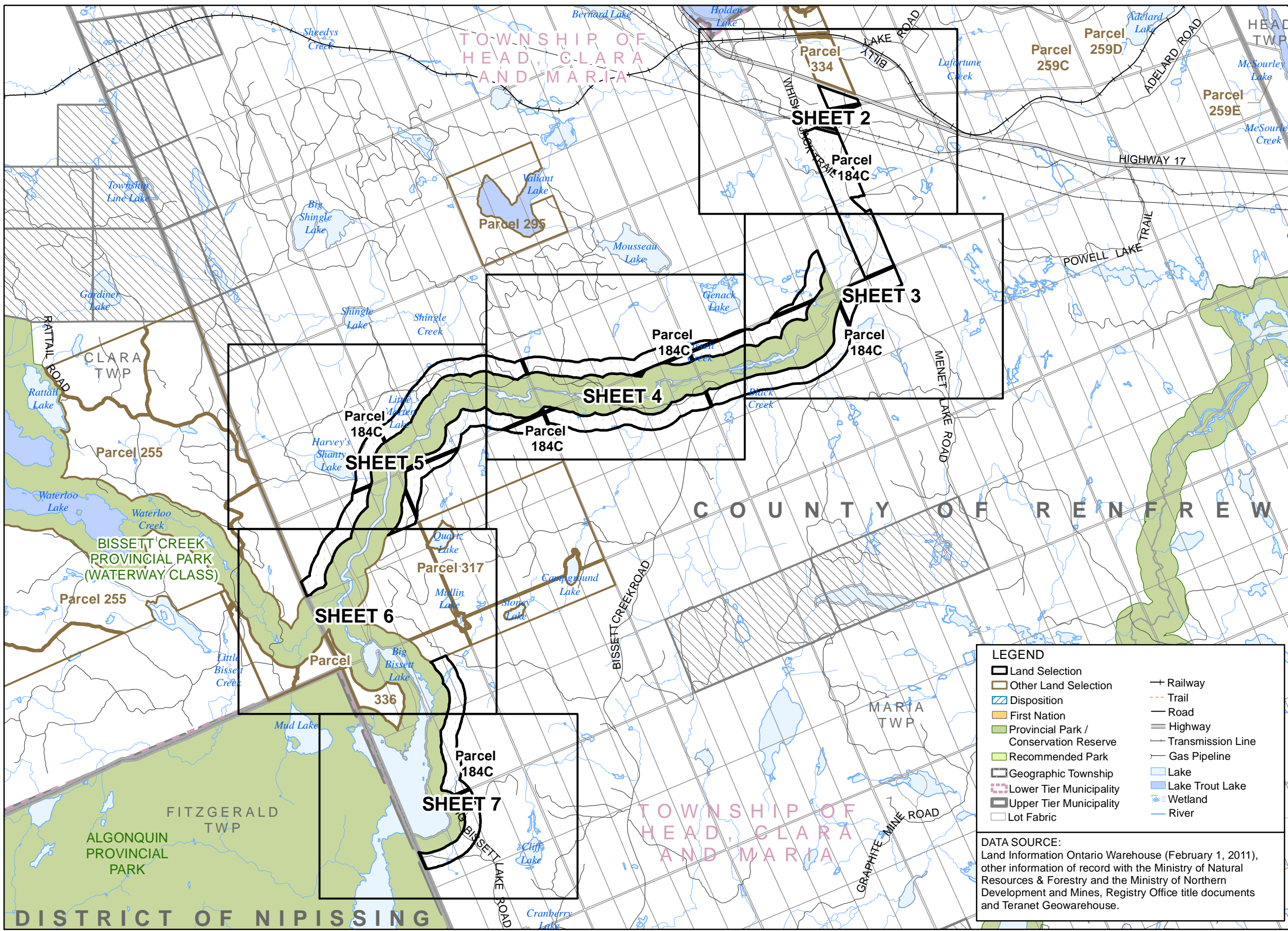
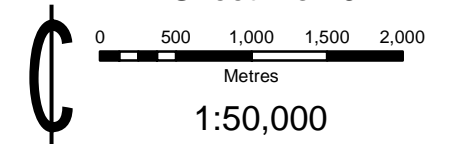

LEGEND

Land Selection	Railway
Other Land Selection	Trail
Disposition	Road
First Nation	Highway
Provincial Park / Conservation Reserve	Transmission Line
Recommended Park	Gas Pipeline
Geographic Township	Lake
Lower Tier Municipality	Lake Trout Lake
Upper Tier Municipality	Wetland
Lot Fabric	River

DATA SOURCE:
Land Information Ontario Warehouse (February 1, 2011), other information of record with the Ministry of Natural Resources & Forestry and the Ministry of Northern Development and Mines, Registry Office title documents and Teranet Geowarehouse.

- CAUTION: THIS IS NOT A PLAN OF SURVEY**
- This Descriptive Plan is a graphic illustration of the Settlement Lands identified in the Settlement Agreement of the Algonquin Land Claim. This plan is intended to illustrate the complex inter-relationships between the Settlement Lands and other previous dispositions and alienations of public lands and is necessary to prevent duplicate or overlapping tenure commitments on the same lands.
- This Descriptive Plan has been prepared from the best available information but without benefit of survey. The absolute and relative positional accuracy of the data shown hereon has not been verified. Discrepancies between different data sources are known to exist. Do not use this Plan as evidence of the location of legal boundaries, township lot fabric, features, or routes. Do not rely on this Plan to determine the extent of parcel areas, the existence of navigable bodies of water nor as a guide for navigation.
- Any sale, lease or other disposition of lands illustrated hereon made pursuant to the Settlement Agreement of the Algonquin Land Claim is limited to the extent of the un-alienated rights held by the Ministry of Natural Resources and every grant shall be subject to the provisions of the statute of the Bed of Navigable Waters Act, R.S.O. 1990, Chapter B.4.
- The boundary information must be read in conjunction with all Notes appearing in and on the Plan series and within the terms of the Settlement Agreement. Should the provisions contained on the Descriptive Plan be found to conflict with the terms contained within the Settlement Agreement the terms contained within the Settlement Agreement shall prevail. Nothing hereon contained, except the provision for the application of "The Bed of Navigable Waters Act" aforesaid, shall affect the interpretation which would, apart from this Descriptive Plan, be put upon the words of any letters patent hereafter issued under the Great Seal of the Province of Ontario, or of any lease or other conveyance, or of any contract heretofore or hereafter made under the direction of the Province of Ontario.
- Survey Instructions from the Surveyor General of Ontario must be obtained prior to establishing any of the boundaries on the ground.

PRODUCED BY:
The Office of the Surveyor General January 16, 2015

Ontario
Ministry of
Natural Resources & Forestry
© Queen's Printer for Ontario, 2015

Appendix 5.3.3 - Area of Algonquin Interest

ALGONQUIN LAND CLAIM DESCRIPTIVE PLAN PARCEL 184C

Sheet 2 of 9

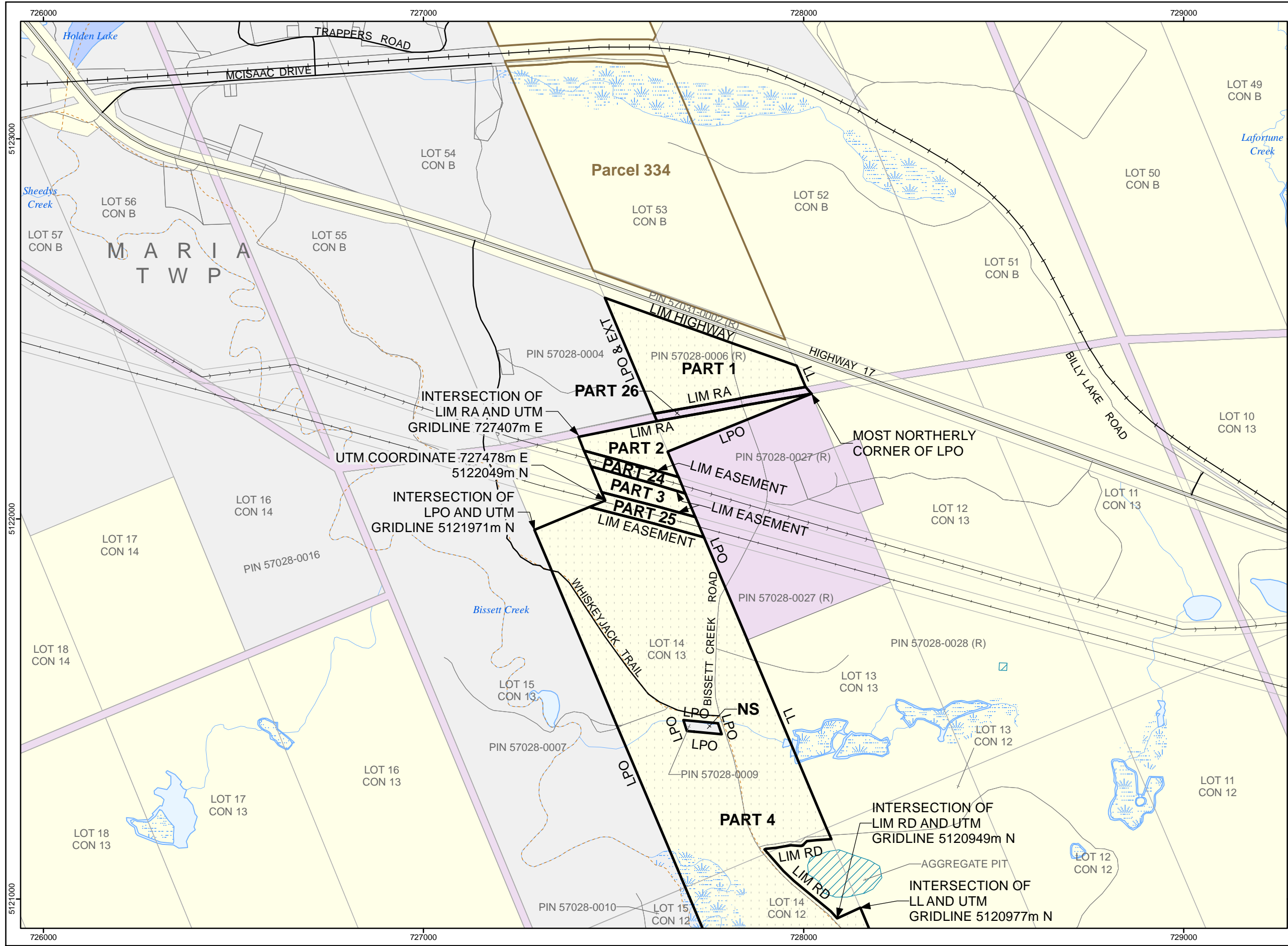
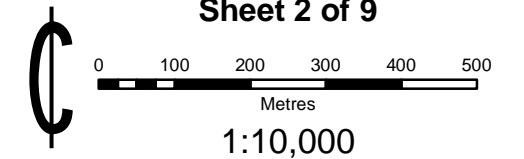

LEGEND

Land Selection	Railway
Other Land Selection	Trail
Disposition	Resource Road
First Nation	Local / Private Road
Crown Land	Municipal Road
Acquired Crown Land	Highway
Municipal Ownership	Transmission Line
Private Ownership	Gas Pipeline
Provincial Park / Conservation Reserve	Lake
Recommended Park	Lake Trout Lake
Mining Claim	Wetland
Geographic Township	River
Lot Fabric	Contour of Elevation
	Flooding Contour

- NOTES:**
- CAUTION: THIS IS NOT A PLAN OF SURVEY**
This map describes the intent of the parcel boundary. The information has been compiled from various sources and the accuracy is not guaranteed. The true location and area on the ground must be determined by survey. Do not rely on this map as a precise indicator of routes, locations of features, nor as a guide for navigation.
 - Survey Instructions from the Surveyor General of Ontario must be obtained prior to establishing any of the boundaries on the ground.
 - Projection: NAD83 (CSRS) UTM Zone 17
 - EXT - Denotes Extended
 - LIM - Denotes Limit
 - LL - Denotes Lot Line
 - LLUP - Denotes Limit of Land Use Permit
 - LPO - Denotes Limit of Private Ownership
 - LPOE - Denotes Limit of Private Ownership and Extended
 - LW - Denotes Limit of Wetland
 - NS - Denotes Not in Site
 - RA - Denotes Road Allowance
 - RWE - Denotes Regulated Water's Edge being the water's edge as affected by the operation of water level control structures, when operated, and otherwise at the water's edge as it occurs naturally.
 - WE - Denotes Water's Edge

DATA SOURCE:
Land Information Ontario Warehouse (February 1, 2011), other information of record with the Ministry of Natural Resources and the Ministry of Northern Development and Mines, Registry Office title documents and Teranet Geowarehouse.

PRODUCED BY:
The Office of the Surveyor General January 16, 2015
Ministry of Natural Resources & Forestry
© Queen's Printer for Ontario, 2015
Ontario

Appendix 5.3.3 - Area of Algonquin Interest

ALGONQUIN LAND CLAIM DESCRIPTIVE PLAN PARCEL 184C

Sheet 3 of 9

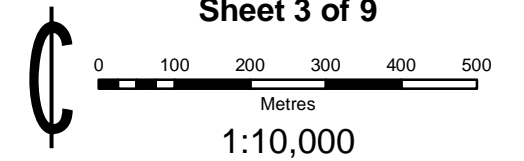

LEGEND	
	Land Selection
	Other Land Selection
	Disposition
	First Nation
	Crown Land
	Acquired Crown Land
	Municipal Ownership
	Private Ownership
	Provincial Park / Conservation Reserve
	Recommended Park
	Mining Claim
	Geographic Township
	Lot Fabric
	Railway
	Trail
	Resource Road
	Local / Private Road
	Municipal Road
	Highway
	Transmission Line
	Gas Pipeline
	Lake
	Lake Trout Lake
	Wetland
	River
	Contour of Elevation
	Flooding Contour

- NOTES:
- CAUTION: THIS IS NOT A PLAN OF SURVEY**
This map describes the intent of the parcel boundary. The information has been compiled from various sources and the accuracy is not guaranteed. The true location and area on the ground must be determined by survey. Do not rely on this map as a precise indicator of routes, locations of features, nor as a guide for navigation.
 - Survey Instructions from the Surveyor General of Ontario must be obtained prior to establishing any of the boundaries on the ground.
 - Projection: NAD83 (CSRS) UTM Zone 17
 - EXT - Denotes Extended
 - LIM - Denotes Limit
 - LL - Denotes Lot Line
 - LLUP - Denotes Limit of Land Use Permit
 - LPO - Denotes Limit of Private Ownership
 - LPOE - Denotes Limit of Private Ownership and Extended
 - LW - Denotes Limit of Wetland
 - NS - Denotes Not in Site
 - RA - Denotes Road Allowance
 - RWE - Denotes Regulated Water's Edge being the water's edge as affected by the operation of water level control structures, when operated, and otherwise at the water's edge as it occurs naturally.
 - WE - Denotes Water's Edge

DATA SOURCE:
Land Information Ontario Warehouse (February 1, 2011), other information of record with the Ministry of Natural Resources and the Ministry of Northern Development and Mines, Registry Office title documents and Teranet Geowarehouse.

PRODUCED BY:
The Office of the Surveyor General January 16, 2015
Ministry of Natural Resources & Forestry
© Queen's Printer for Ontario, 2015

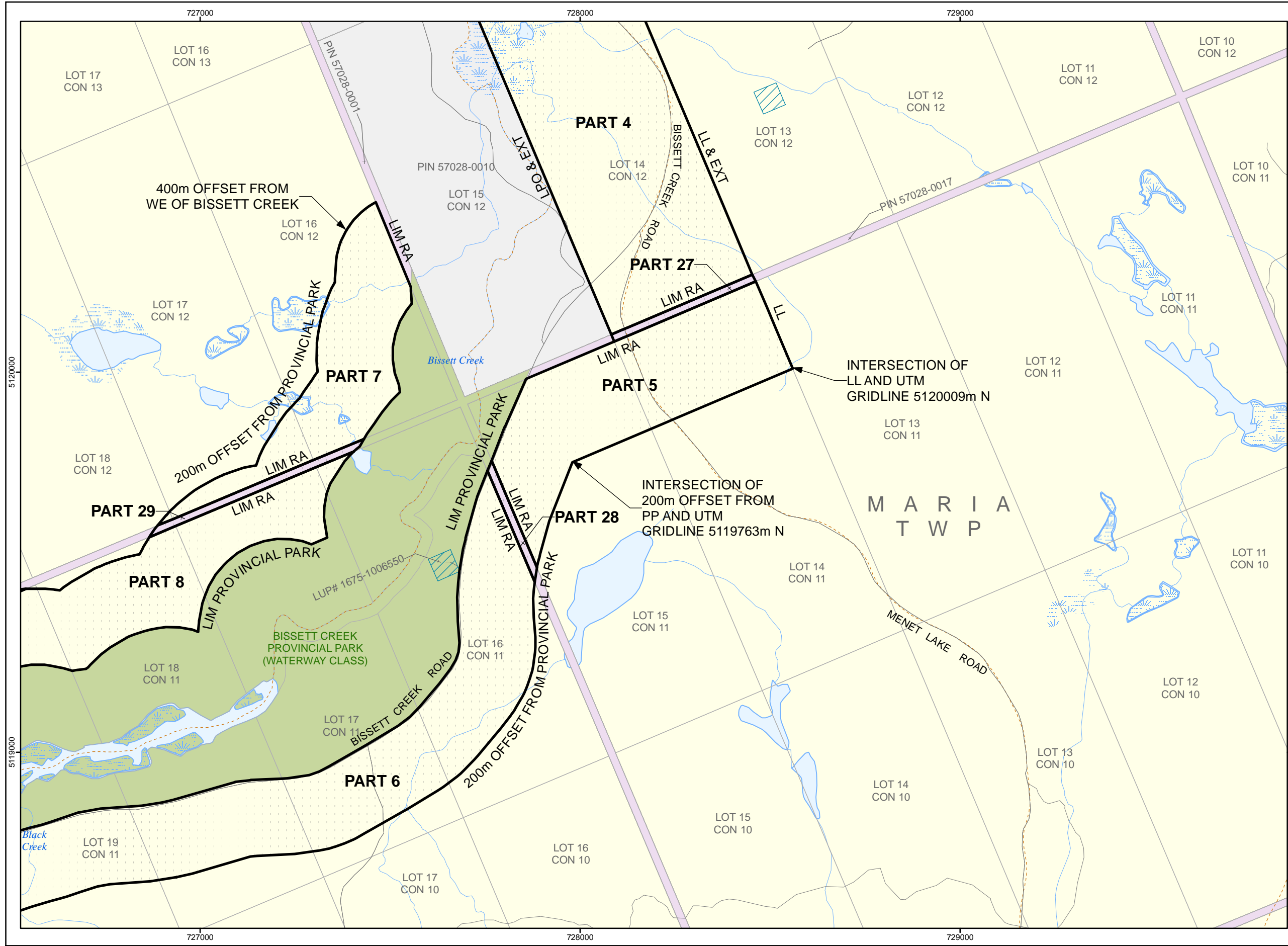

Appendix 5.3.3 - Area of Algonquin Interest

ALGONQUIN LAND CLAIM DESCRIPTIVE PLAN PARCEL 184C

Sheet 4 of 9

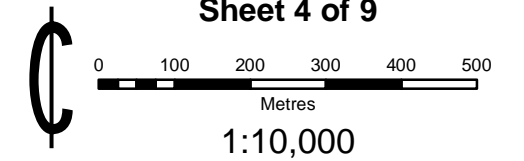

LEGEND

Land Selection	Railway
Other Land Selection	Trail
Disposition	Resource Road
First Nation	Local / Private Road
Crown Land	Municipal Road
Acquired Crown Land	Highway
Municipal Ownership	Transmission Line
Private Ownership	Gas Pipeline
Provincial Park / Conservation Reserve	Lake
Recommended Park	Lake Trout Lake
Mining Claim	Wetland
Geographic Township	River
Lot Fabric	Contour of Elevation
	Flooding Contour

NOTES:

- CAUTION: THIS IS NOT A PLAN OF SURVEY**
This map describes the intent of the parcel boundary. The information has been compiled from various sources and the accuracy is not guaranteed. The true location and area on the ground must be determined by survey. Do not rely on this map as a precise indicator of routes, locations of features, nor as a guide for navigation.
- Survey Instructions from the Surveyor General of Ontario must be obtained prior to establishing any of the boundaries on the ground.
- Projection: NAD83 (CSRS) UTM Zone 17
- EXT - Denotes Extended
- LIM - Denotes Limit
- LL - Denotes Lot Line
- LLUP - Denotes Limit of Land Use Permit
- LPO - Denotes Limit of Private Ownership
- LPOE - Denotes Limit of Private Ownership and Extended
- LW - Denotes Limit of Wetland
- NS - Denotes Not in Site
- RA - Denotes Road Allowance
- RWE - Denotes Regulated Water's Edge being the water's edge as affected by the operation of water level control structures, when operated, and otherwise at the water's edge as it occurs naturally.
- WE - Denotes Water's Edge

DATA SOURCE:
Land Information Ontario Warehouse (February 1, 2011), other information of record with the Ministry of Natural Resources and the Ministry of Northern Development and Mines, Registry Office title documents and Teranet Geowarehouse.

PRODUCED BY:
The Office of the Surveyor General January 16, 2015
Ministry of Natural Resources & Forestry
© Queen's Printer for Ontario, 2015



RC184C_OSG_20150116.mxd

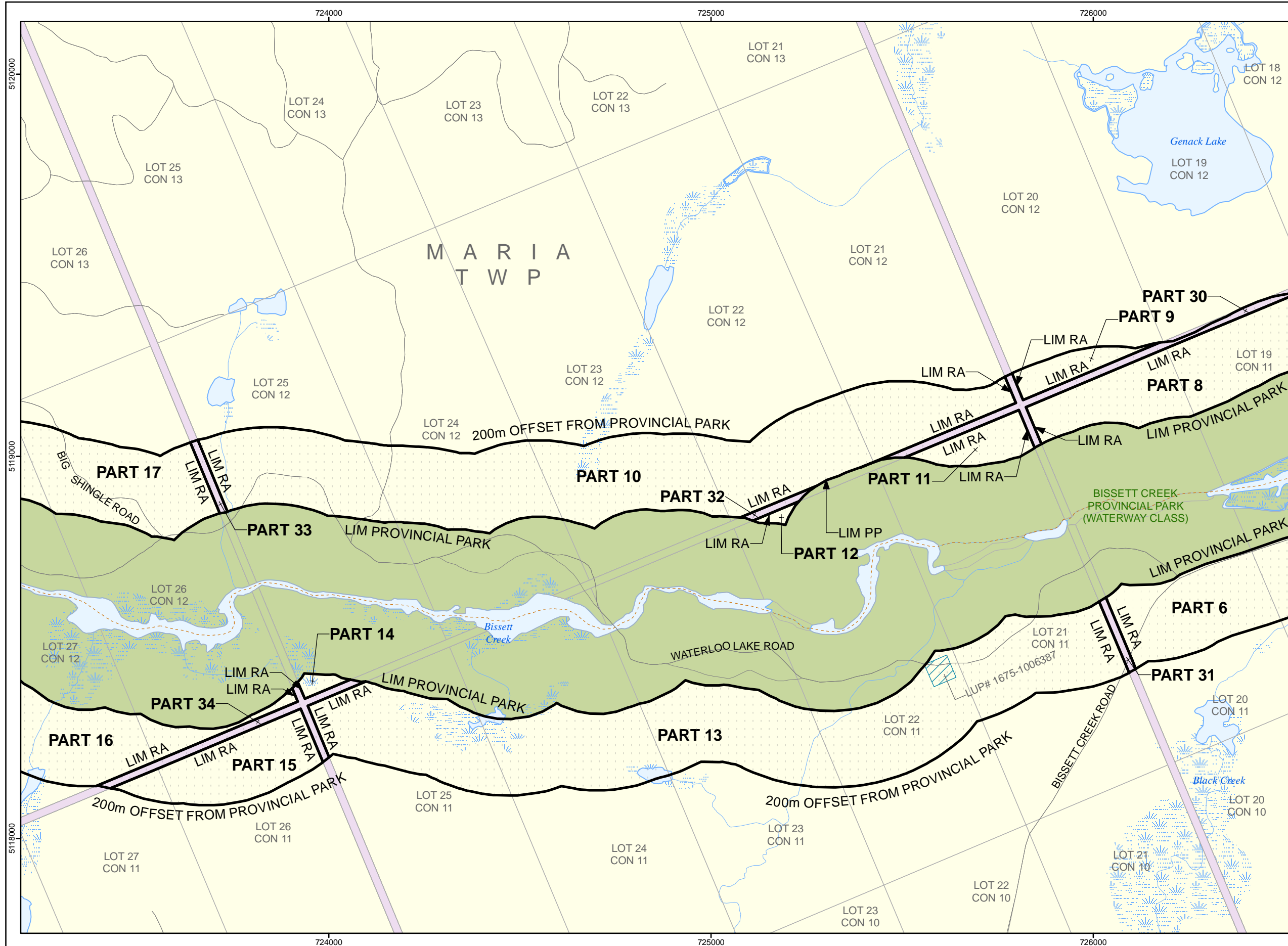

Appendix 5.3.3 - Area of Algonquin Interest

ALGONQUIN LAND CLAIM DESCRIPTIVE PLAN PARCEL 184C

Sheet 5 of 9

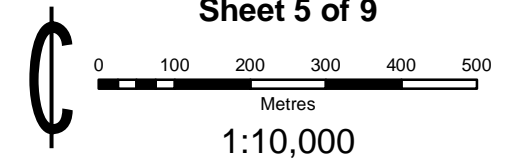

LEGEND	
	Land Selection
	Other Land Selection
	Disposition
	First Nation
	Crown Land
	Acquired Crown Land
	Municipal Ownership
	Private Ownership
	Provincial Park / Conservation Reserve
	Recommended Park
	Mining Claim
	Geographic Township
	Lot Fabric
	Railway
	Trail
	Resource Road
	Local / Private Road
	Municipal Road
	Highway
	Transmission Line
	Gas Pipeline
	Lake
	Lake Trout Lake
	Wetland
	River
	Contour of Elevation
	Flooding Contour

- NOTES:**
- CAUTION: THIS IS NOT A PLAN OF SURVEY**
This map describes the intent of the parcel boundary. The information has been compiled from various sources and the accuracy is not guaranteed. The true location and area on the ground must be determined by survey. Do not rely on this map as a precise indicator of routes, locations of features, nor as a guide for navigation.
 - Survey Instructions from the Surveyor General of Ontario must be obtained prior to establishing any of the boundaries on the ground.
 - Projection: NAD83 (CSRS) UTM Zone 17
 - EXT - Denotes Extended
 - LIM - Denotes Limit
 - LL - Denotes Lot Line
 - LLUP - Denotes Limit of Land Use Permit
 - LPO - Denotes Limit of Private Ownership
 - LPOE - Denotes Limit of Private Ownership and Extended
 - LW - Denotes Limit of Wetland
 - NS - Denotes Not in Site
 - RA - Denotes Road Allowance
 - RWE - Denotes Regulated Water's Edge being the water's edge as affected by the operation of water level control structures, when operated, and otherwise at the water's edge as it occurs naturally.
 - WE - Denotes Water's Edge

DATA SOURCE:
Land Information Ontario Warehouse (February 1, 2011), other information of record with the Ministry of Natural Resources and the Ministry of Northern Development and Mines, Registry Office title documents and Teranet Geowarehouse.

PRODUCED BY:
The Office of the Surveyor General
January 16, 2015
Ministry of Natural Resources & Forestry
© Queen's Printer for Ontario, 2015

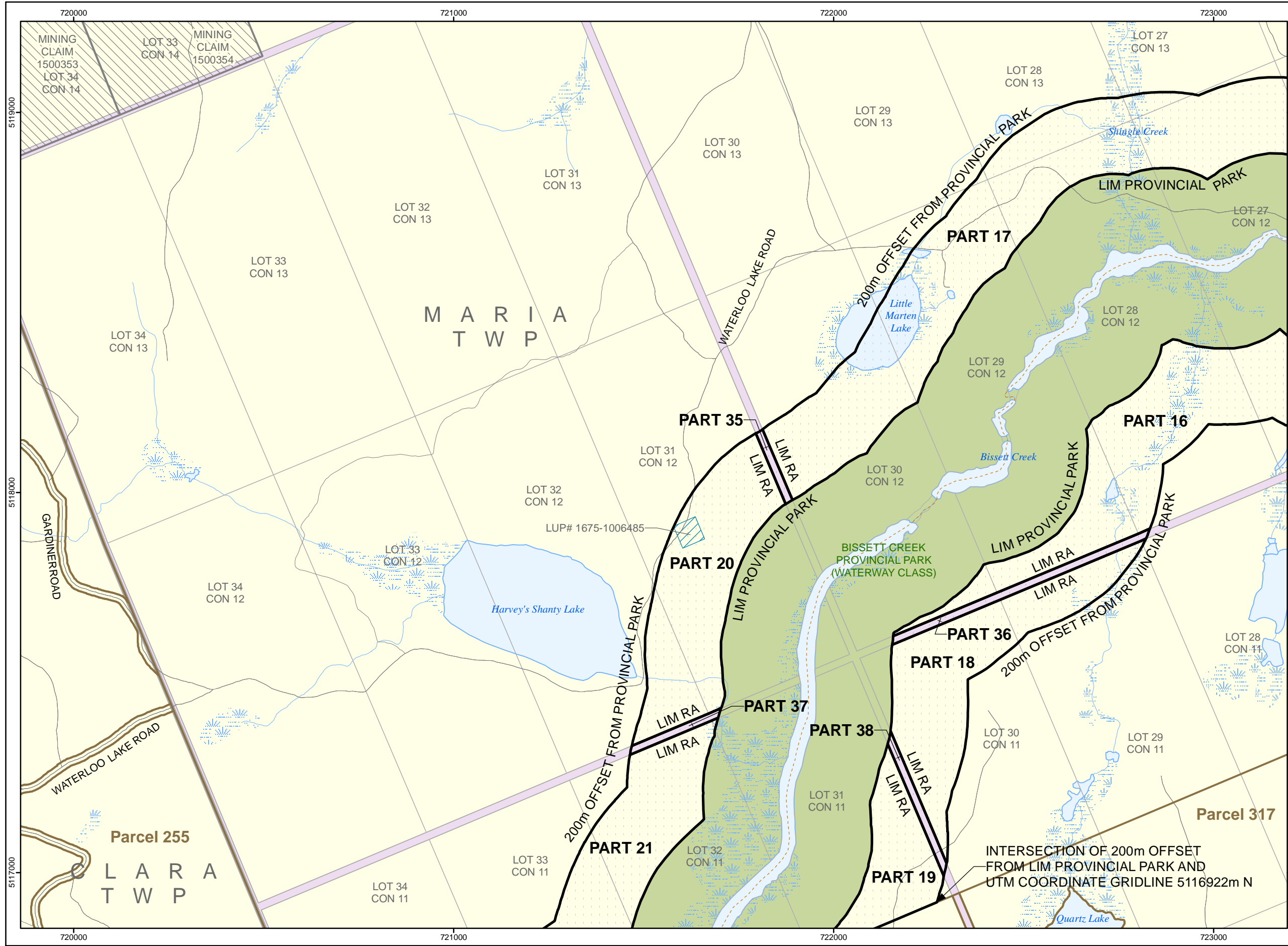

Appendix 5.3.3 - Area of Algonquin Interest

ALGONQUIN LAND CLAIM DESCRIPTIVE PLAN PARCEL 184C

Sheet 6 of 9

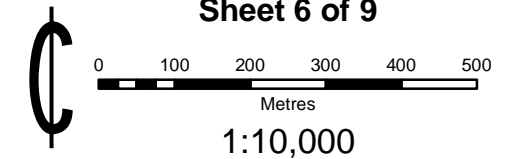

LEGEND

Land Selection	Railway
Other Land Selection	Trail
Disposition	Resource Road
First Nation	Local / Private Road
Crown Land	Municipal Road
Acquired Crown Land	Highway
Municipal Ownership	Transmission Line
Private Ownership	Gas Pipeline
Provincial Park / Conservation Reserve	Lake
Recommended Park	Lake Trout Lake
Mining Claim	Wetland
Geographic Township	River
Lot Fabric	Contour of Elevation
	Flooding Contour

NOTES:

- CAUTION: THIS IS NOT A PLAN OF SURVEY**
This map describes the intent of the parcel boundary. The information has been compiled from various sources and the accuracy is not guaranteed. The true location and area on the ground must be determined by survey. Do not rely on this map as a precise indicator of routes, locations of features, nor as a guide for navigation.
- Survey Instructions from the Surveyor General of Ontario must be obtained prior to establishing any of the boundaries on the ground.
- Projection: NAD83 (CSRS) UTM Zone 17
- EXT - Denotes Extended
- LIM - Denotes Limit
- LL - Denotes Lot Line
- LLUP - Denotes Limit of Land Use Permit
- LPO - Denotes Limit of Private Ownership
- LPOE - Denotes Limit of Private Ownership and Extended
- LW - Denotes Limit of Wetland
- NS - Denotes Not in Site
- RA - Denotes Road Allowance
- RWE - Denotes Regulated Water's Edge being the water's edge as affected by the operation of water level control structures, when operated, and otherwise at the water's edge as it occurs naturally.
- WE - Denotes Water's Edge

DATA SOURCE:
Land Information Ontario Warehouse (February 1, 2011), other information of record with the Ministry of Natural Resources and the Ministry of Northern Development and Mines, Registry Office title documents and Teranet Geowarehouse.

PRODUCED BY:
The Office of the Surveyor General January 16, 2015
Ministry of Natural Resources & Forestry
© Queen's Printer for Ontario, 2015

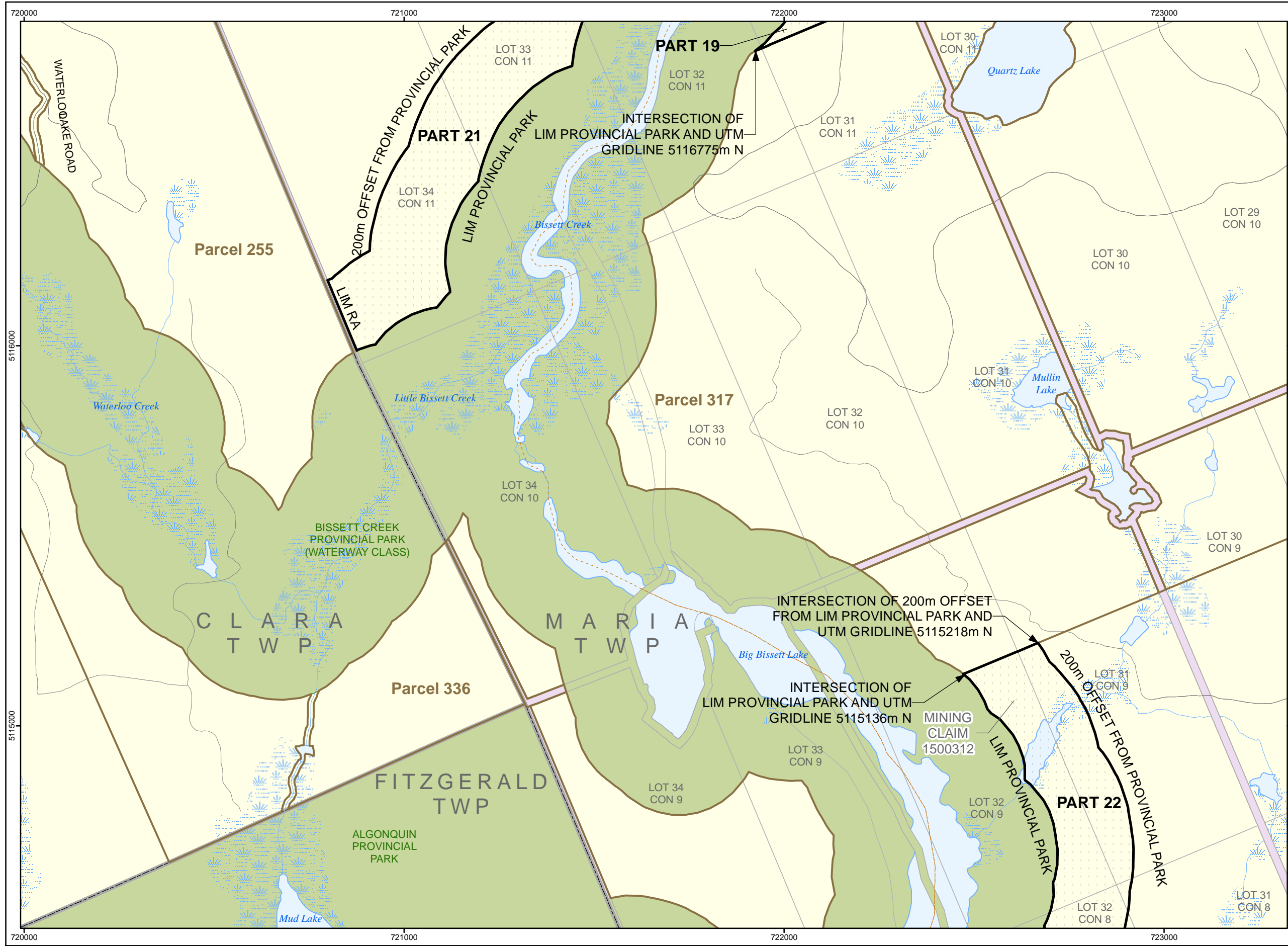

Appendix 5.3.3 - Area of Algonquin Interest

ALGONQUIN LAND CLAIM DESCRIPTIVE PLAN PARCEL 184C

Sheet 7 of 9

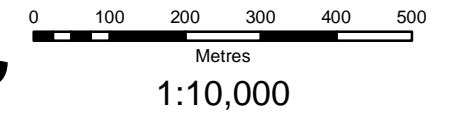

LEGEND	
	Land Selection
	Other Land Selection
	Disposition
	First Nation
	Crown Land
	Acquired Crown Land
	Municipal Ownership
	Private Ownership
	Provincial Park / Conservation Reserve
	Recommended Park
	Mining Claim
	Geographic Township
	Lot Fabric
	Railway
	Trail
	Resource Road
	Local / Private Road
	Municipal Road
	Highway
	Transmission Line
	Gas Pipeline
	Lake
	Lake Trout Lake
	Wetland
	River
	Contour of Elevation
	Flooding Contour

- NOTES:
- CAUTION: THIS IS NOT A PLAN OF SURVEY**
This map describes the intent of the parcel boundary. The information has been compiled from various sources and the accuracy is not guaranteed. The true location and area on the ground must be determined by survey. Do not rely on this map as a precise indicator of routes, locations of features, nor as a guide for navigation.
 - Survey Instructions from the Surveyor General of Ontario must be obtained prior to establishing any of the boundaries on the ground.
 - Projection: NAD83 (CSRS) UTM Zone 17
 - EXT - Denotes Extended
 - LIM - Denotes Limit
 - LL - Denotes Lot Line
 - LLUP - Denotes Limit of Land Use Permit
 - LPO - Denotes Limit of Private Ownership
 - LPOE - Denotes Limit of Private Ownership and Extended
 - LW - Denotes Limit of Wetland
 - NS - Denotes Not in Site
 - RA - Denotes Road Allowance
 - RWE - Denotes Regulated Water's Edge being the water's edge as affected by the operation of water level control structures, when operated, and otherwise at the water's edge as it occurs naturally.
 - WE - Denotes Water's Edge

DATA SOURCE:
Land Information Ontario Warehouse (February 1, 2011), other information of record with the Ministry of Natural Resources and the Ministry of Northern Development and Mines, Registry Office title documents and Teranet Geowarehouse.

PRODUCED BY:
The Office of the Surveyor General January 16, 2015
Ministry of Natural Resources & Forestry
© Queen's Printer for Ontario, 2015



RC184C_OSG_20150116.mxd

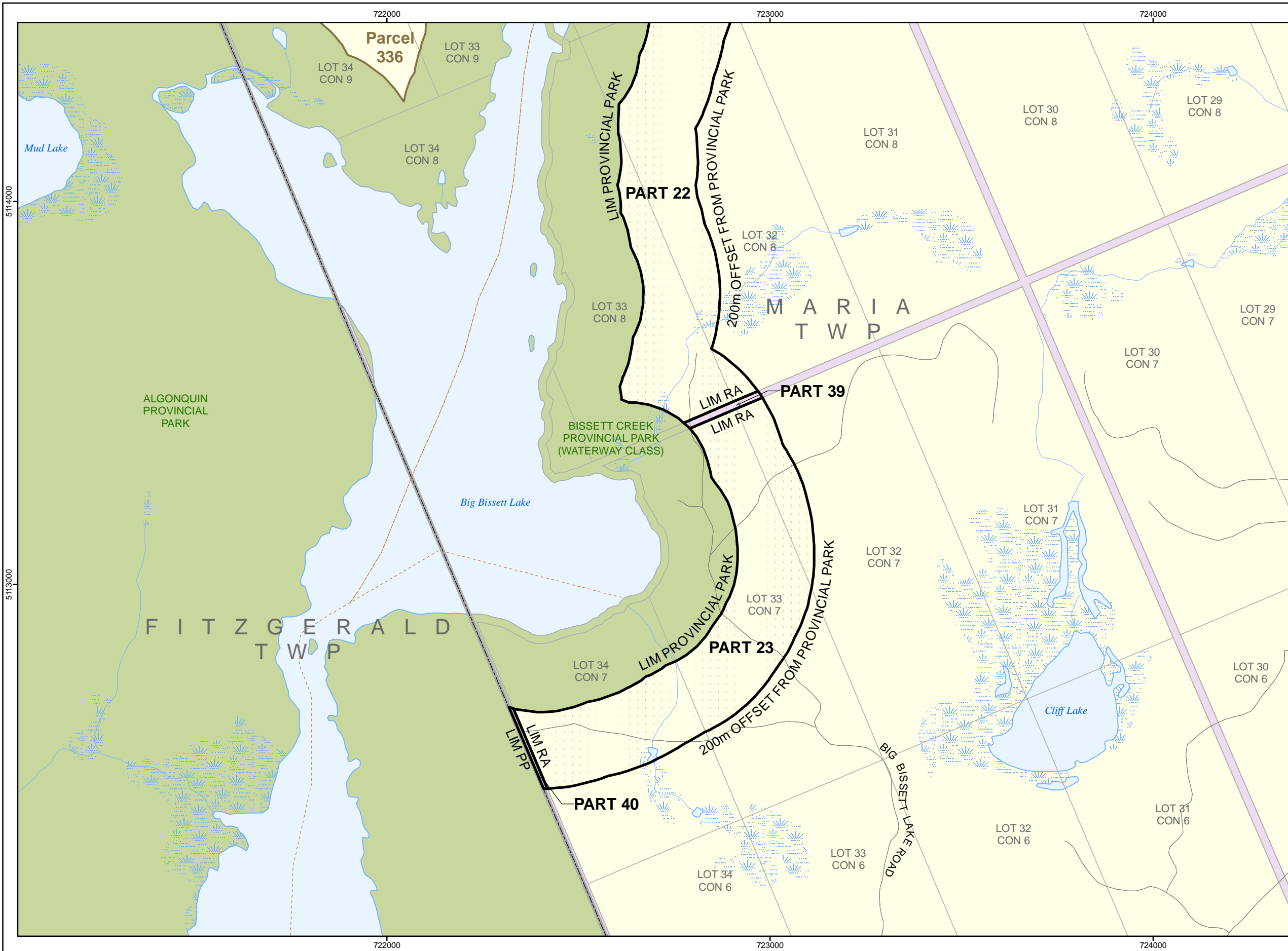

Appendix 5.3.3 - Area of Algonquin Interest

ALGONQUIN LAND CLAIM DESCRIPTIVE PLAN

PARCEL 184C

SHEET 8 of 9

PART SCHEDULE						
Part #	Description	Area (ha)	Area Included within Algonquin Interest in Crown Land (ha)	Area Excluded from Algonquin Interest in Crown Land (ha)	Action	Comments
PART 1	Unpatented Crown Land	7.7	7.7		Negotiate Crown Land Management Agreement for Areas of Algonquin Interest	Algonquin Interest in Crown Land
PART 2		3.8	3.8			
PART 3		1.4	1.4			
PART 4		76.7	76.7			
PART 5		21.2	21.2			
PART 6		45.7	45.7			
PART 7		14.6	14.6			
PART 8		28.1	28.1			
PART 9		2.0	2.0			
PART 10		40.2	40.2			
PART 11		2.5	2.5			
PART 12		0.3	0.3			
PART 13		44.0	44.0			
PART 14		0.5	0.5			
PART 15		6.9	6.9			
PART 16		26.3	26.3			
PART 17		45.4	45.4			
PART 18		14.0	14.0			
PART 19		6.8	6.8			
PART 20		15.2	15.2			
PART 21		31.3	31.3			
PART 22		38.2	38.2			
PART 23		26.0	26.0			
PART 24	Easement (Pipeline)	0.9		0.9	Negotiate Crown Land Management Agreement for Areas of Algonquin Interest	Algonquin Interest in Crown Land
PART 25	Easement (Hydro Electric Power)	1.2		1.2	Negotiate Crown Land Management Agreement for Areas of Algonquin Interest	Algonquin Interest in Crown Land

NOTE: Total Area as shown is the sum of areas of all parts, including those < 0.1 ha.

PRODUCED BY:
The Office of the Surveyor General January 16, 2015



Ministry of
Natural Resources & Forestry
© Queen's Printer for Ontario, 2015

Appendix 5.3.3 - Area of Algonquin Interest

PART SCHEDULE						
Part #	Description	Area (ha)	Area Included within Algonquin Interest in Crown Land (ha)	Area Excluded from Algonquin Interest in Crown Land (ha)	Action	Comments
PART 26	Road Allowance	0.8		0.8	Excluded	Under Municipal Jurisdiction
PART 27		0.8		0.8		
PART 28		0.6		0.6		
PART 29		1.2		1.2		
PART 30		2.5		2.5		
PART 31		0.4		0.4		
PART 32		0.3		0.3		
PART 33		0.4		0.4		
PART 34		1.8		1.8		
PART 35		0.4		0.4		
PART 36		1.5		1.5		
PART 37		0.5		0.5		
PART 38		0.8		0.8		
PART 39		0.4		0.4		
PART 40		0.2		0.2		
Total Area (ha)		513.5	498.7	14.8		
Total Area (ac)		1268.9	1232.2	36.7		

ALGONQUIN LAND CLAIM DESCRIPTIVE PLAN

PARCEL 184C

SHEET 9 of 9

NOTE: Total Area as shown is the sum of areas of all parts, including those < 0.1 ha.

PRODUCED BY:
The Office of the Surveyor General January 16, 2015



Ministry of
Natural Resources & Forestry
© Queen's Printer for Ontario, 2015

RC184C_PartSchedule.xls

“Easements”: The types of originating Crown tenure documents that authorize the “Communication”, “Pipeline” and “Hydro Electric Power” corridors shown hereon vary. In the broad context of the types of tenure on Crown land, all such corridors have been identified on this Descriptive Plan as being “easements”. Contact the appropriate MNR District Office if specific Crown tenure corridor information is required.

Appendix 5.3.3 - Area of Algonquin Interest

Stakeholder Activities in Parcel 184C

Activity	Description	Status	Size of Area (ac)	Percent of Area Affected (%)
Bait Harvest Area	PE0102	Inactive	609.3	4.0
Bait Harvest Area	PE0103	Inactive	21.6	0.3
Bait Harvest Area	PE0108	Active	220.0	0.6
Bait Harvest Area	PE0113	Inactive	418.2	6.4
Bear Management Area	PE-48-010	Active	143.1	2.0
Bear Management Area	PE-48-015	Active	1126.0	0.7
Certificate of Approval	None			
Conservation Authority Area	None			
Extractable Aggregate	MTO First Right of Refusal - Lot 18, Con 11, Maria Twp			
Forest Management Unit	780 - Ottawa Valley Forest			
Land Use Permit	Hydro One Transmission Line Province wide LUP			
Land Use Permit	LUP #1675-1006387 - Rec Camp			
Land Use Permit	LUP #1675-1006485 - Rec Camp			
Land Use Permit	LUP #1675-1006550 - Rec Camp			
Lease	None			
Licence of Occupation	None			
Mining Claim	None			
Mining Lease	None			
Order-in-Council	None			
Research Plot	None			
Resident Trapper	None			
Seed Area	None			
Trail	OFSC Snowmobile Trails			
Trapline Area	PE031	Active	1044.0	3.6
Wind Power Application	None			

The information included in this table is based on the best information as of August 1, 2013. Information may be subject to change.