

Appendix 5.1.1 - Proposed Settlement Lands (Parcel 178C), Section 5.3.1 - Easement (Parcel 178Ce)

**ALGONQUIN
LAND CLAIM
DESCRIPTIVE PLAN**

**PARCEL 178C &
PARCEL 178Ce**

Sheet 1 of 7

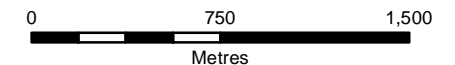

1:30,000

1. **CAUTION: THIS IS NOT A PLAN OF SURVEY**
2. This Descriptive Plan is a graphic illustration of the Settlement Lands identified in the Settlement Agreement of the Algonquin Land Claim. This plan is intended to illustrate the complex inter-relationships between the Settlement Lands and other previous dispositions and alienations of public lands and is necessary to prevent duplicate or overlapping tenure commitments on the same lands.
3. This Descriptive Plan has been prepared from the best available information but without benefit of survey. The absolute and relative positional accuracy of the data shown hereon has not been verified. Discrepancies between different data sources are known to exist. Do not use this Plan as evidence of the location of legal boundaries, township lot fabric, features, or routes. Do not rely on this Plan to determine the extent of parcel areas, the existence of navigable bodies of water nor as a guide for navigation.
4. Any sale, lease or other disposition of lands illustrated hereon made pursuant to the Settlement Agreement of the Algonquin Land Claim is limited to the extent of the un-alienated rights held by the Ministry of Natural Resources and every grant shall be subject to the provisions of the statute of the Bed of Navigable Waters Act, R.S.O. 1990, Chapter B.4.
5. The boundary information must be read in conjunction with all Notes appearing in and on the Plan series and within the terms of the Settlement Agreement. Should the provisions contained on the Descriptive Plan be found to conflict with the terms contained within the Settlement Agreement the terms contained within the Settlement Agreement shall prevail. Nothing hereon contained, except the provision for the application of "The Bed of Navigable Waters Act" aforesaid, shall affect the interpretation which would, apart from this Descriptive Plan, be put upon the words of any letters patent hereafter issued under the Great Seal of the Province of Ontario, or of any lease or other conveyance, or of any contract heretofore or hereafter made under the direction of the Province of Ontario.
6. Survey Instructions from the Surveyor General of Ontario must be obtained prior to establishing any of the boundaries on the ground.

PRODUCED BY:
The Office of the Surveyor General December 17, 2014



Ministry of
Natural Resources & Forestry
© Queen's Printer for Ontario, 2014

Region3_z18_Key_Maps.mxd

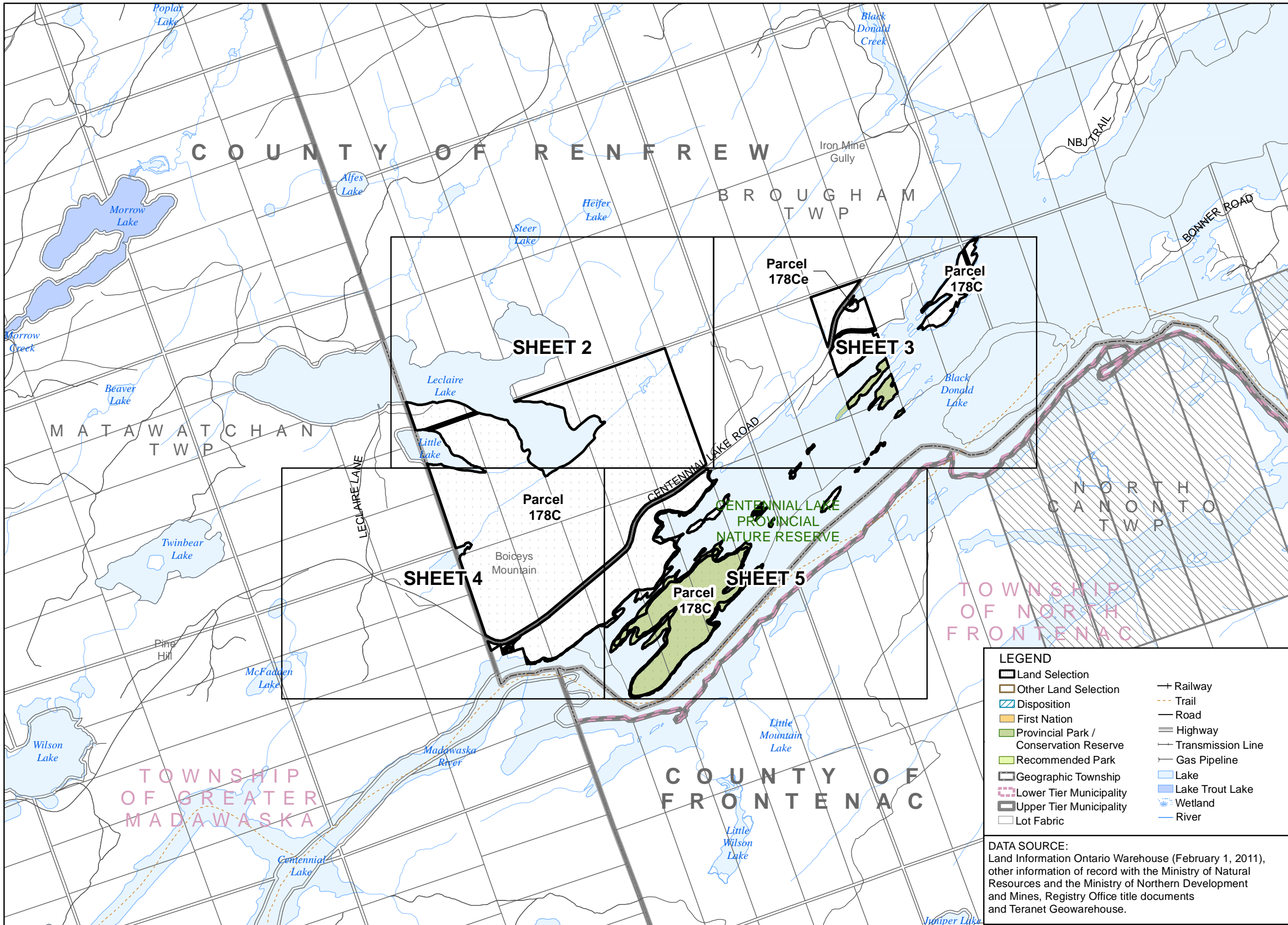

LEGEND

Land Selection	Railway
Other Land Selection	Trail
Disposition	Road
First Nation	Highway
Provincial Park / Conservation Reserve	Transmission Line
Recommended Park	Gas Pipeline
Geographic Township	Lake
Lower Tier Municipality	Lake Trout Lake
Upper Tier Municipality	Wetland
Lot Fabric	River

DATA SOURCE:
Land Information Ontario Warehouse (February 1, 2011), other information of record with the Ministry of Natural Resources and the Ministry of Northern Development and Mines, Registry Office title documents and Teranet Geowarehouse.

Appendix 5.1.1 - Proposed Settlement Lands (Parcel 178C), Section 5.3.1 - Easement (Parcel 178Ce)

ALGONQUIN LAND CLAIM DESCRIPTIVE PLAN

PARCEL 178C & PARCEL 178Ce

SHEET 2 of 7

0 125 250
Metres
1:7,500

LEGEND

Land Selection	Railway
Other Land Selection	Trail
Disposition	Resource Road
First Nation	Local / Private Road
Crown Land	Municipal Road
Acquired Crown Land	Highway
Municipal Ownership	Transmission Line
Private Ownership	Gas Pipeline
Provincial Park / Conservation Reserve	Lake
Recommended Park	Lake Trout Lake
Mining Claim	Wetland
Geographic Township	River
Lot Fabric	Contour of Elevation
	Flooding Contour

- NOTES:**
- CAUTION: THIS IS NOT A PLAN OF SURVEY**
This map describes the intent of the parcel boundary. The information has been compiled from various sources and the accuracy is not guaranteed. The true location and area on the ground must be determined by survey. Do not rely on this map as a precise indicator of routes, locations of features, nor as a guide for navigation.
 - Survey Instructions from the Surveyor General of Ontario must be obtained prior to establishing any of the boundaries on the ground.
 - Projection: NAD83 (CSRS) UTM Zone 18
 - EXT - Denotes Extended
 - LIM - Denotes Limit
 - LL - Denotes Lot Line
 - LLUP - Denotes Limit of Land Use Permit
 - LPO - Denotes Limit of Private Ownership
 - LPOE - Denotes Limit of Private Ownership and Extended
 - LW - Denotes Limit of Wetland
 - NS - Denotes Not in Site
 - RA - Denotes Road Allowance
 - RWE - Denotes Regulated Water's Edge being the water's edge as affected by the operation of water level control structures, when operated, and otherwise at the water's edge as it occurs naturally.
 - WE - Denotes Water's Edge

DATA SOURCE:
Land Information Ontario Warehouse (February 1, 2011), other information of record with the Ministry of Natural Resources and the Ministry of Northern Development and Mines, Registry Office title documents and Teranet Geowarehouse.

PRODUCED BY:
The Office of the Surveyor General December 17, 2014
Ministry of Natural Resources & Forestry
© Queen's Printer for Ontario, 2014

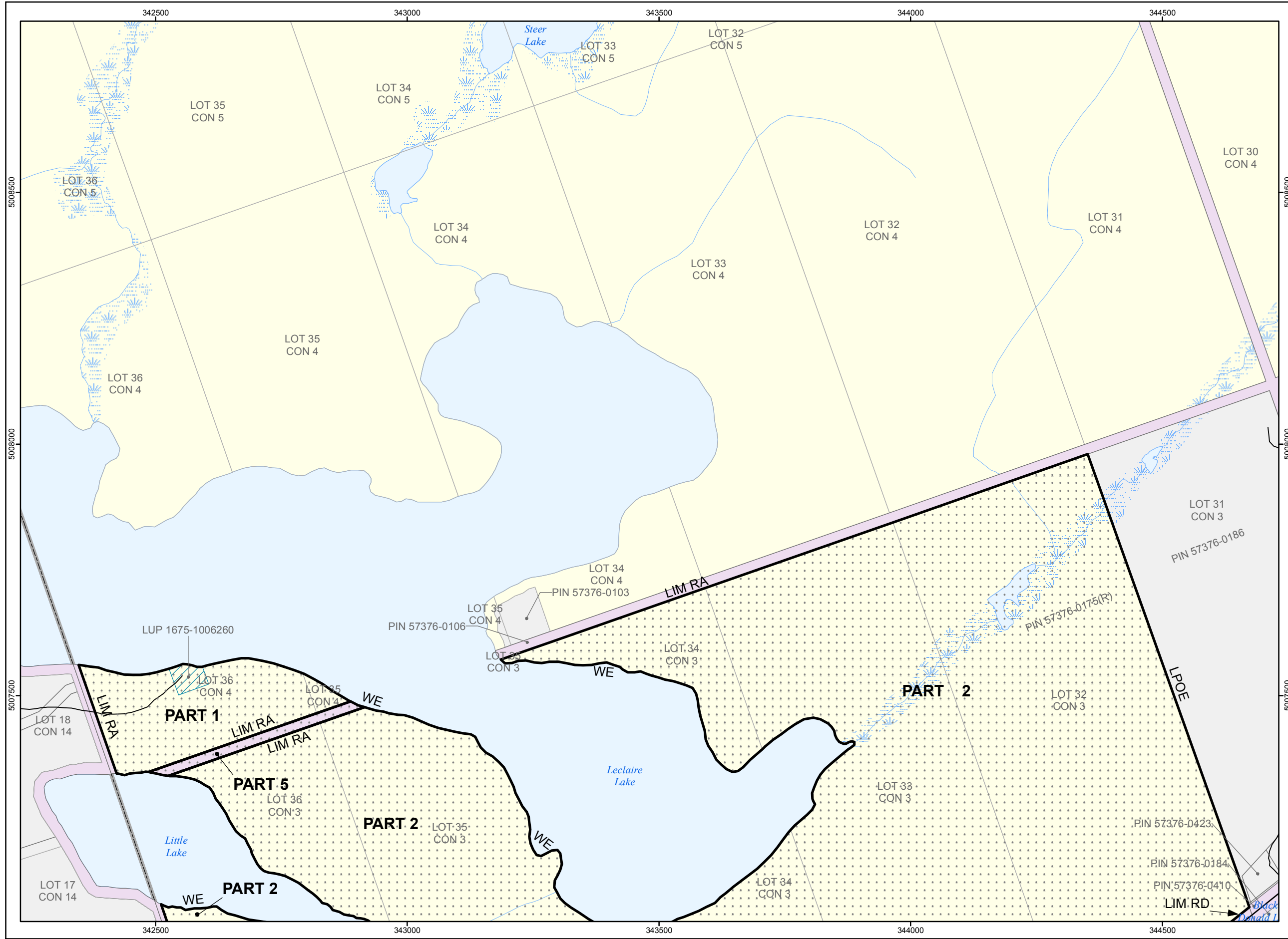

Appendix 5.1.1 - Proposed Settlement Lands (Parcel 178C), Section 5.3.1 - Easement (Parcel 178Ce)

ALGONQUIN LAND CLAIM DESCRIPTIVE PLAN

PARCEL 178C & PARCEL 178Ce

SHEET 3 of 7

0 125 250
Metres
1:7,500

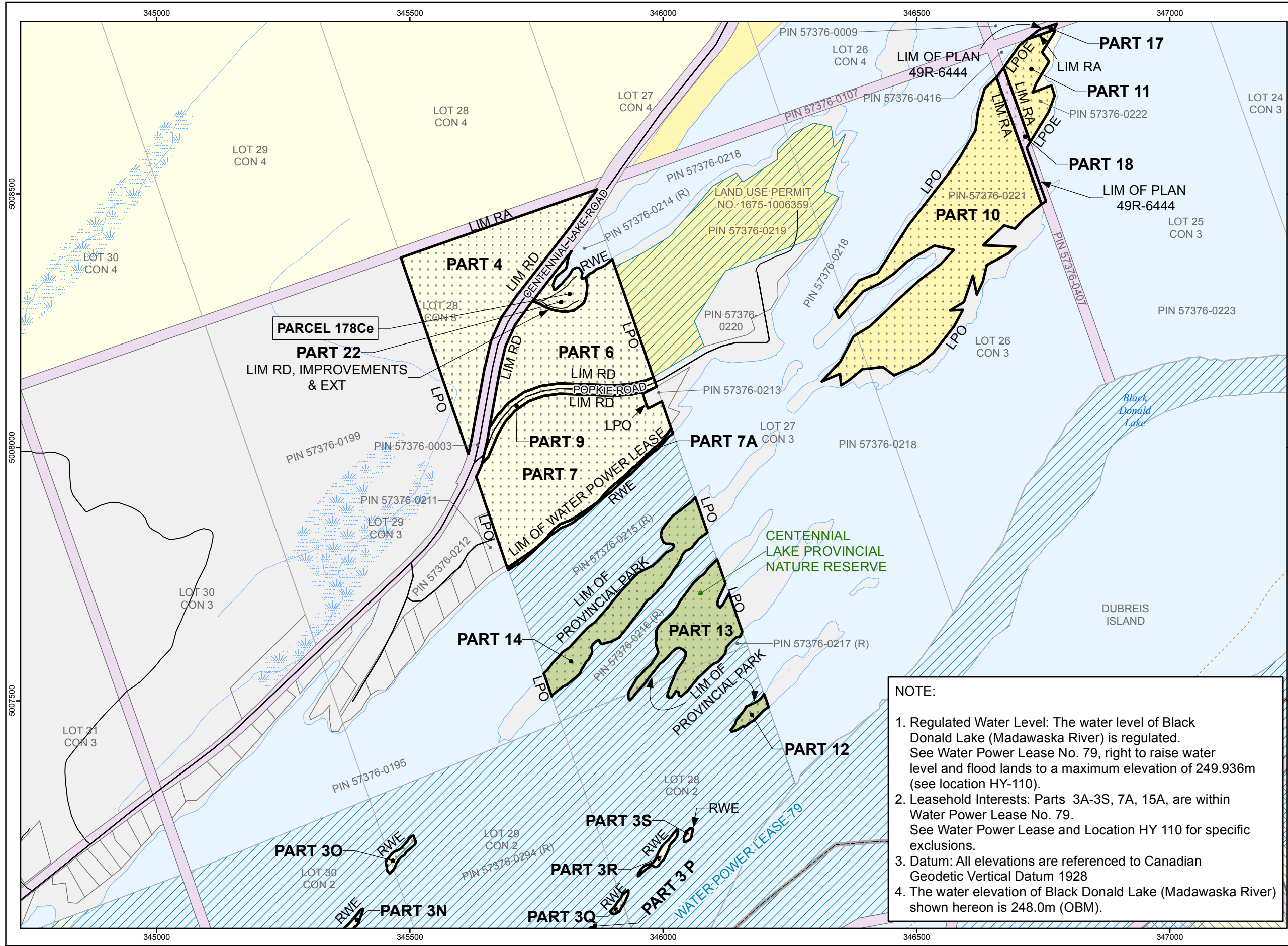

LEGEND

Land Selection	Railway
Other Land Selection	Trail
Disposition	Resource Road
First Nation	Local / Private Road
Crown Land	Municipal Road
Acquired Crown Land	Highway
Municipal Ownership	Transmission Line
Private Ownership	Gas Pipeline
Provincial Park / Conservation Reserve	Lake
Recommended Park	Lake Trout Lake
Mining Claim	Wetland
Geographic Township	River
Lot Fabric	Contour of Elevation
	Flooding Contour

- NOTES:**
- CAUTION: THIS IS NOT A PLAN OF SURVEY**
This map describes the intent of the parcel boundary. The information has been compiled from various sources and the accuracy is not guaranteed. The true location and area on the ground must be determined by survey. Do not rely on this map as a precise indicator of routes, locations of features, nor as a guide for navigation.
 - Survey Instructions from the Surveyor General of Ontario must be obtained prior to establishing any of the boundaries on the ground.
 - Projection: NAD83 (CSRS) UTM Zone 18
 - EXT - Denotes Extended
 - LIM - Denotes Limit
 - LL - Denotes Lot Line
 - LLUP - Denotes Limit of Land Use Permit
 - LPO - Denotes Limit of Private Ownership
 - LPOE - Denotes Limit of Private Ownership and Extended
 - LW - Denotes Limit of Wetland
 - NS - Denotes Not in Site
 - RA - Denotes Road Allowance
 - RWE - Denotes Regulated Water's Edge being the water's edge as affected by the operation of water level control structures, when operated, and otherwise at the water's edge as it occurs naturally.
 - WE - Denotes Water's Edge

NOTE:

- Regulated Water Level:** The water level of Black Donald Lake (Madawaska River) is regulated. See Water Power Lease No. 79, right to raise water level and flood lands to a maximum elevation of 249.936m (see location HY-110).
- Leasehold Interests:** Parts 3A-3S, 7A, 15A, are within Water Power Lease No. 79. See Water Power Lease and Location HY 110 for specific exclusions.
- Datum:** All elevations are referenced to Canadian Geodetic Vertical Datum 1928
- The water elevation of Black Donald Lake (Madawaska River) shown hereon is 248.0m (OBM).

DATA SOURCE:
Land Information Ontario Warehouse (February 1, 2011), other information of record with the Ministry of Natural Resources and the Ministry of Northern Development and Mines, Registry Office title documents and Teranet Geowarehouse.

PRODUCED BY:
The Office of the Surveyor General December 17, 2014
Ministry of Natural Resources & Forestry
© Queen's Printer for Ontario, 2014
RC178C_OSG_20141217.mxd

Appendix 5.1.1 - Proposed Settlement Lands (Parcel 178C), Section 5.3.1 - Easement (Parcel 178Ce)

**ALGONQUIN
LAND CLAIM
DESCRIPTIVE PLAN**

**PARCEL 178C &
PARCEL 178Ce**

SHEET 4 of 7

0 125 250
Metres
1:7,500

LEGEND

Land Selection	Railway
Other Land Selection	Trail
Disposition	Resource Road
First Nation	Local / Private Road
Crown Land	Municipal Road
Acquired Crown Land	Highway
Municipal Ownership	Transmission Line
Private Ownership	Gas Pipeline
Provincial Park / Conservation Reserve	Lake
Recommended Park	Lake Trout Lake
Mining Claim	Wetland
Geographic Township	River
Lot Fabric	Contour of Elevation
	Flooding Contour

- NOTES:**
- CAUTION: THIS IS NOT A PLAN OF SURVEY**
This map describes the intent of the parcel boundary. The information has been compiled from various sources and the accuracy is not guaranteed. The true location and area on the ground must be determined by survey. Do not rely on this map as a precise indicator of routes, locations of features, nor as a guide for navigation.
 - Survey Instructions from the Surveyor General of Ontario must be obtained prior to establishing any of the boundaries on the ground.
 - Projection: NAD83 (CSRS) UTM Zone 18
 - EXT - Denotes Extended
 - LIM - Denotes Limit
 - LL - Denotes Lot Line
 - LLUP - Denotes Limit of Land Use Permit
 - LPO - Denotes Limit of Private Ownership
 - LPOE - Denotes Limit of Private Ownership and Extended
 - LW - Denotes Limit of Wetland
 - NS - Denotes Not in Site
 - RA - Denotes Road Allowance
 - RWE - Denotes Regulated Water's Edge being the water's edge as affected by the operation of water level control structures, when operated, and otherwise at the water's edge as it occurs naturally.
 - WE - Denotes Water's Edge

DATA SOURCE:
Land Information Ontario Warehouse (February 1, 2011), other information of record with the Ministry of Natural Resources and the Ministry of Northern Development and Mines, Registry Office title documents and Teranet Geowarehouse.

PRODUCED BY:
The Office of the Surveyor General December 17, 2014
Ministry of Natural Resources & Forestry
© Queen's Printer for Ontario, 2014
Ontario

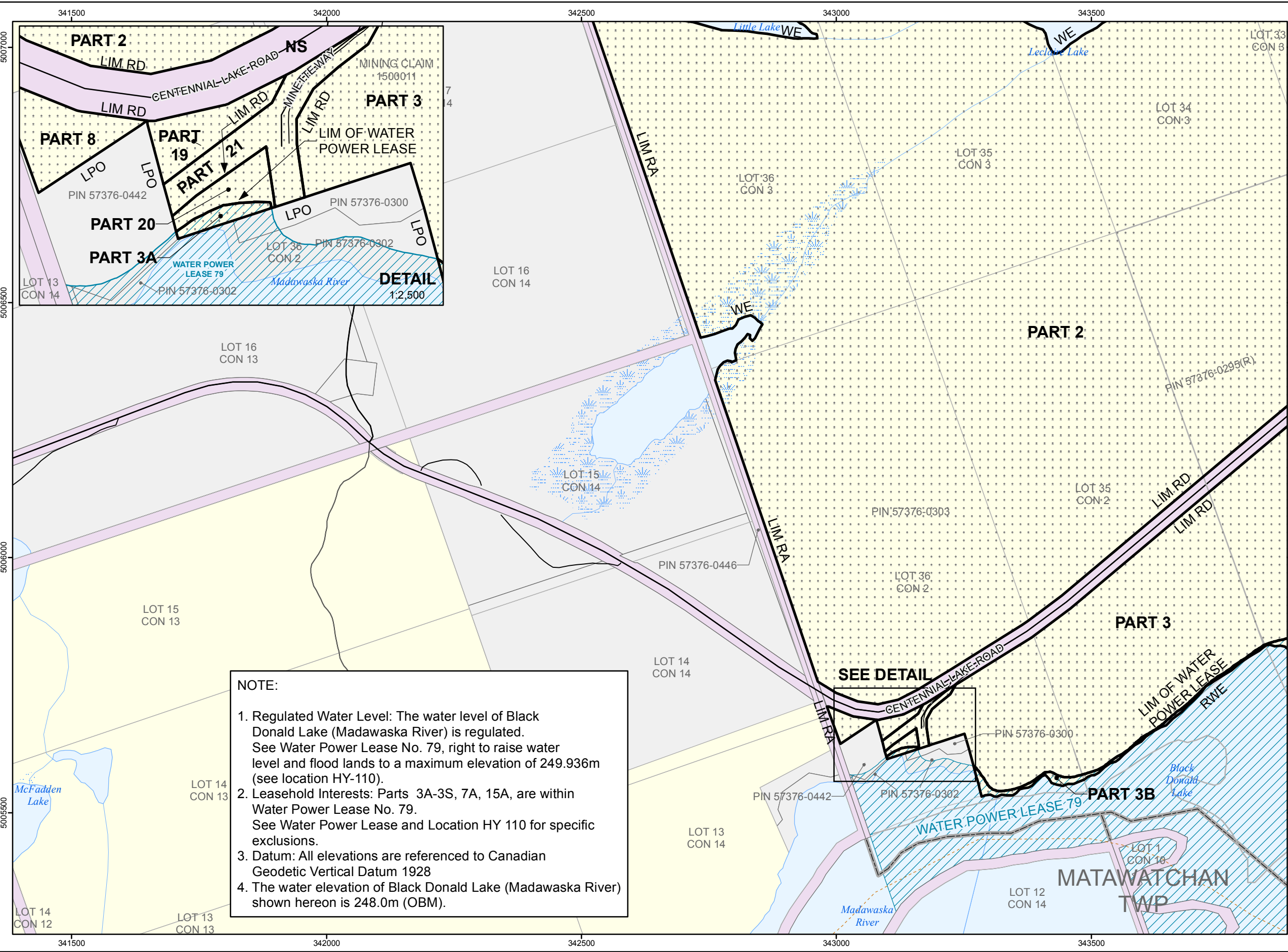

NOTE:

- Regulated Water Level: The water level of Black Donald Lake (Madawaska River) is regulated. See Water Power Lease No. 79, right to raise water level and flood lands to a maximum elevation of 249.936m (see location HY-110).
- Leasehold Interests: Parts 3A-3S, 7A, 15A, are within Water Power Lease No. 79. See Water Power Lease and Location HY 110 for specific exclusions.
- Datum: All elevations are referenced to Canadian Geodetic Vertical Datum 1928
- The water elevation of Black Donald Lake (Madawaska River) shown hereon is 248.0m (OBM).

Appendix 5.1.1 - Proposed Settlement Lands (Parcel 178C), Section 5.3.1 - Easement (Parcel 178Ce)

**ALGONQUIN
LAND CLAIM
DESCRIPTIVE PLAN**

**PARCEL 178C &
PARCEL 178Ce**

SHEET 5 of 7

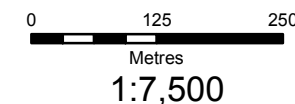

LEGEND

Land Selection	Railway
Other Land Selection	Trail
Disposition	Resource Road
First Nation	Local / Private Road
Crown Land	Municipal Road
Acquired Crown Land	Highway
Municipal Ownership	Transmission Line
Private Ownership	Gas Pipeline
Provincial Park / Conservation Reserve	Lake
Recommended Park	Lake Trout Lake
Mining Claim	Wetland
Geographic Township	River
Lot Fabric	Contour of Elevation
	Flooding Contour

NOTE:

1. Regulated Water Level: The water level of Black Donald Lake (Madawaska River) is regulated. See Water Power Lease No. 79, right to raise water level and flood lands to a maximum elevation of 249.936m (see location HY-110).
2. Leasehold Interests: Parts 3A-3S, 7A, 15A, are within Water Power Lease No. 79. See Water Power Lease and Location HY 110 for specific exclusions.
3. Datum: All elevations are referenced to Canadian Geodetic Vertical Datum 1928
4. The water elevation of Black Donald Lake (Madawaska River) shown hereon is 248.0m (OBM).

NOTES:

1. **CAUTION: THIS IS NOT A PLAN OF SURVEY**
This map describes the intent of the parcel boundary. The information has been compiled from various sources and the accuracy is not guaranteed. The true location and area on the ground must be determined by survey. Do not rely on this map as a precise indicator of routes, locations of features, nor as a guide for navigation.
2. Survey Instructions from the Surveyor General of Ontario must be obtained prior to establishing any of the boundaries on the ground.
3. Projection: NAD83 (CSRS) UTM Zone 18
4. EXT - Denotes Extended
5. LIM - Denotes Limit
6. LL - Denotes Lot Line
7. LLUP - Denotes Limit of Land Use Permit
8. LPO - Denotes Limit of Private Ownership
9. LPOE - Denotes Limit of Private Ownership and Extended
10. LW - Denotes Limit of Wetland
11. NS - Denotes Not in Site
12. RA - Denotes Road Allowance
13. RWE - Denotes Regulated Water's Edge being the water's edge as affected by the operation of water level control structures, when operated, and otherwise at the water's edge as it occurs naturally.
14. WE - Denotes Water's Edge

DATA SOURCE:
Land Information Ontario Warehouse (February 1, 2011), other information of record with the Ministry of Natural Resources and the Ministry of Northern Development and Mines, Registry Office title documents and Teranet Geowarehouse.

PRODUCED BY:
The Office of the Surveyor General
December 17, 2014
Ministry of Natural Resources & Forestry
© Queen's Printer for Ontario, 2014

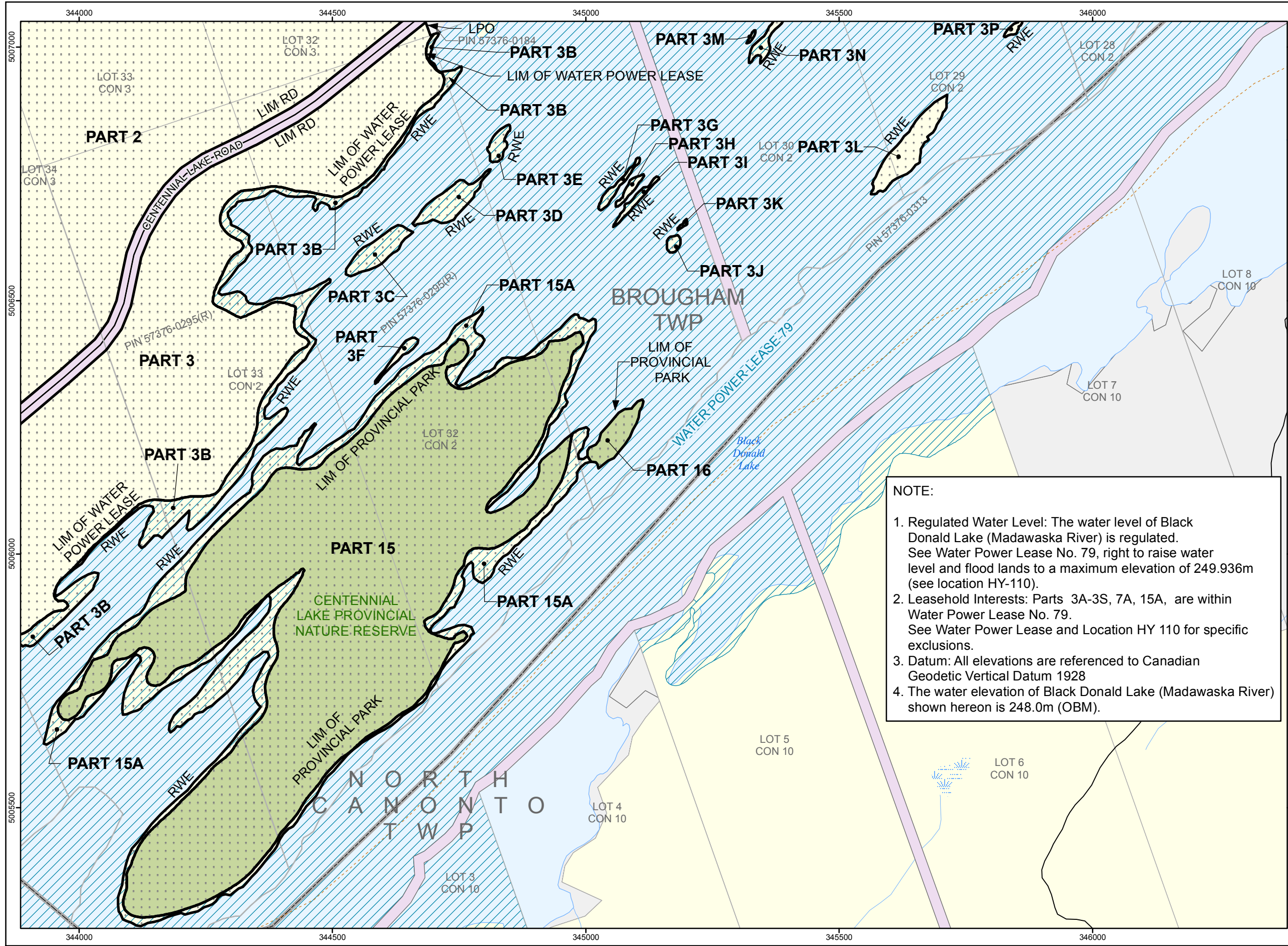

Appendix 5.1.1 - Proposed Settlement Lands (Parcel 178C), Section 5.3.1 - Easement (Parcel 178Ce)

**ALGONQUIN
LAND CLAIM
DESCRIPTIVE PLAN**

PARCEL 178C &
PARCEL 178Ce

SHEET 6 of 7

PART SCHEDULE						
Part #	Description	Area (ha)	Area Included (ha)	Area Not Included (ha)	Action	Comments
PART 1	Unpatented Crown Land	7.3	7.3		Patent	
PART 2		249.6	249.6			
PART 3		50.6	50.6			
PART 3A	Unpatented Crown Land (Water Power Lease 79)	0.1		0.1	Excluded	Parties to discuss with public utility the possibility of transfer of lands affected by WPL
PART 3B		4.4		4.4		
PART 3C	Unpatented Crown Land (Water Power Lease 79)	0.5		0.5	Excluded	Parties to discuss with public utility the possibility of transfer of lands affected by WPL
PART 3D		0.6		0.6		
PART 3E		0.2		0.2		
PART 3F		0.1		0.1		
PART 3G		0.1		0.1		
PART 3H		0.1		0.1		
PART 3I		0.1		0.1		
PART 3J		0.1		0.1		
PART 3K		<0.1		<0.1		
PART 3L		0.9		0.9		
PART 3M		<0.1		<0.1		
PART 3N		0.2		0.2		
PART 3O		0.1		0.1		
PART 3P		<0.1		<0.1		
PART 3Q		0.1		0.1		
PART 3R	0.1		0.1			
PART 3S	<0.1		<0.1			

NOTE: Total Area as shown is the sum of areas of all parts, including those < 0.1 ha.

PRODUCED BY:
The Office of the Surveyor General December 17, 2014



Ministry of
Natural Resources & Forestry
© Queen's Printer for Ontario, 2014

Appendix 5.1.1 - Proposed Settlement Lands (Parcel 178C), Section 5.3.1 - Easement (Parcel 178Ce)

**ALGONQUIN
LAND CLAIM
DESCRIPTIVE PLAN**

**PARCEL 178C &
PARCEL 178Ce**

SHEET 7 of 7

PART SCHEDULE						
Part #	Description	Area (ha)	Area Included (ha)	Area Not Included (ha)	Action	Comments
PART 4	Unpatented Crown Land	6.6	6.6		Patent	
PART 5	Road Allowance	0.8	0.8		AOO have requested the RA	Parties to discuss with the municipality the possibility of transfer of the RA
PART 6	Unpatented Crown Land	4.8	4.8		Patent	
PART 7		7.6	7.6			
PART 7A	Unpatented Crown Land (Water Power Lease 79)	0.2		0.2	Excluded	Parties to discuss with public utility the possibility of transfer of lands affected by WPL
PART 8	Unpatented Crown Land	0.3	0.3		Patent	
PART 9	Road	0.8		0.8	Excluded	
PART 10	Acquired Crown Land (Ministry of Government Services)	8.5	8.5		Transfer	
PART 11		1.2	1.2			
PART 12	Unpatented Crown Land (Centennial Lake Provincial Nature Reserve)	0.2	0.2		Patent	
PART 13		2.4	2.4			
PART 14		2.3	2.3			
PART 15		41.4	41.4			
PART 15A	Unpatented Crown Land (Water Power Lease 79)	9.0		9.0	Excluded	Parties to discuss with public utility the possibility of transfer of lands affected by WPL
PART 16	Unpatented Crown Land (Centennial Lake Provincial Nature Reserve)	0.6	0.6		Patent	
PART 17	Road Allowance	<0.1	<0.1		AOO have requested the RA	Parties to discuss with the municipality the possibility of transfer of the RA
PART 18		0.4	0.4			
PART 19	Unpatented Crown Land	0.2	0.2		Patent	
PART 20	Unpatented Crown Land	0.1	0.1			
PART 21	Road	0.4	0.4		Patent Subject to Easement	Easement to be issued for access to adjacent private land
PART 22	Parcel 178Ce (Easement)	0.6		0.6	Issue Easement to AOO	Algonquin Interest in Crown Land
Total Area (ha)		403.7	385.4	18.3		
Total Area (ac)		997.6	952.3	45.2		

NOTE: Total Area as shown is the sum of areas of all parts, including those < 0.1 ha.

PRODUCED BY:
The Office of the Surveyor General December 17, 2014



Ministry of
Natural Resources & Forestry
© Queen's Printer for Ontario, 2014

RC178C_PartSchedule.xls

Appendix 5.1.1 - Proposed Settlement Lands (Parcel 178C), Section 5.3.1 - Easement (Parcel 178Ce)

Stakeholder Activities in Parcel 178C

Activity	Description	Status	Size of Area (ac)	Percent of Area Affected (%)
Bait Harvest Area	PE0218	Active	653.2	5.1
Bait Harvest Area	PE0508	Inactive	342.9	7.3
Bear Management Area	PE-58-006	Inactive	643.2	0.5
Certificate of Approval	None known			
Conservation Authority Area	None			
Extractable Aggregate	None			
Forest Management Unit	780 - Ottawa Valley Forest			
Land Use Permit	LUP #1675-1006260 - Rec Camp			
Lease	OPG Water Power Lease Agreement # 79			
Licence of Occupation	None			
Mining Claim	None			
Mining Lease	None			
Order-in-Council	None			
Research Plot	Forest Ecosystem Classification Trial Plot #02-268			
Research Plot	Forest Ecosystem Classification Trial Plot #02-269			
Resident Trapper	None			
Seed Area	None			
Trail	None			
Trapline Area	PE069	Active	475.4	4.4
Wind Power Application	None			

The information included in this table is based on the best information as of August 1, 2013. Information may be subject to change.