

Appendix 5.1.1 - Proposed Settlement Lands

ALGONQUIN LAND CLAIM DESCRIPTIVE PLAN

PARCEL 107A

Sheet 1 of 13

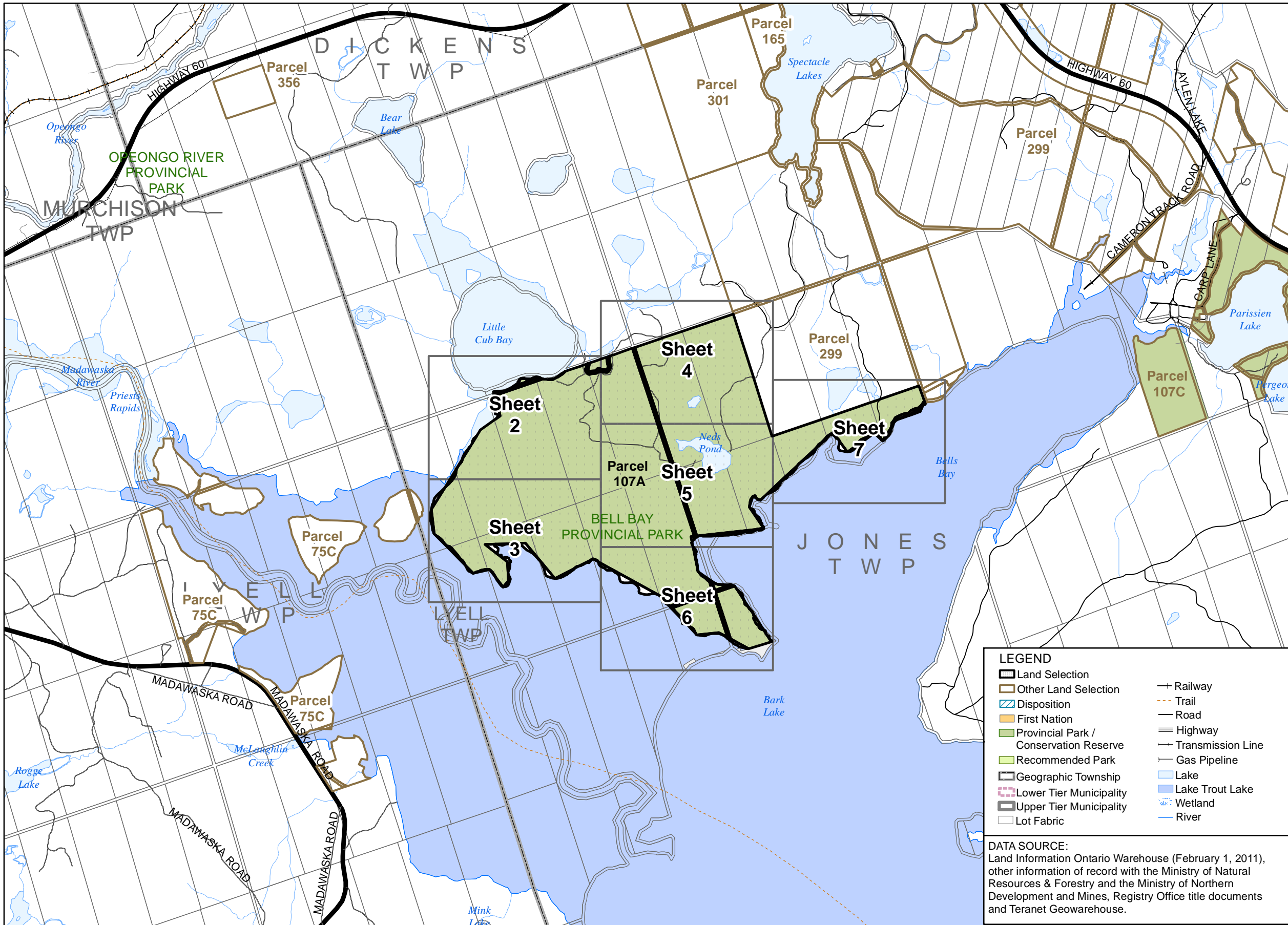
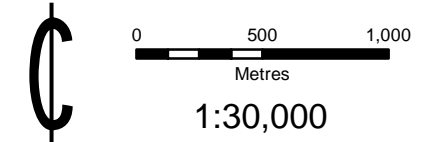

LEGEND

Land Selection	Railway
Other Land Selection	Trail
Disposition	Road
First Nation	Highway
Provincial Park / Conservation Reserve	Transmission Line
Recommended Park	Gas Pipeline
Geographic Township	Lake
Lower Tier Municipality	Lake Trout Lake
Upper Tier Municipality	Wetland
Lot Fabric	River

DATA SOURCE:
Land Information Ontario Warehouse (February 1, 2011), other information of record with the Ministry of Natural Resources & Forestry and the Ministry of Northern Development and Mines, Registry Office title documents and Teranet Geowarehouse.

- CAUTION: THIS IS NOT A PLAN OF SURVEY**
- This Descriptive Plan is a graphic illustration of the Settlement Lands identified in the Settlement Agreement of the Algonquin Land Claim. This plan is intended to illustrate the complex inter-relationships between the Settlement Lands and other previous dispositions and alienations of public lands and is necessary to prevent duplicate or overlapping tenure commitments on the same lands.
- This Descriptive Plan has been prepared from the best available information but without benefit of survey. The absolute and relative positional accuracy of the data shown hereon has not been verified. Discrepancies between different data sources are known to exist. Do not use this Plan as evidence of the location of legal boundaries, township lot fabric, features, or routes. Do not rely on this Plan to determine the extent of parcel areas, the existence of navigable bodies of water nor as a guide for navigation.
- Any sale, lease or other disposition of lands illustrated hereon made pursuant to the Settlement Agreement of the Algonquin Land Claim is limited to the extent of the un-alienated rights held by the Ministry of Natural Resources and every grant shall be subject to the provisions of the statute of the Bed of Navigable Waters Act, R.S.O. 1990, Chapter B.4.
- The boundary information must be read in conjunction with all Notes appearing in and on the Plan series and within the terms of the Settlement Agreement. Should the provisions contained on the Descriptive Plan be found to conflict with the terms contained within the Settlement Agreement the terms contained within the Settlement Agreement shall prevail. Nothing hereon contained, except the provision for the application of "The Bed of Navigable Waters Act" aforesaid, shall affect the interpretation which would, apart from this Descriptive Plan, be put upon the words of any letters patent hereafter issued under the Great Seal of the Province of Ontario, or of any lease or other conveyance, or of any contract heretofore or hereafter made under the direction of the Province of Ontario.
- Survey Instructions from the Surveyor General of Ontario must be obtained prior to establishing any of the boundaries on the ground.

PRODUCED BY:
The Office of the Surveyor General January 6, 2015

Ontario Ministry of Natural Resources & Forestry
© Queen's Printer for Ontario, 2015

RC107A_Sheet1.mxd

Appendix 5.1.1 - Proposed Settlement Lands

ALGONQUIN LAND CLAIM DESCRIPTIVE PLAN PARCEL 107A

Sheet 2 of 13

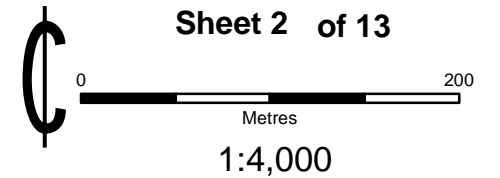

NOTE:

1. Regulated Water Level: The water level of Bark Lake is regulated. See Licence of Occupation No. 9775 for specifics.
2. Injurious Lands: Licence of Occupation No. 9775 has identified that lands lying below contour of elevation 313.94m may be affected by flooding
3. Datum: All elevations are referenced to Geodetic Survey of Canada datum.
4. The water elevation of Bark Lake shown hereon is 312.0m (OBM)

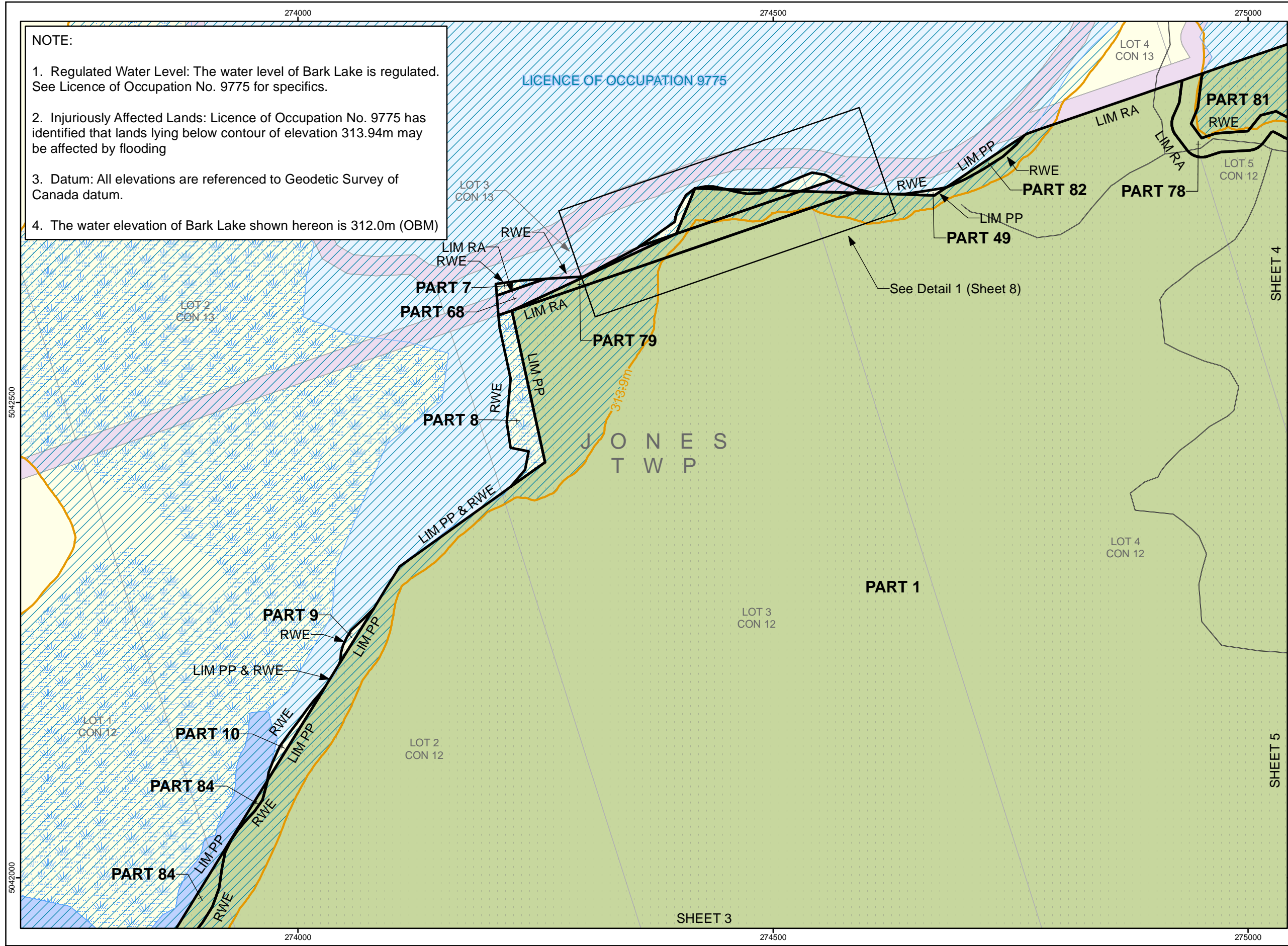

LEGEND

Land Selection	Railway
Other Land Selection	Trail
Disposition	Resource Road
First Nation	Local / Private Road
Crown Land	Municipal Road
Acquired Crown Land	Highway
Municipal Ownership	Transmission Line
Private Ownership	Gas Pipeline
Provincial Park / Conservation Reserve	Lake
Recommended Park	Lake Trout Lake
Mining Claim	Wetland
Geographic Township	River
Lot Fabric	Contour of Elevation
	Flooding Contour

NOTES:

1. **CAUTION: THIS IS NOT A PLAN OF SURVEY**
This map describes the intent of the parcel boundary. The information has been compiled from various sources and the accuracy is not guaranteed. The true location and area on the ground must be determined by survey. Do not rely on this map as a precise indicator of routes, locations of features, nor as a guide for navigation.
2. Survey Instructions from the Surveyor General of Ontario must be obtained prior to establishing any of the boundaries on the ground.
3. Projection: NAD83 (CSRS) UTM Zone 18
4. EXT - Denotes Extended
5. LIM - Denotes Limit
6. LL - Denotes Lot Line
7. LLUP - Denotes Limit of Land Use Permit
8. LPO - Denotes Limit of Private Ownership
9. LPOE - Denotes Limit of Private Ownership and Extended
10. LW - Denotes Limit of Wetland
11. NS - Denotes Not in Site
12. RA - Denotes Road Allowance
13. RWE - Denotes Regulated Water's Edge being the water's edge as affected by the operation of water level control structures, when operated, and otherwise at the water's edge as it occurs naturally.
14. WE - Denotes Water's Edge
15. PP - Denotes Provincial Park

DATA SOURCE:
Land Information Ontario Warehouse (February 1, 2011), other information of record with the Ministry of Natural Resources & Forestry and the Ministry of Northern Development and Mines, Registry Office title documents and Teranet Geowarehouse.

PRODUCED BY:
The Office of the Surveyor General
January 6, 2015
Ministry of Natural Resources & Forestry
© Queen's Printer for Ontario, 2015
RC107A_OSG_20150106.mxd

Appendix 5.1.1 - Proposed Settlement Lands

ALGONQUIN LAND CLAIM DESCRIPTIVE PLAN

PARCEL 107A

Sheet 3 of 13

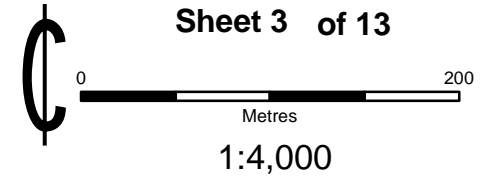

NOTE:

1. Regulated Water Level: The water level of Bark Lake is regulated. See Licence of Occupation No. 9775 for specifics.
2. Injurious Affected Lands: Licence of Occupation No. 9775 has identified that lands lying below contour of elevation 313.94m may be affected by flooding
3. Datum: All elevations are referenced to Geodetic Survey of Canada datum.
4. The water elevation of Bark Lake shown hereon is 312.0m (OBM)

LEGEND

Land Selection	Railway
Other Land Selection	Trail
Disposition	Resource Road
First Nation	Local / Private Road
Crown Land	Municipal Road
Acquired Crown Land	Highway
Municipal Ownership	Transmission Line
Private Ownership	Gas Pipeline
Provincial Park / Conservation Reserve	Lake
Recommended Park	Lake Trout Lake
Mining Claim	Wetland
Geographic Township	River
Lot Fabric	Contour of Elevation
	Flooding Contour

NOTES:

1. **CAUTION: THIS IS NOT A PLAN OF SURVEY**
This map describes the intent of the parcel boundary. The information has been compiled from various sources and the accuracy is not guaranteed. The true location and area on the ground must be determined by survey. Do not rely on this map as a precise indicator of routes, locations of features, nor as a guide for navigation.
2. Survey Instructions from the Surveyor General of Ontario must be obtained prior to establishing any of the boundaries on the ground.
3. Projection: NAD83 (CSRS) UTM Zone 18
4. EXT - Denotes Extended
5. LIM - Denotes Limit
6. LL - Denotes Lot Line
7. LLUP - Denotes Limit of Land Use Permit
8. LPO - Denotes Limit of Private Ownership
9. LPOE - Denotes Limit of Private Ownership and Extended
10. LW - Denotes Limit of Wetland
11. NS - Denotes Not in Site
12. RA - Denotes Road Allowance
13. RWE - Denotes Regulated Water's Edge being the water's edge as affected by the operation of water level control structures, when operated, and otherwise at the water's edge as it occurs naturally.
14. WE - Denotes Water's Edge
15. PP - Denotes Provincial Park

DATA SOURCE:
Land Information Ontario Warehouse (February 1, 2011), other information of record with the Ministry of Natural Resources & Forestry and the Ministry of Northern Development and Mines, Registry Office title documents and Teranet Geowarehouse.

PRODUCED BY:
The Office of the Surveyor General
January 6, 2015
Ministry of Natural Resources & Forestry
© Queen's Printer for Ontario, 2015
RC107A_OSG_20150106.mxd

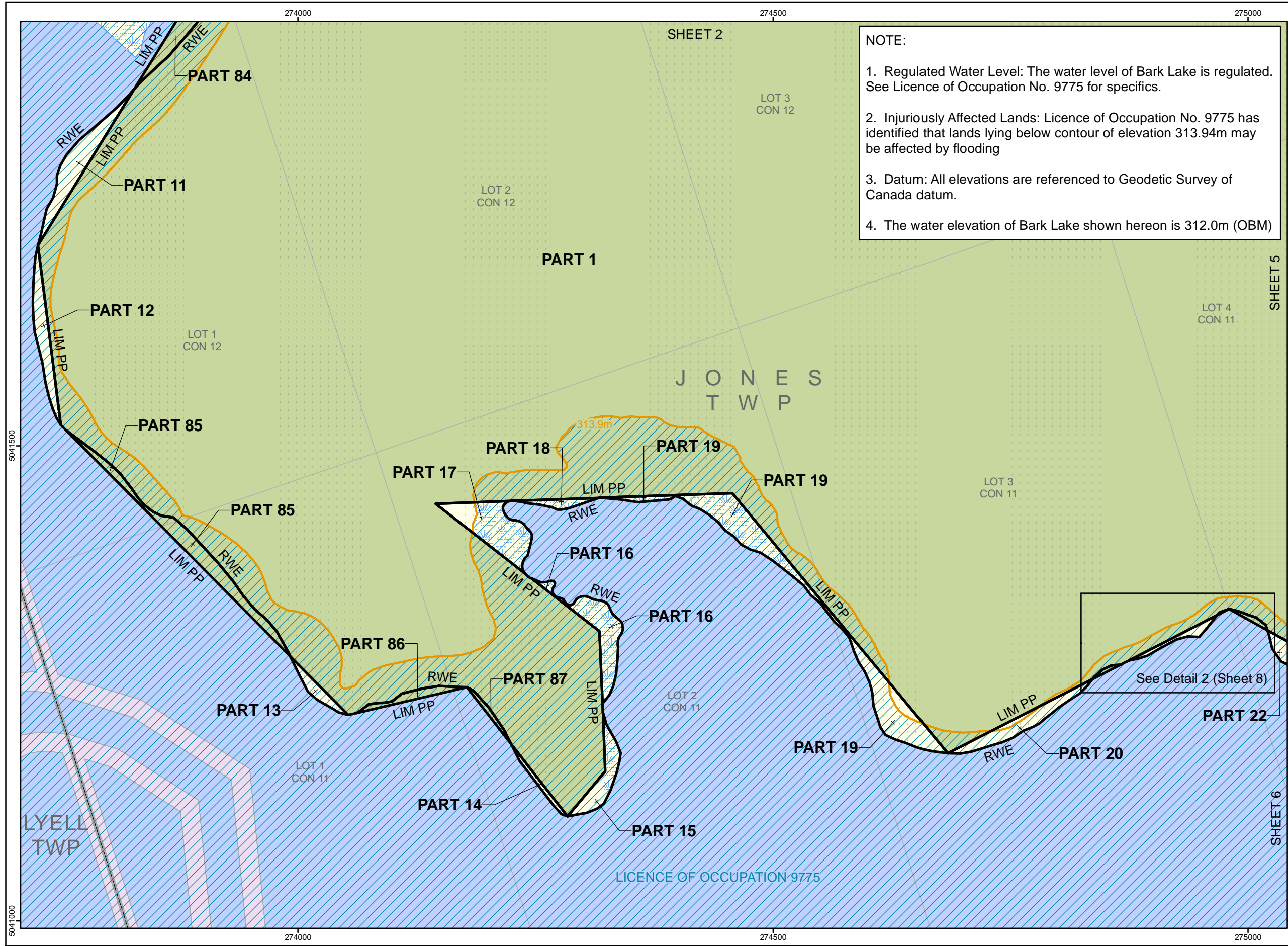

Appendix 5.1.1 - Proposed Settlement Lands

ALGONQUIN LAND CLAIM DESCRIPTIVE PLAN PARCEL 107A

Sheet 4 of 13

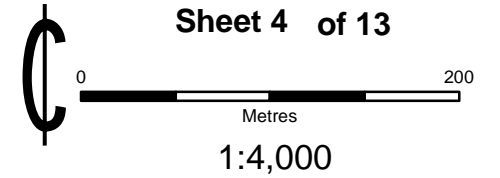

LEGEND	
Land Selection	Railway
Other Land Selection	Trail
Disposition	Resource Road
First Nation	Local / Private Road
Crown Land	Municipal Road
Acquired Crown Land	Highway
Municipal Ownership	Transmission Line
Private Ownership	Gas Pipeline
Provincial Park / Conservation Reserve	Lake
Recommended Park	Lake Trout Lake
Mining Claim	Wetland
Geographic Township	River
Lot Fabric	Contour of Elevation
	Flooding Contour

- NOTES:
- CAUTION: THIS IS NOT A PLAN OF SURVEY**
This map describes the intent of the parcel boundary. The information has been compiled from various sources and the accuracy is not guaranteed. The true location and area on the ground must be determined by survey. Do not rely on this map as a precise indicator of routes, locations of features, nor as a guide for navigation.
 - Survey Instructions from the Surveyor General of Ontario must be obtained prior to establishing any of the boundaries on the ground.
 - Projection: NAD83 (CSRS) UTM Zone 18
 - EXT - Denotes Extended
 - LIM - Denotes Limit
 - LL - Denotes Lot Line
 - LLUP - Denotes Limit of Land Use Permit
 - LPO - Denotes Limit of Private Ownership
 - LPOE - Denotes Limit of Private Ownership and Extended
 - LW - Denotes Limit of Wetland
 - NS - Denotes Not in Site
 - RA - Denotes Road Allowance
 - RWE - Denotes Regulated Water's Edge being the water's edge as affected by the operation of water level control structures, when operated, and otherwise at the water's edge as it occurs naturally.
 - WE - Denotes Water's Edge
 - PP - Denotes Provincial Park

DATA SOURCE:
Land Information Ontario Warehouse (February 1, 2011), other information of record with the Ministry of Natural Resources & Forestry and the Ministry of Northern Development and Mines, Registry Office title documents and Teranet Geowarehouse.

PRODUCED BY:
The Office of the Surveyor General
January 6, 2015
Ministry of Natural Resources & Forestry
© Queen's Printer for Ontario, 2015
RC107A_OSG_20150106.mxd

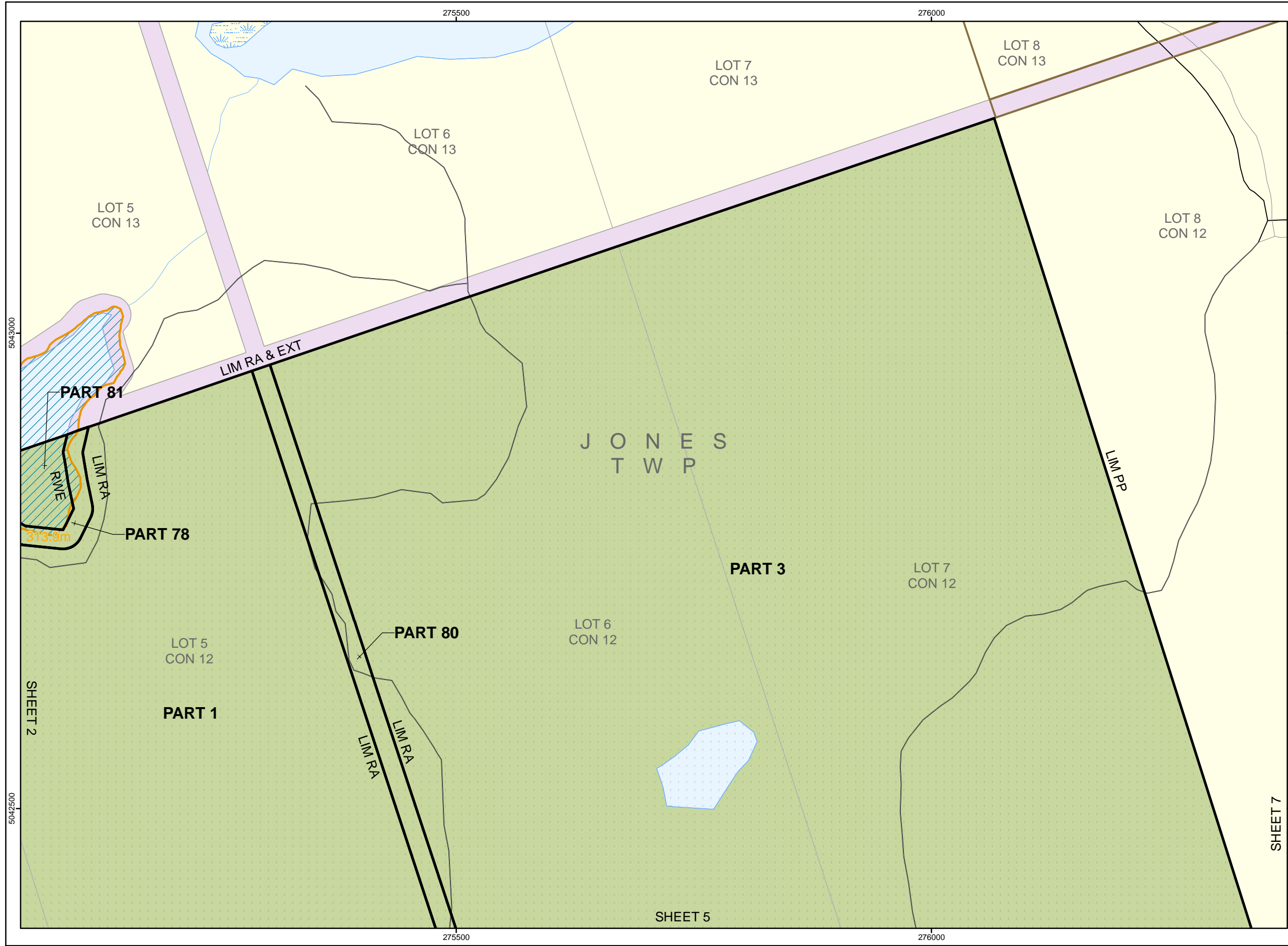

SHEET 2

SHEET 7

SHEET 5

Appendix 5.1.1 - Proposed Settlement Lands

ALGONQUIN LAND CLAIM DESCRIPTIVE PLAN PARCEL 107A

Sheet 5 of 13

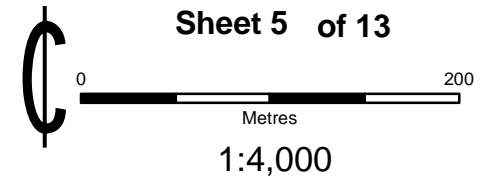

LEGEND	
Land Selection	Railway
Other Land Selection	Trail
Disposition	Resource Road
First Nation	Local / Private Road
Crown Land	Municipal Road
Acquired Crown Land	Highway
Municipal Ownership	Transmission Line
Private Ownership	Gas Pipeline
Provincial Park / Conservation Reserve	Lake
Recommended Park	Lake Trout Lake
Mining Claim	Wetland
Geographic Township	River
Lot Fabric	Contour of Elevation
	Flooding Contour

- NOTES:
- CAUTION: THIS IS NOT A PLAN OF SURVEY**
This map describes the intent of the parcel boundary. The information has been compiled from various sources and the accuracy is not guaranteed. The true location and area on the ground must be determined by survey. Do not rely on this map as a precise indicator of routes, locations of features, nor as a guide for navigation.
 - Survey Instructions from the Surveyor General of Ontario must be obtained prior to establishing any of the boundaries on the ground.
 - Projection: NAD83 (CSRS) UTM Zone 18
 - EXT - Denotes Extended
 - LIM - Denotes Limit
 - LL - Denotes Lot Line
 - LLUP - Denotes Limit of Land Use Permit
 - LPO - Denotes Limit of Private Ownership
 - LPOE - Denotes Limit of Private Ownership and Extended
 - LW - Denotes Limit of Wetland
 - NS - Denotes Not in Site
 - RA - Denotes Road Allowance
 - RWE - Denotes Regulated Water's Edge being the water's edge as affected by the operation of water level control structures, when operated, and otherwise at the water's edge as it occurs naturally.
 - WE - Denotes Water's Edge
 - PP - Denotes Provincial Park

DATA SOURCE:
Land Information Ontario Warehouse (February 1, 2011), other information of record with the Ministry of Natural Resources & Forestry and the Ministry of Northern Development and Mines, Registry Office title documents and Teranet Geowarehouse.

PRODUCED BY:
The Office of the Surveyor General
January 6, 2015
Ministry of Natural Resources & Forestry
© Queen's Printer for Ontario, 2015
RC107A_OSG_20150106.mxd

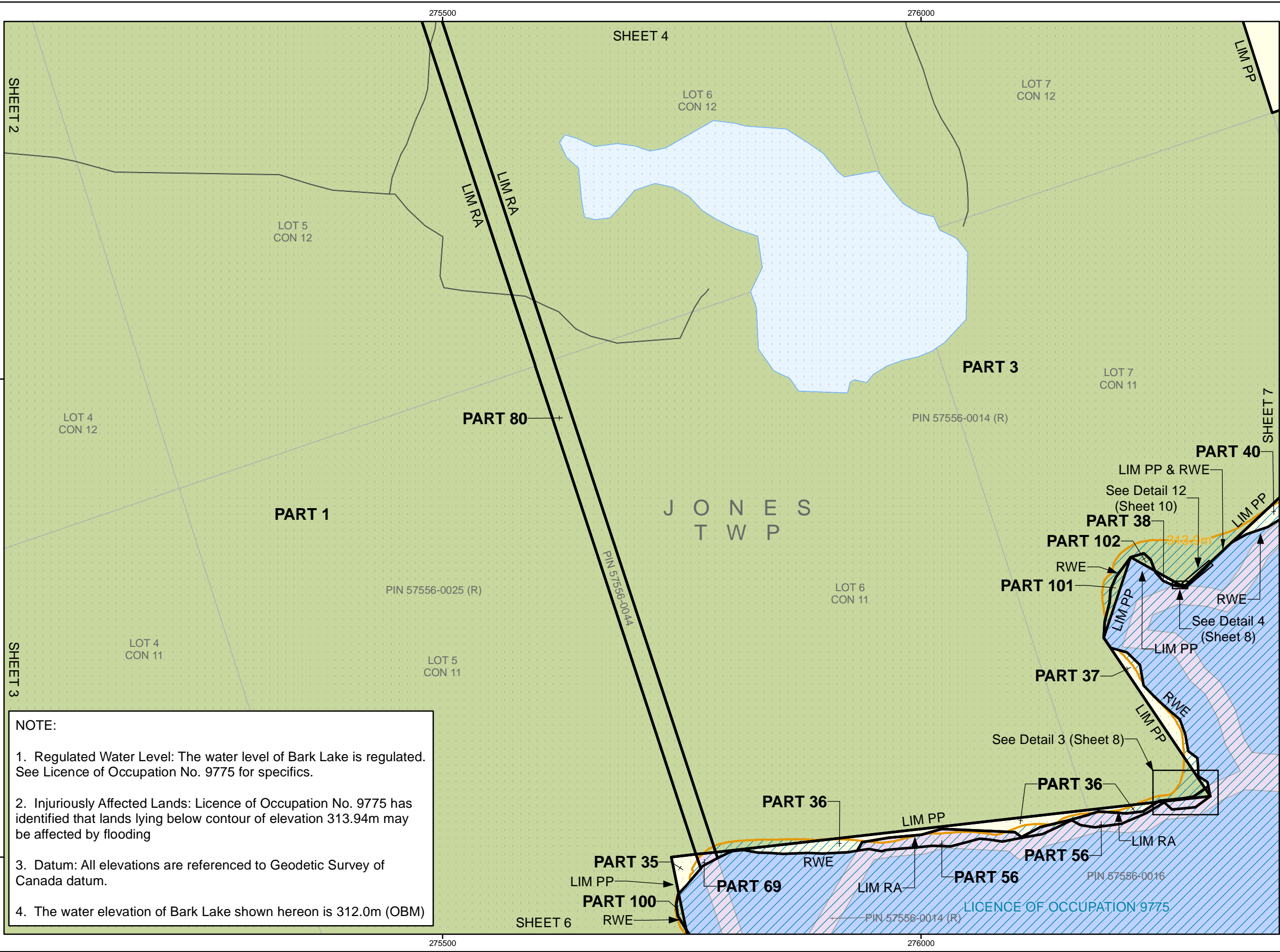

NOTE:

- Regulated Water Level: The water level of Bark Lake is regulated. See Licence of Occupation No. 9775 for specifics.
- Injurious Affected Lands: Licence of Occupation No. 9775 has identified that lands lying below contour of elevation 313.94m may be affected by flooding
- Datum: All elevations are referenced to Geodetic Survey of Canada datum.
- The water elevation of Bark Lake shown hereon is 312.0m (OBM)

5042000

SHEET 3

5041500

5042000

SHEET 7

5041500

275500

276000

275500

276000

SHEET 4

LOT 6
CON 12

LOT 7
CON 12

LOT 5
CON 12

LOT 4
CON 12

LOT 4
CON 11

LOT 5
CON 11

LOT 6
CON 11

LOT 7
CON 11

PART 35

PART 36

PART 37

PART 38

PART 40

PART 102

PART 101

PART 69

PART 56

PART 56

PART 100

SHEET 6

LIM PP

RWE

LIM RA

LIM PP

RWE

LIM RA

LIM PP

RWE

LIM RA

LIM PP

RWE

LIM PP

RWE

LIM RA

LIM PP

RWE

LIM RA

LIM PP

RWE

LIM RA

LIM PP

RWE

LIM RA

LIM PP

RWE

LIM RA

LIM PP

RWE

LIM RA

LIM PP

RWE

LIM RA

LIM PP

RWE

LIM RA

LIM PP

RWE

LIM RA

LIM PP

RWE

LIM RA

LIM PP

RWE

LIM RA

LIM PP

RWE

LIM RA

LIM PP

RWE

LIM RA

LIM PP

RWE

LIM RA

LIM PP

RWE

LIM RA

LIM PP

RWE

LIM RA

LIM PP

RWE

LIM RA

LIM PP

RWE

LIM RA

LIM PP

RWE

LIM RA

LIM PP

RWE

LIM RA

LIM PP

RWE

LIM RA

LIM PP

RWE

LIM RA

LIM PP

RWE

LIM RA

LIM PP

RWE

LIM RA

LIM PP

RWE

LIM RA

LIM PP

RWE

LIM RA

LIM PP

RWE

LIM RA

LIM PP

RWE

LIM RA

LIM PP

RWE

LIM RA

LIM PP

RWE

LIM RA

LIM PP

RWE

LIM RA

LIM PP

RWE

LIM RA

LIM PP

RWE

LIM RA

LIM PP

RWE

LIM RA

LIM PP

RWE

LIM RA

LIM PP

RWE

LIM RA

LIM PP

RWE

LIM RA

LIM PP

RWE

LIM RA

LIM PP

RWE

LIM RA

LIM PP

RWE

LIM RA

LIM PP

RWE

LIM RA

LIM PP

RWE

LIM RA

LIM PP

RWE

LIM RA

LIM PP

RWE

LIM RA

LIM PP

RWE

LIM RA

LIM PP

RWE

LIM RA

LIM PP

RWE

LIM RA

LIM PP

RWE

LIM RA

LIM PP

RWE

LIM RA

LIM PP

RWE

LIM RA

LIM PP

RWE

LIM RA

LIM PP

RWE

LIM RA

LIM PP

RWE

LIM RA

LIM PP

RWE

LIM RA

LIM PP

RWE

LIM RA

LIM PP

RWE

LIM RA

LIM PP

RWE

LIM RA

LIM PP

RWE

LIM RA

LIM PP

RWE

LIM RA

LIM PP

RWE

LIM RA

LIM PP

RWE

LIM RA

LIM PP

RWE

LIM RA

LIM PP

RWE

LIM RA

LIM PP

RWE

LIM RA

LIM PP

RWE

LIM RA

LIM PP

RWE

LIM RA

LIM PP

RWE

LIM RA

LIM PP

RWE

LIM RA

LIM PP

RWE

LIM RA

LIM PP

RWE

LIM RA

LIM PP

RWE

LIM RA

LIM PP

RWE

LIM RA

LIM PP

RWE

LIM RA

Appendix 5.1.1 - Proposed Settlement Lands

ALGONQUIN LAND CLAIM DESCRIPTIVE PLAN PARCEL 107A

Sheet 6 of 13

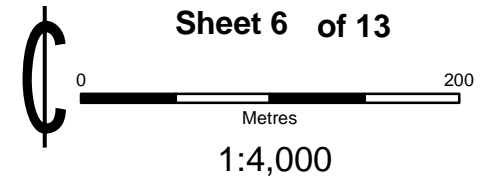

LEGEND	
Land Selection	Railway
Other Land Selection	Trail
Disposition	Resource Road
First Nation	Local / Private Road
Crown Land	Municipal Road
Acquired Crown Land	Highway
Municipal Ownership	Transmission Line
Private Ownership	Gas Pipeline
Provincial Park / Conservation Reserve	Lake
Recommended Park	Lake Trout Lake
Mining Claim	Wetland
Geographic Township	River
Lot Fabric	Contour of Elevation
	Flooding Contour

- NOTES:
- CAUTION: THIS IS NOT A PLAN OF SURVEY**
This map describes the intent of the parcel boundary. The information has been compiled from various sources and the accuracy is not guaranteed. The true location and area on the ground must be determined by survey. Do not rely on this map as a precise indicator of routes, locations of features, nor as a guide for navigation.
 - Survey Instructions from the Surveyor General of Ontario must be obtained prior to establishing any of the boundaries on the ground.
 - Projection: NAD83 (CSRS) UTM Zone 18
 - EXT - Denotes Extended
 - LIM - Denotes Limit
 - LL - Denotes Lot Line
 - LLUP - Denotes Limit of Land Use Permit
 - LPO - Denotes Limit of Private Ownership
 - LPOE - Denotes Limit of Private Ownership and Extended
 - LW - Denotes Limit of Wetland
 - NS - Denotes Not in Site
 - RA - Denotes Road Allowance
 - RWE - Denotes Regulated Water's Edge being the water's edge as affected by the operation of water level control structures, when operated, and otherwise at the water's edge as it occurs naturally.
 - WE - Denotes Water's Edge
 - PP - Denotes Provincial Park

DATA SOURCE:
Land Information Ontario Warehouse (February 1, 2011), other information of record with the Ministry of Natural Resources & Forestry and the Ministry of Northern Development and Mines, Registry Office title documents and Teranet Geowarehouse.

PRODUCED BY:
The Office of the Surveyor General
January 6, 2015
Ministry of Natural Resources & Forestry
© Queen's Printer for Ontario, 2015
RC107A_OSG_20150106.mxd

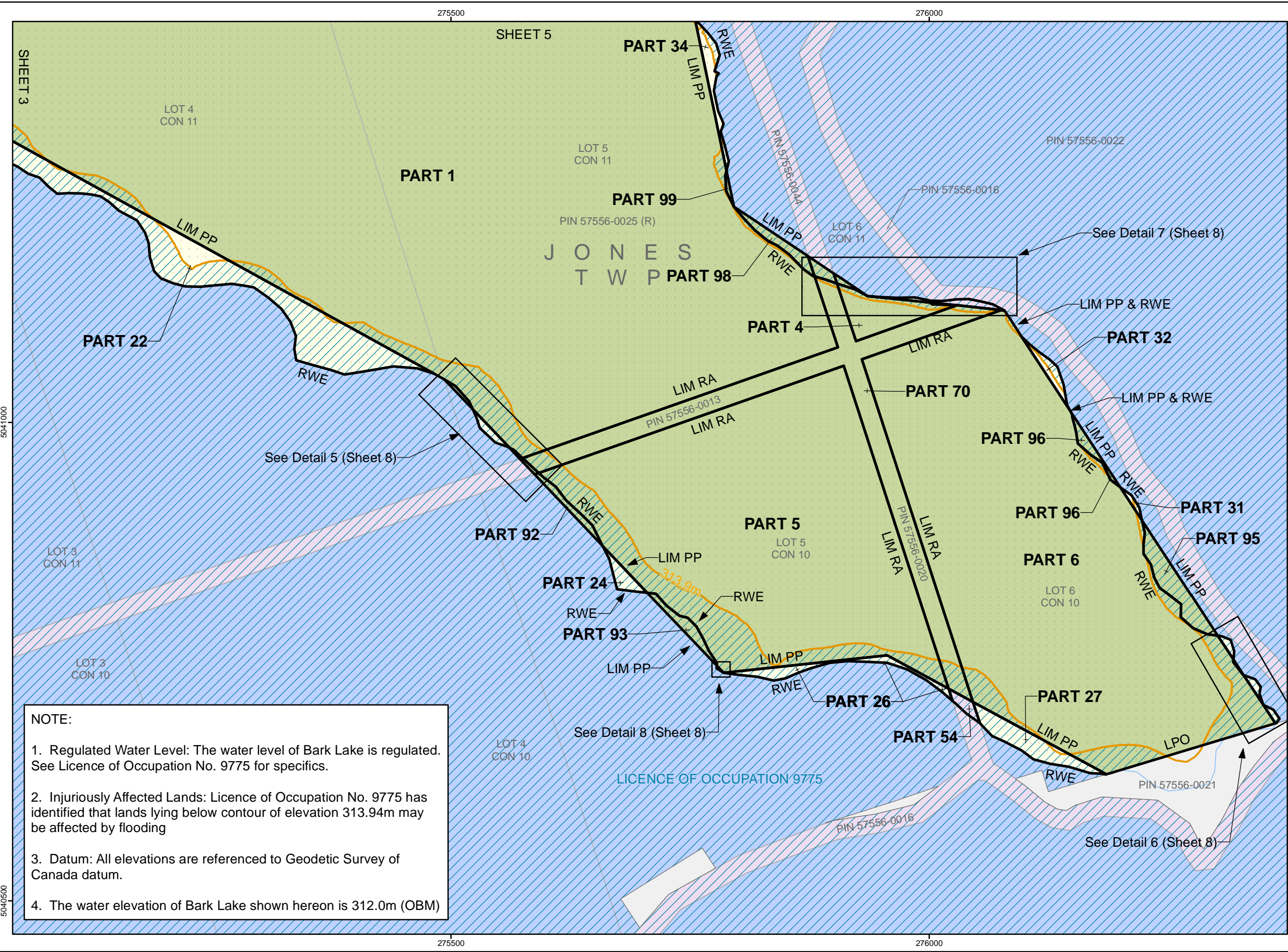

NOTE:

- Regulated Water Level: The water level of Bark Lake is regulated. See Licence of Occupation No. 9775 for specifics.
- Injurious Lands: Licence of Occupation No. 9775 has identified that lands lying below contour of elevation 313.94m may be affected by flooding
- Datum: All elevations are referenced to Geodetic Survey of Canada datum.
- The water elevation of Bark Lake shown hereon is 312.0m (OBM)

Appendix 5.1.1 - Proposed Settlement Lands

ALGONQUIN LAND CLAIM DESCRIPTIVE PLAN PARCEL 107A

Sheet 7 of 13

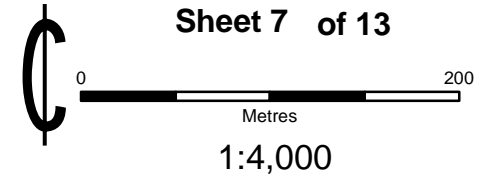

LEGEND	
Land Selection	Railway
Other Land Selection	Trail
Disposition	Resource Road
First Nation	Local / Private Road
Crown Land	Municipal Road
Acquired Crown Land	Highway
Municipal Ownership	Transmission Line
Private Ownership	Gas Pipeline
Provincial Park / Conservation Reserve	Lake
Recommended Park	Lake Trout Lake
Mining Claim	Wetland
Geographic Township	River
Lot Fabric	Contour of Elevation
	Flooding Contour

- NOTES:
- CAUTION: THIS IS NOT A PLAN OF SURVEY**
This map describes the intent of the parcel boundary. The information has been compiled from various sources and the accuracy is not guaranteed. The true location and area on the ground must be determined by survey. Do not rely on this map as a precise indicator of routes, locations of features, nor as a guide for navigation.
 - Survey Instructions from the Surveyor General of Ontario must be obtained prior to establishing any of the boundaries on the ground.
 - Projection: NAD83 (CSRS) UTM Zone 18
 - EXT - Denotes Extended
 - LIM - Denotes Limit
 - LL - Denotes Lot Line
 - LLUP - Denotes Limit of Land Use Permit
 - LPO - Denotes Limit of Private Ownership
 - LPOE - Denotes Limit of Private Ownership and Extended
 - LW - Denotes Limit of Wetland
 - NS - Denotes Not in Site
 - RA - Denotes Road Allowance
 - RWE - Denotes Regulated Water's Edge being the water's edge as affected by the operation of water level control structures, when operated, and otherwise at the water's edge as it occurs naturally.
 - WE - Denotes Water's Edge
 - PP - Denotes Provincial Park

DATA SOURCE:
Land Information Ontario Warehouse (February 1, 2011), other information of record with the Ministry of Natural Resources & Forestry and the Ministry of Northern Development and Mines, Registry Office title documents and Teranet Geowarehouse.

PRODUCED BY:
The Office of the Surveyor General January 6, 2015
Ministry of Natural Resources & Forestry
© Queen's Printer for Ontario, 2015
RC107A_OSG_20150106.mxd

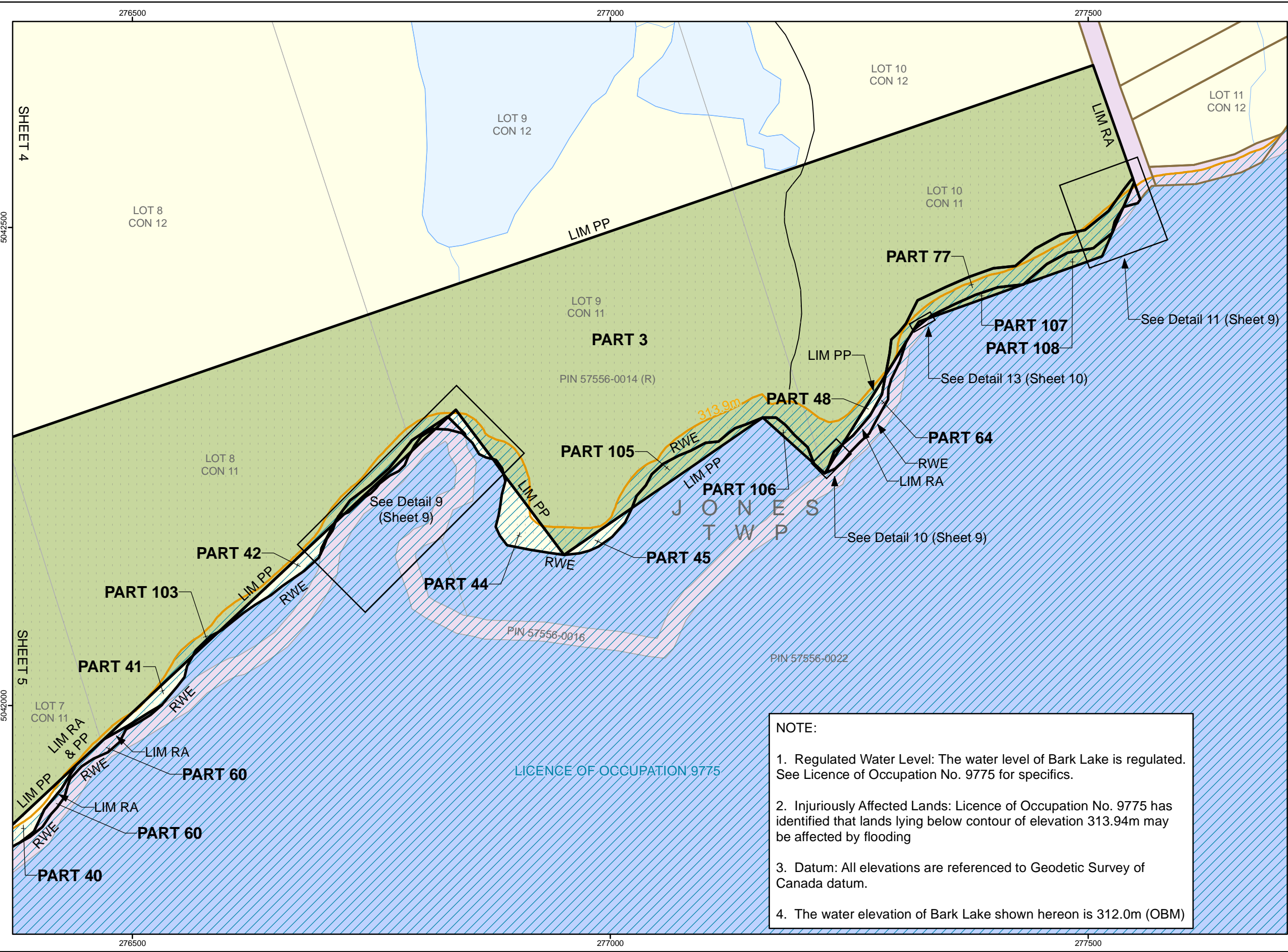

NOTE:

- Regulated Water Level: The water level of Bark Lake is regulated. See Licence of Occupation No. 9775 for specifics.
- Injurious Affected Lands: Licence of Occupation No. 9775 has identified that lands lying below contour of elevation 313.94m may be affected by flooding
- Datum: All elevations are referenced to Geodetic Survey of Canada datum.
- The water elevation of Bark Lake shown hereon is 312.0m (OBM)

Appendix 5.1.1 - Proposed Settlement Lands

ALGONQUIN LAND CLAIM DESCRIPTIVE PLAN PARCEL 107A

Sheet 9 of 13

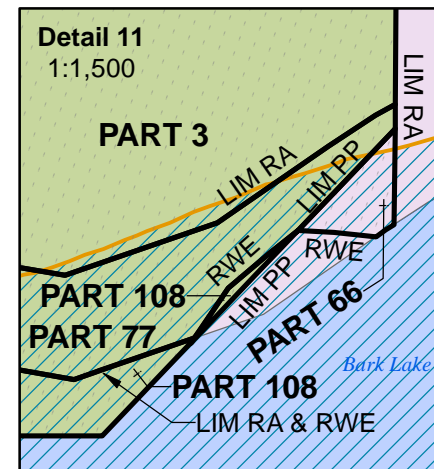
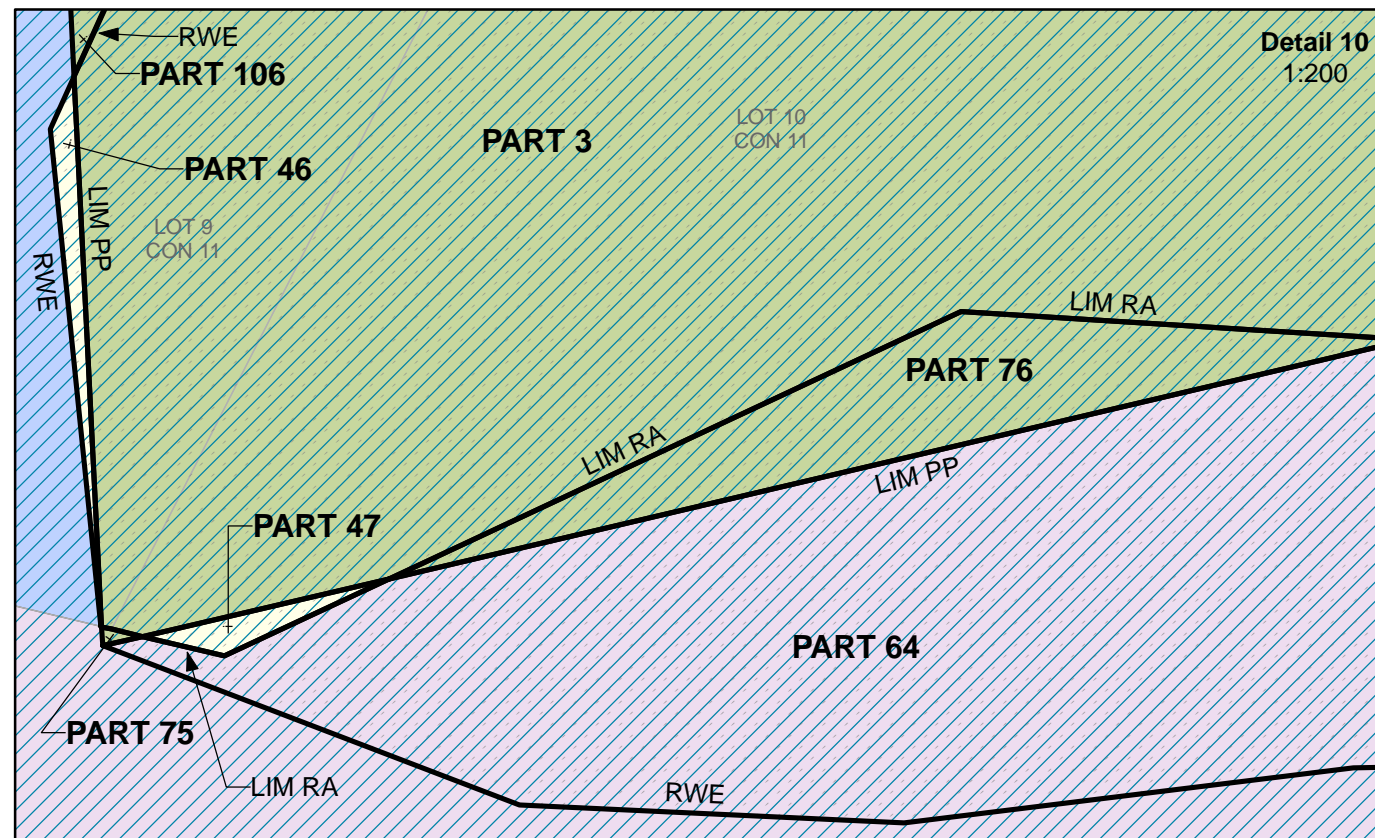
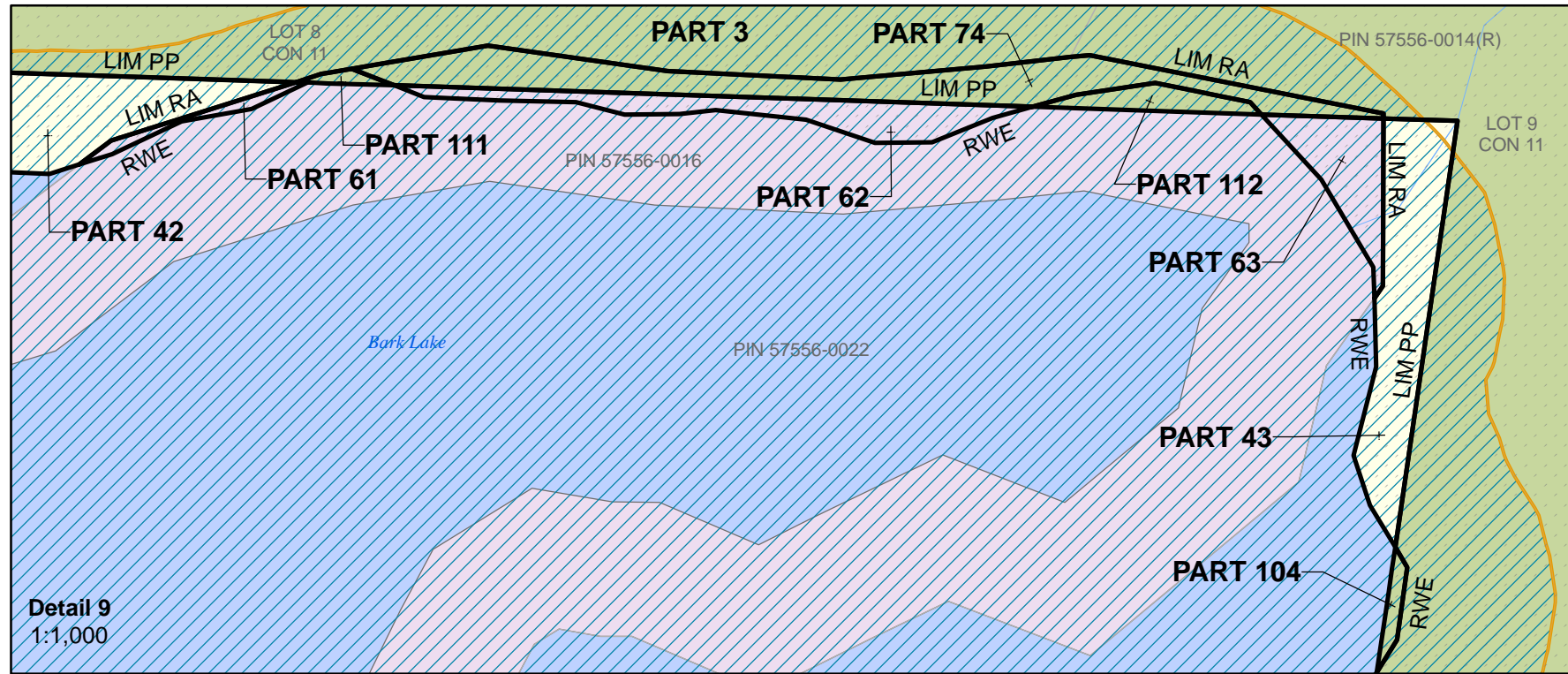

LEGEND

Land Selection	Railway
Other Land Selection	Trail
Disposition	Resource Road
First Nation	Local / Private Road
Crown Land	Municipal Road
Acquired Crown Land	Highway
Municipal Ownership	Transmission Line
Private Ownership	Gas Pipeline
Provincial Park / Conservation Reserve	Lake
Recommended Park	Lake Trout Lake
Mining Claim	Wetland
Geographic Township	River
Lot Fabric	Contour of Elevation
	Flooding Contour

NOTES:

- CAUTION: THIS IS NOT A PLAN OF SURVEY**
This map describes the intent of the parcel boundary. The information has been compiled from various sources and the accuracy is not guaranteed. The true location and area on the ground must be determined by survey. Do not rely on this map as a precise indicator of routes, locations of features, nor as a guide for navigation.
- Survey Instructions from the Surveyor General of Ontario must be obtained prior to establishing any of the boundaries on the ground.
- Projection: NAD83 (CSRS) UTM Zone 18
- EXT - Denotes Extended
- LIM - Denotes Limit
- LL - Denotes Lot Line
- LLUP - Denotes Limit of Land Use Permit
- LPO - Denotes Limit of Private Ownership
- LPOE - Denotes Limit of Private Ownership and Extended
- LW - Denotes Limit of Wetland
- NS - Denotes Not in Site
- RA - Denotes Road Allowance
- RWE - Denotes Regulated Water's Edge being the water's edge as affected by the operation of water level control structures, when operated, and otherwise at the water's edge as it occurs naturally.
- WE - Denotes Water's Edge
- PP - Denotes Provincial Park

DATA SOURCE:
Land Information Ontario Warehouse (February 1, 2011), other information of record with the Ministry of Natural Resources & Forestry and the Ministry of Northern Development and Mines, Registry Office title documents and Teranet Geowarehouse.

PRODUCED BY:
The Office of the Surveyor General
January 6, 2015
Ministry of Natural Resources & Forestry



© Queen's Printer for Ontario, 2015
RC107A_OSG_20150106.mxd

Appendix 5.1.1 - Proposed Settlement Lands

ALGONQUIN LAND CLAIM DESCRIPTIVE PLAN PARCEL 107A

Sheet 10 of 13

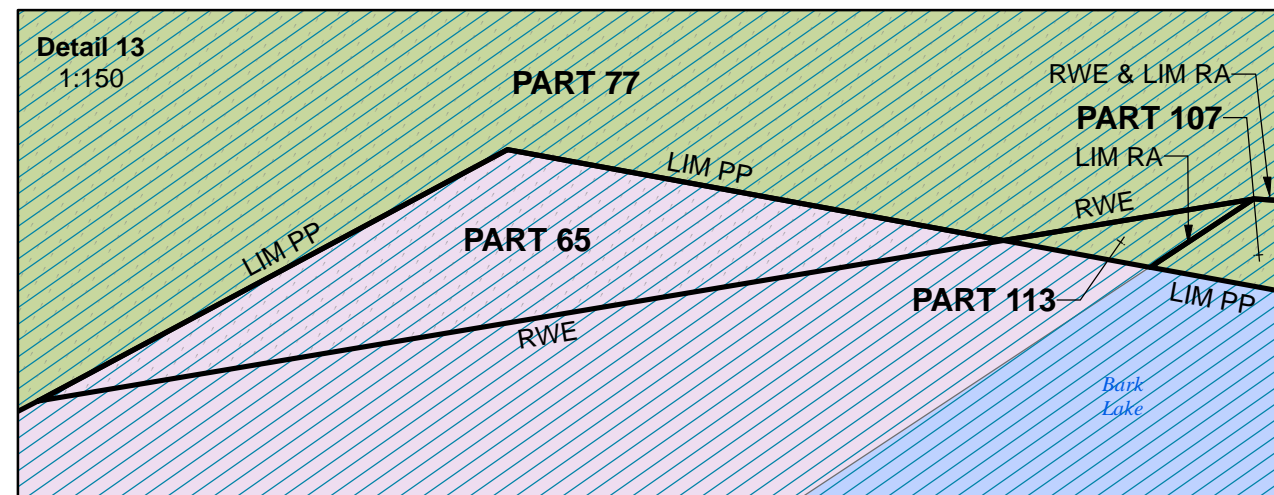
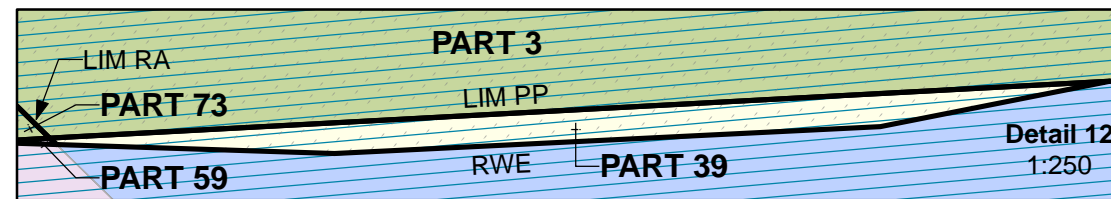

LEGEND

Land Selection	Railway
Other Land Selection	Trail
Disposition	Resource Road
First Nation	Local / Private Road
Crown Land	Municipal Road
Acquired Crown Land	Highway
Municipal Ownership	Transmission Line
Private Ownership	Gas Pipeline
Provincial Park / Conservation Reserve	Lake
Recommended Park	Lake Trout Lake
Mining Claim	Wetland
Geographic Township	River
Lot Fabric	Contour of Elevation
	Flooding Contour

NOTES:

- CAUTION: THIS IS NOT A PLAN OF SURVEY**
This map describes the intent of the parcel boundary. The information has been compiled from various sources and the accuracy is not guaranteed. The true location and area on the ground must be determined by survey. Do not rely on this map as a precise indicator of routes, locations of features, nor as a guide for navigation.
- Survey Instructions from the Surveyor General of Ontario must be obtained prior to establishing any of the boundaries on the ground.
- Projection: NAD83 (CSRS) UTM Zone 18
- EXT - Denotes Extended
- LIM - Denotes Limit
- LL - Denotes Lot Line
- LLUP - Denotes Limit of Land Use Permit
- LPO - Denotes Limit of Private Ownership
- LPOE - Denotes Limit of Private Ownership and Extended
- LW - Denotes Limit of Wetland
- NS - Denotes Not in Site
- RA - Denotes Road Allowance
- RWE - Denotes Regulated Water's Edge being the water's edge as affected by the operation of water level control structures, when operated, and otherwise at the water's edge as it occurs naturally.
- WE - Denotes Water's Edge
- PP - Denotes Provincial Park

DATA SOURCE:

Land Information Ontario Warehouse (February 1, 2011), other information of record with the Ministry of Natural Resources & Forestry and the Ministry of Northern Development and Mines, Registry Office title documents and Teranet Geowarehouse.

PRODUCED BY:

The Office of the Surveyor General

January 6, 2015



Ministry of
Natural Resources & Forestry

© Queen's Printer for Ontario, 2015

RC107A_OSG_20150106.mxd

Appendix 5.1.1 - Proposed Settlement Lands

ALGONQUIN LAND CLAIM DESCRIPTIVE PLAN

PARCEL 107A

SHEET 11 of 13

DRAFT

PART SCHEDULE						
Part #	Description	Area (ha)	Area Included (ha)	Area Not Included (ha)	Action	Comments
PART 1	Unpatented Crown Land (Bell Bay Provincial Park)	251.9	251.9		Patent subject to reservation of right to flood	License of Occupation for flooding
PART 2		0.3	0.3			
PART 3		147.2	147.2			
PART 4		0.3	0.3			
PART 5		7.9	7.9			
PART 6		10.3	10.3			
PART 7	Unpatented Crown Land	<0.1	<0.1		Patent subject to reservation of right to flood	License of Occupation for flooding
PART 8		0.4	0.4			
PART 9		<0.1	<0.1			
PART 10		0.1	0.1			
PART 11		0.3	0.3			
PART 12		0.2	0.2			
PART 13		0.1	0.1			
PART 14		<0.1	<0.1			
PART 15		0.2	0.2			
PART 16		0.3	0.3			
PART 17		0.3	0.3			
PART 18		<0.1	<0.1			
PART 19		0.7	0.7			
PART 20		0.2	0.2			
PART 21		<0.1	<0.1			
PART 22		1.3	1.3			
PART 23		<0.1	<0.1			
PART 24		0.1	0.1			
PART 25		<0.1	<0.1			
PART 26		0.1	0.1			
PART 27		0.2	0.2			
PART 28		<0.1	<0.1			
PART 29		<0.1	<0.1			
PART 30		<0.1	<0.1			
PART 31		<0.1	<0.1			
PART 32		0.1	0.1			
PART 33		<0.1	<0.1			
PART 34		0.1	0.1			
PART 35		0.1	0.1			
PART 36		0.4	0.4			
PART 37		0.2	0.2			
PART 38		<0.1	<0.1			
PART 39	<0.1	<0.1				

NOTE: Total Area as shown is the sum of areas of all parts, including those < 0.1 ha.

PRODUCED BY:
The Office of the Surveyor General January 6, 2015



Ministry of
Natural Resources & Forestry
© Queen's Printer for Ontario, 2015

Appendix 5.1.1 - Proposed Settlement Lands

ALGONQUIN LAND CLAIM DESCRIPTIVE PLAN

PARCEL 107A

SHEET 12 of 13

PART SCHEDULE						
Part #	Description	Area (ha)	Area Included (ha)	Area Not Included (ha)	Action	Comments
PART 40	Unpatented Crown Land	0.2	0.2		Patent subject to reservation of right to flood	License of Occupation for flooding
PART 41		0.1	0.1			
PART 42		0.1	0.1			
PART 43		<0.1	<0.1			
PART 44		0.3	0.3			
PART 45		0.1	0.1			
PART 46		<0.1	<0.1			
PART 47		<0.1	<0.1			
PART 48		<0.1	<0.1			
PART 49		<0.1	<0.1			
PART 50		<0.1	<0.1			
PART 51		0.1	0.1			
PART 52		<0.1	<0.1			
PART 53		0.1	0.1			
PART 54		Road Allowance	<0.1	<0.1		
PART 55	<0.1		<0.1			
PART 56	0.3		0.3			
PART 57	<0.1		<0.1			
PART 58	<0.1		<0.1			
PART 59	<0.1		<0.1			
PART 60	0.1		0.1			
PART 61	<0.1		<0.1			
PART 62	<0.1		<0.1			
PART 63	<0.1		<0.1			
PART 64	0.1		0.1			
PART 65	<0.1		<0.1			
PART 66	<0.1		<0.1			
PART 67	<0.1	<0.1				
PART 68	Road Allowance	0.2		0.2	Excluded	
PART 69		<0.1		<0.1		
PART 70	Road Allowance (Bell Bay Provincial Park)	1.9	1.9		AOO have requested RA, reservation of right to flood	Ontario to transfer RA in its administration and control. Licence of Occupation for flooding
PART 71		<0.1	<0.1			
PART 72		<0.1	<0.1			
PART 73		<0.1	<0.1			

NOTE: Total Area as shown is the sum of areas of all parts, including those < 0.1 ha.

PRODUCED BY:
The Office of the Surveyor General January 6, 2015



Ministry of
Natural Resources & Forestry
© Queen's Printer for Ontario, 2015

Appendix 5.1.1 - Proposed Settlement Lands

ALGONQUIN LAND CLAIM DESCRIPTIVE PLAN

PARCEL 107A

SHEET 13 of 13

PART SCHEDULE						
Part #	Description	Area (ha)	Area Included (ha)	Area Not Included (ha)	Action	Comments
PART 74	Road Allowance (Bell Bay Provincial Park)	0.1	0.1		AOO have requested RA, reservation of right to flood	Ontario to transfer RA in its administration and control. Licence of Occupation for flooding
PART 75		<0.1	<0.1			
PART 76		<0.1	<0.1			
PART 77		0.6	0.6			
PART 78		0.7	0.7			
PART 79	Road Allowance	0.5		0.5	Excluded	
PART 80	(Bell Bay Provincial Park)	3.1		3.1		
PART 81	Lake (Bell Bay Provincial Park)	1.1		1.1	Excluded	
PART 82		<0.1		<0.1		
PART 83		<0.1		<0.1		
PART 84		0.3		0.3		
PART 85		0.3		0.3		
PART 86		0.1		0.1		
PART 87		<0.1		<0.1		
PART 88		<0.1		<0.1		
PART 89		<0.1		<0.1		
PART 90		<0.1		<0.1		
PART 91		<0.1		<0.1		
PART 92		0.1		0.1		
PART 93		0.1		0.1		
PART 94		<0.1		<0.1		
PART 95		0.2		0.2		
PART 96		<0.1		<0.1		
PART 97		<0.1		<0.1		
PART 98		0.1		0.1		
PART 99		<0.1		<0.1		
PART 100		<0.1		<0.1		
PART 101		<0.1		<0.1		
PART 102		<0.1		<0.1		
PART 103		<0.1		<0.1		
PART 104	<0.1		<0.1			
PART 105	0.2		0.2			
PART 106	0.1		0.1			
PART 107	<0.1		<0.1			
PART 108	0.1		0.1			
PART 109	Road Allowance and Lake (Bell Bay Provincial Park)	<0.1		<0.1	Excluded	
PART 110		<0.1		<0.1		
PART 111		<0.1		<0.1		
PART 112		<0.1		<0.1		
PART 113		<0.1		<0.1		
Total Area (ha)		435.0	428.3	6.7		
Total Area (ac)		1074.9	1058.3	16.5		

NOTE: Total Area as shown is the sum of areas of all parts, including those < 0.1 ha.

PRODUCED BY:
The Office of the Surveyor General January 6, 2015



Ministry of
Natural Resources & Forestry
© Queen's Printer for Ontario, 2015

Appendix 5.1.1 - Proposed Settlement Lands

Stakeholder Activities in Parcel 107A

Activity	Description	Status	Size of Area (ac)	Percent of Area Affected (%)
Bait Harvest Area	PE0179	Active	1067.6	4.0
Bear Management Area	AP-55A-010	Active	423.4	2.0
Bear Management Area	AP-55A-011	Active	644.3	4.4
Certificate of Approval	None known			
Conservation Authority	None			
Extractable Aggregate	None			
Forest Management Unit	780 - Ottawa Valley Forest			
Land Use Permit	None			
Lease	None			
Licence of Occupation	None			
Mining Claim	None			
Mining Lease	None			
Research Plot	None			
Resident Trapper	None			
Seed Area	None			
Trail	None			
Trapline Area	AP047	Inactive	1067.6	21.4
Wind Power Application	None			

The information included in this table is based on the best information as of August 1, 2013. Information may be subject to change.